

# ASSEMBLY INSTRUCTIONS

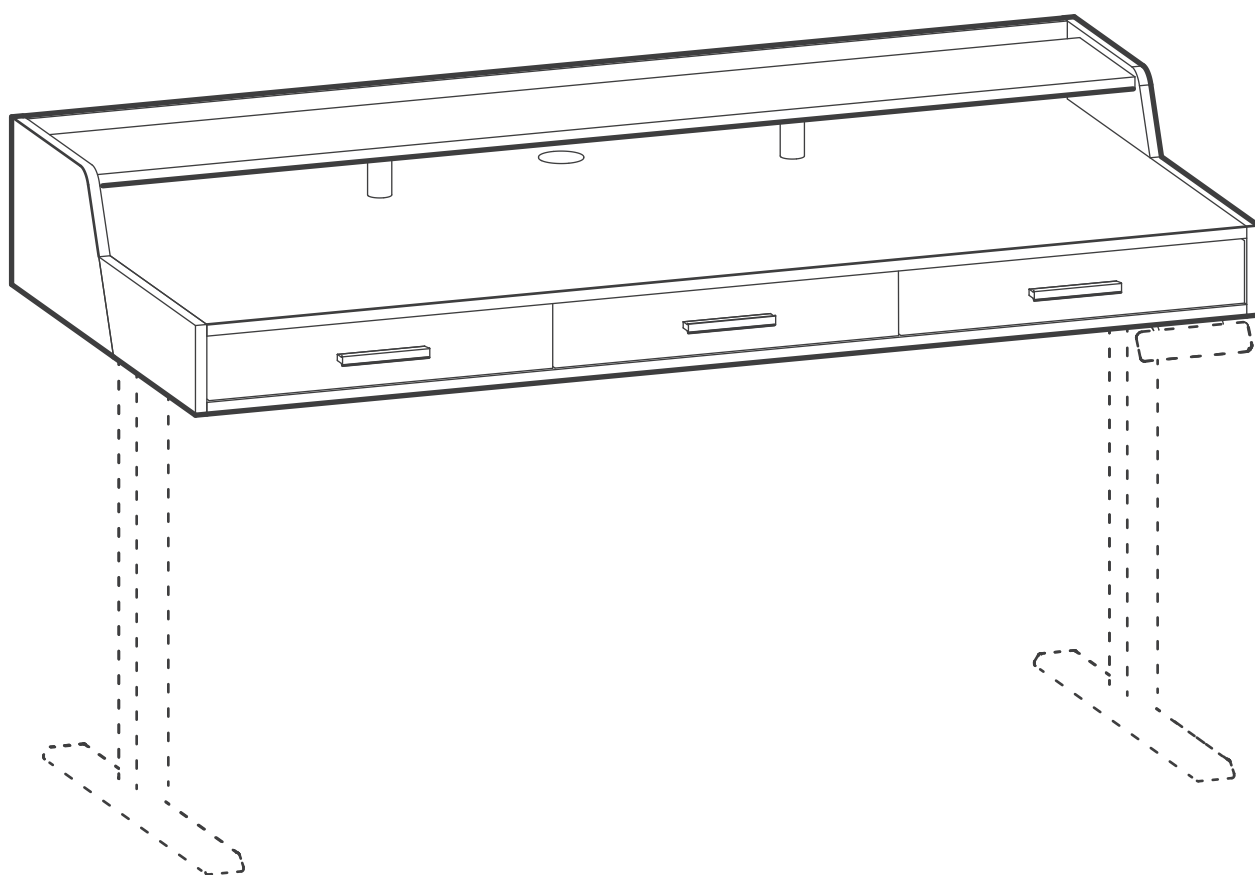

▶ Scan QR code for  
installation video



✉ support@yfs.life

🌐 [yfs.life/pd-SDE0077-zpa](https://yfs.life/pd-SDE0077-zpa)



## Caution

- Before you begin: Lay out all parts on a clean surface to check if the tags and numbers are correct.
- Please use the screws correctly, otherwise you might damage the desk panel.
- Don't screw tightly before all the screws are put into the corresponding holes.
- Please make sure the product has been installed correctly and read the instructions before using the product.
- Do not use corrosive or abrasive materials to clean this product.
- The company does not bear any warranty or liability for damage and human injury caused by any abnormal or un-intended operation of the equipment.

## Pre-Installation Preparation

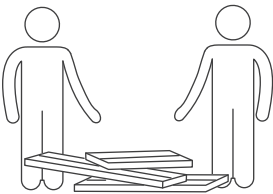
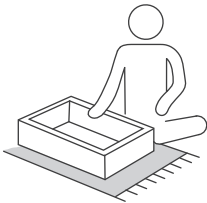
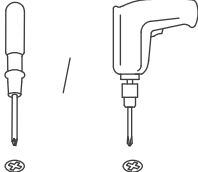
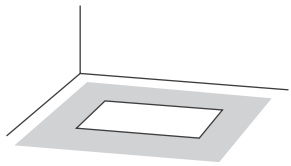
 <p>Complete through collaboration.</p>	 <p>Assemble on a clean, flat, and protective surface.</p>	 <p>Phillips screwdriver or drill required (not provided).</p>	 <p>Allow an assembly area at least twice the desktop size.</p>
--	---	--	--

## PARTS LIST

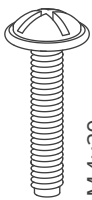

**A** x6

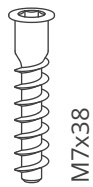

**B** x32



**C** x18

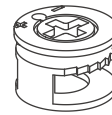

**D** x18

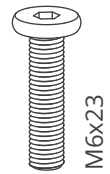

**E** x2



**F** x4



**G** x12

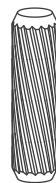

**H** x21

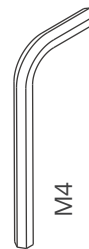

**I** x1

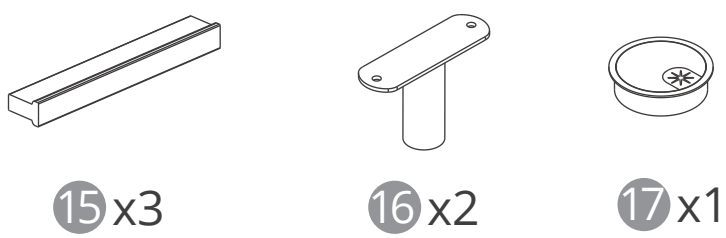
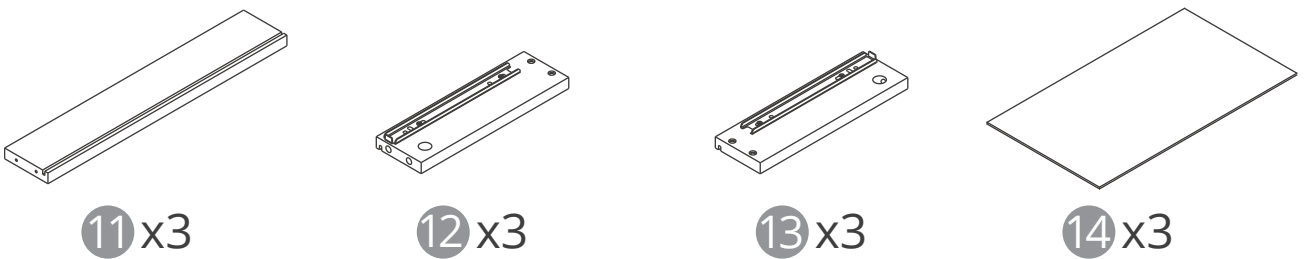
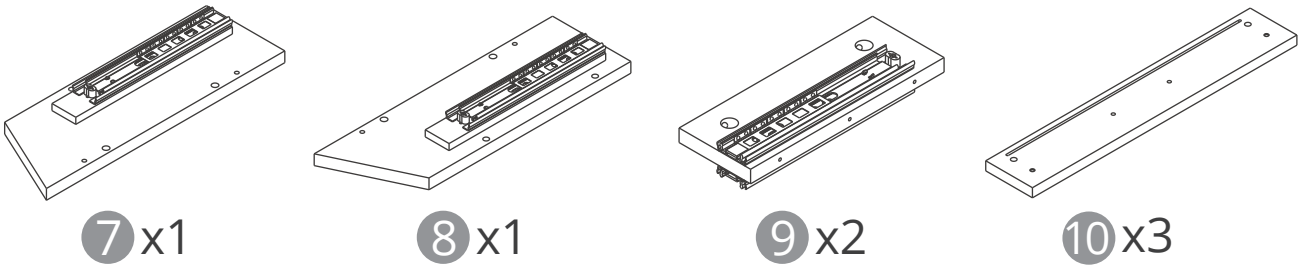
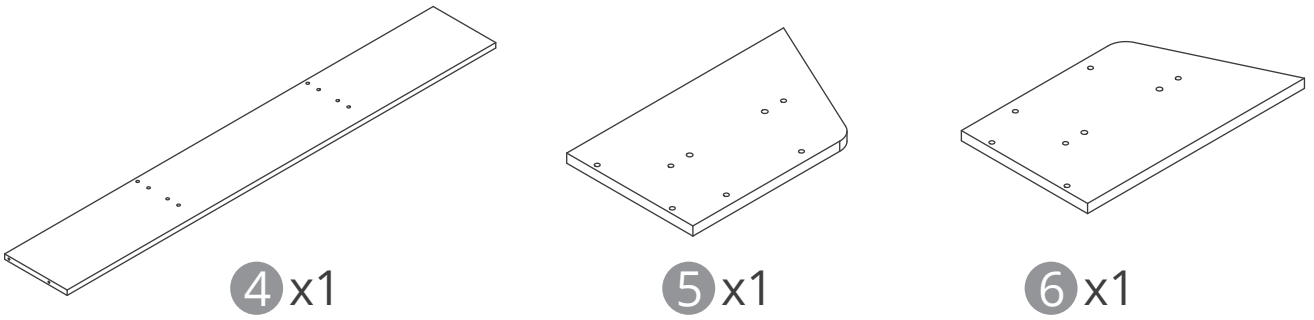
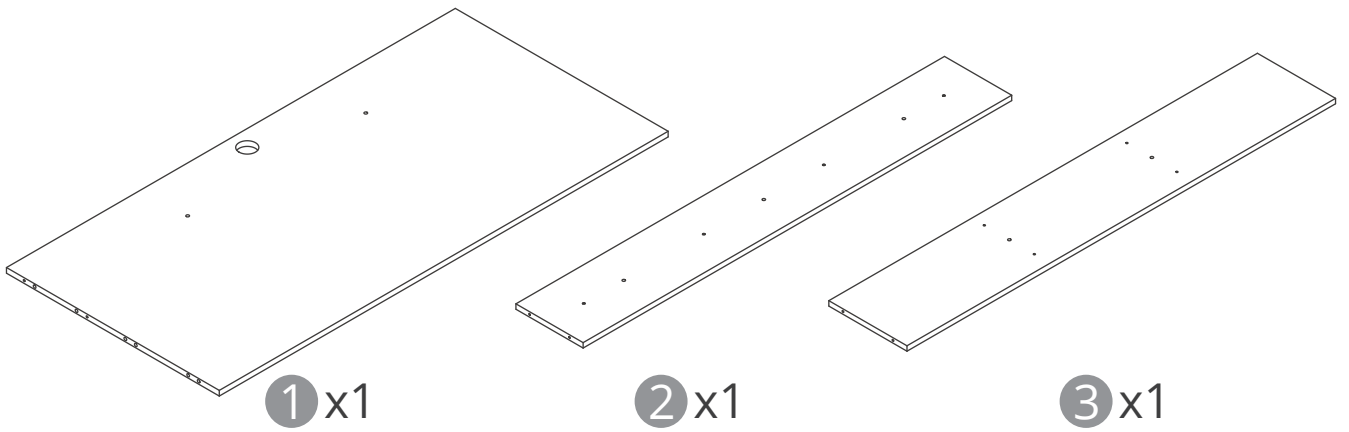

# EXPLODED VIEW DIAGRAM

Page 4-19

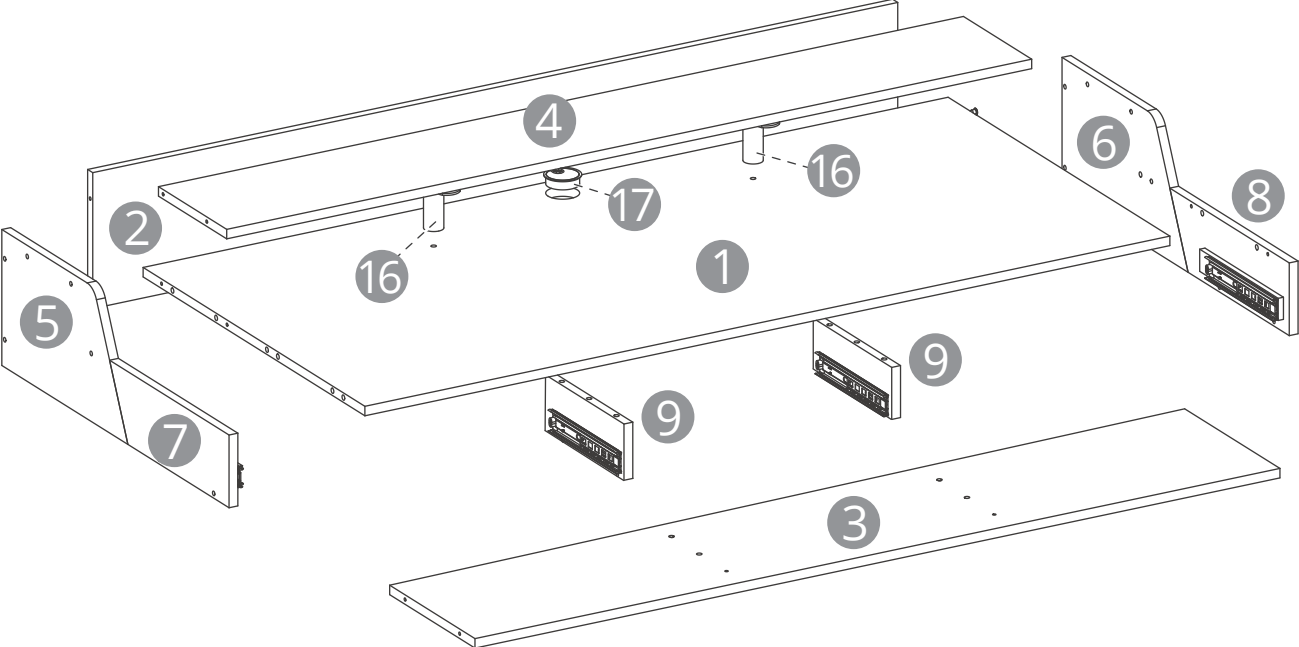

Page 20-21

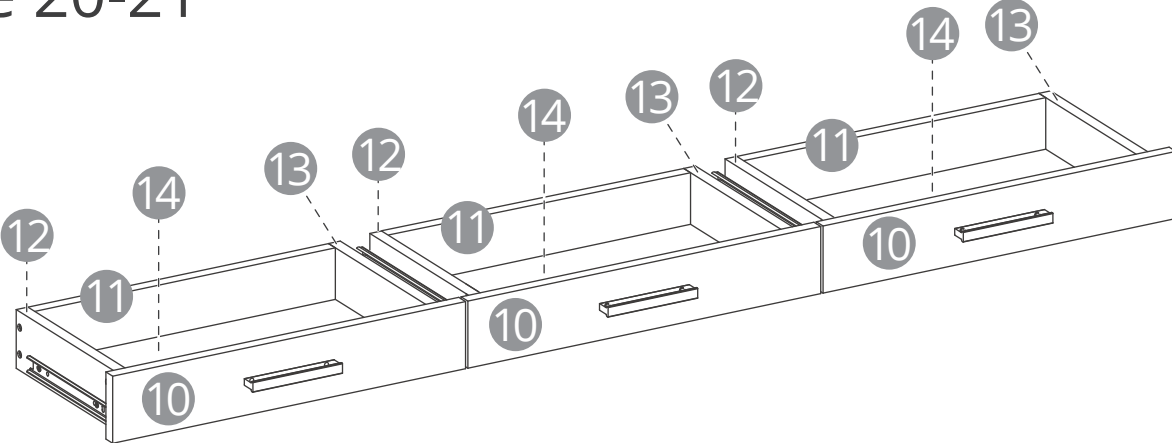

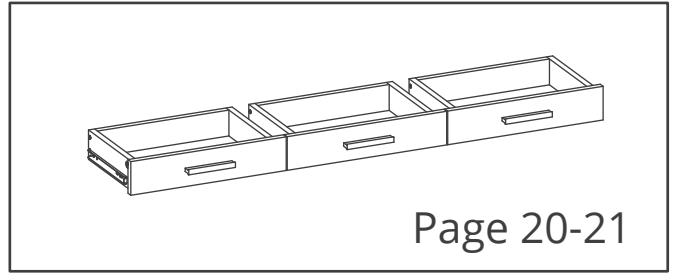
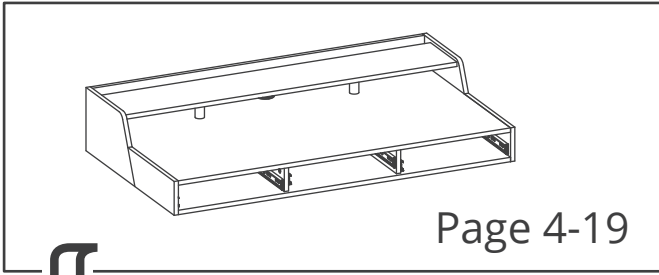

**1** The recommended screw torque for locking the tabletop is 6-8 N·m; please keep the screws perpendicular to the mounting surface during installation.

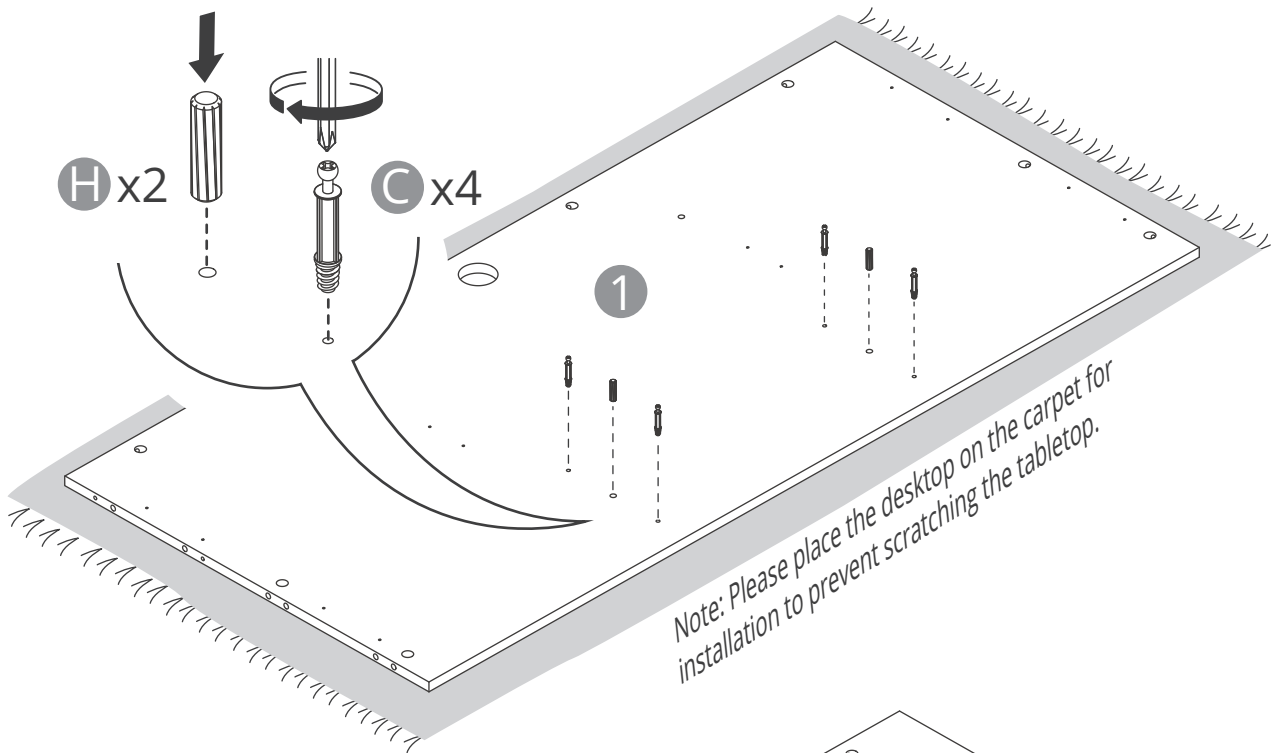

**2**

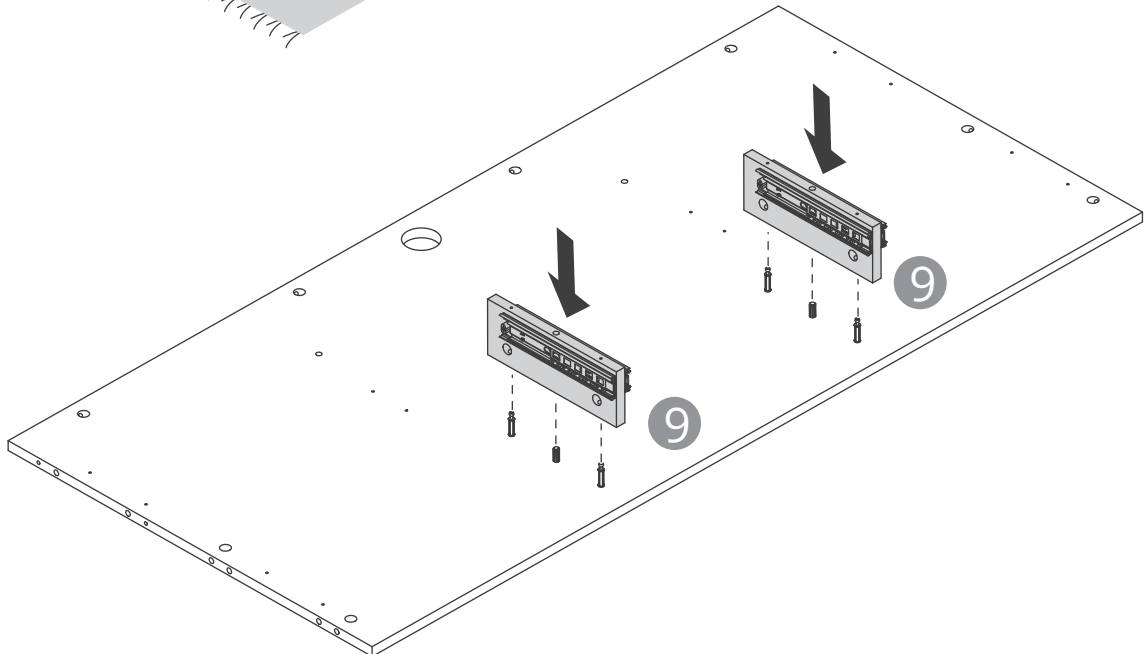

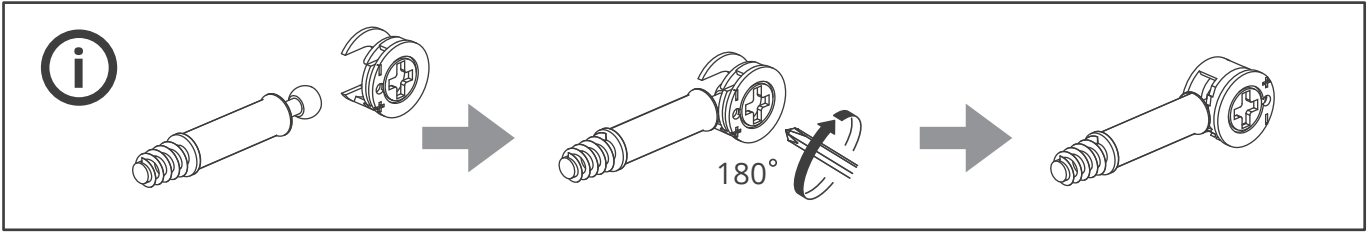

**3** The recommended screw torque for locking the tabletop is 6-8 N·m; please keep the screws perpendicular to the mounting surface during installation.

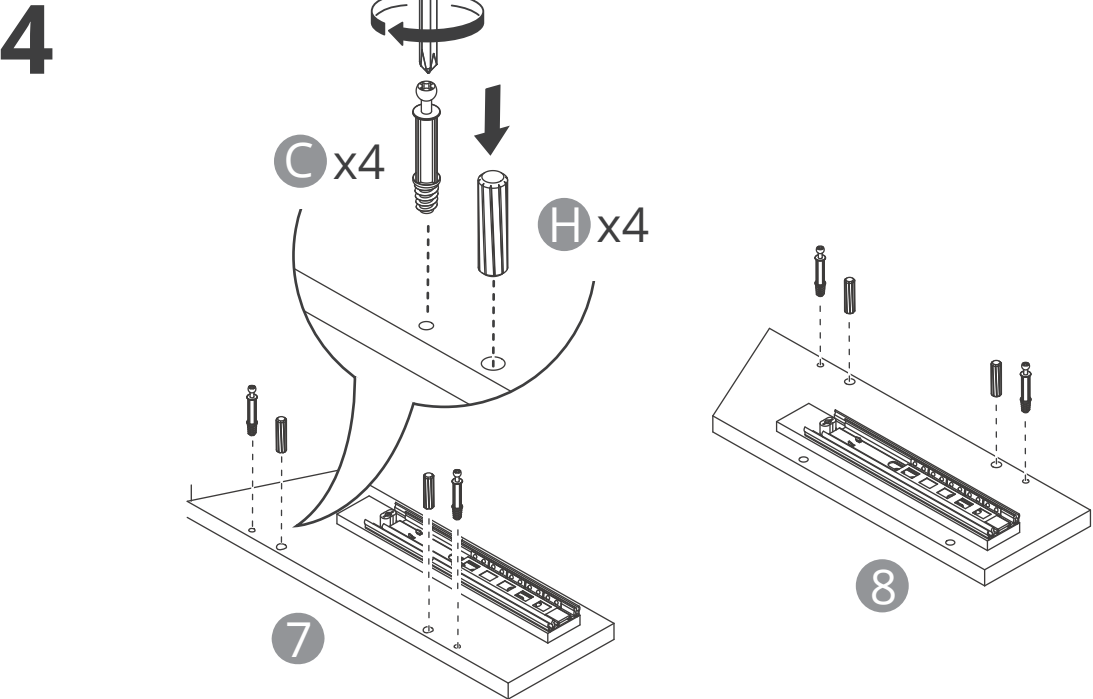
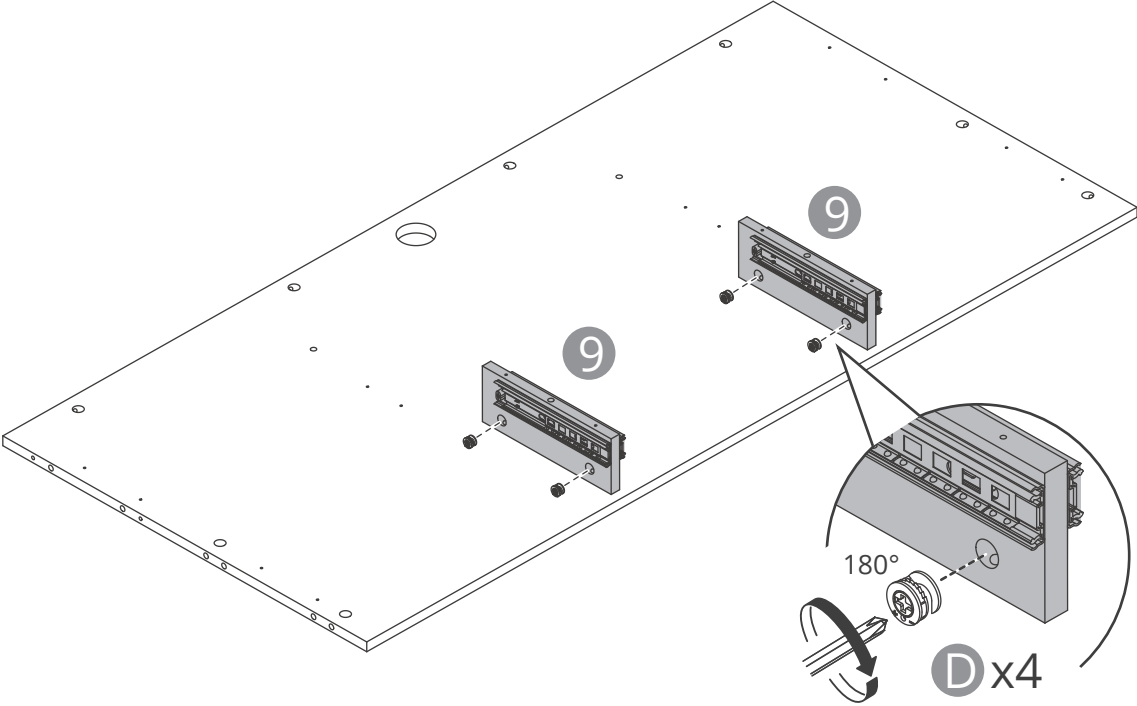

# 5

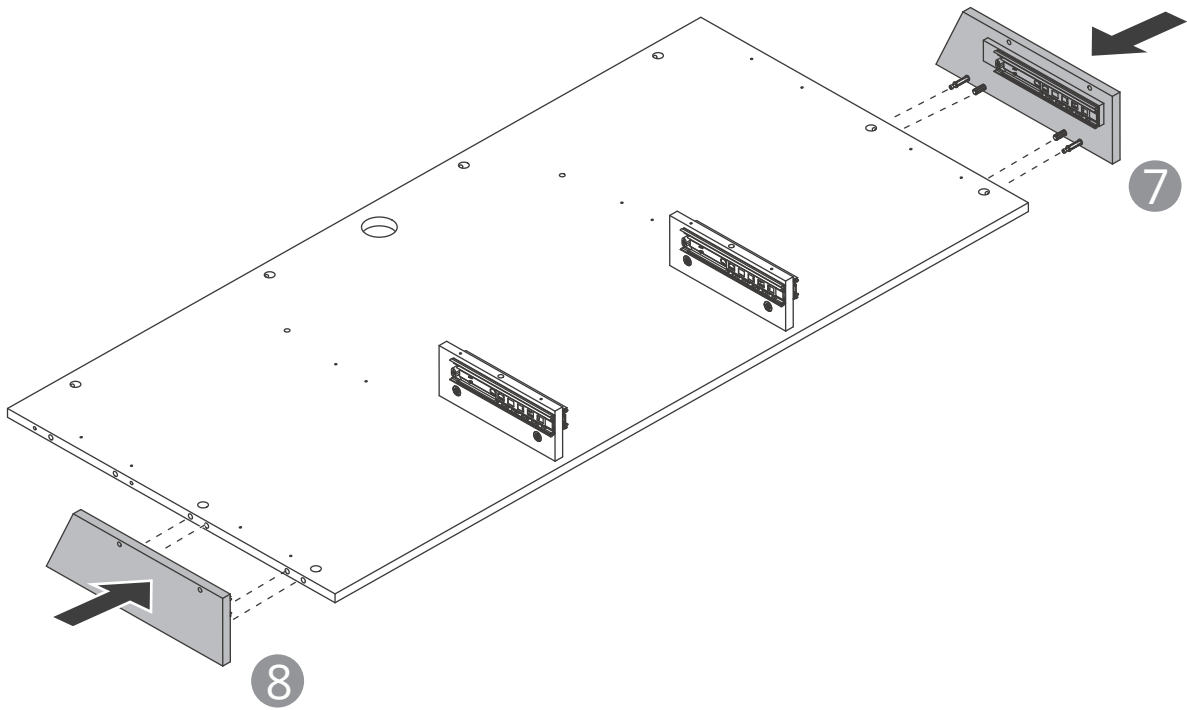

# 6

The recommended screw torque for locking the tabletop is 6-8 N·m; please keep the screws perpendicular to the mounting surface during installation.

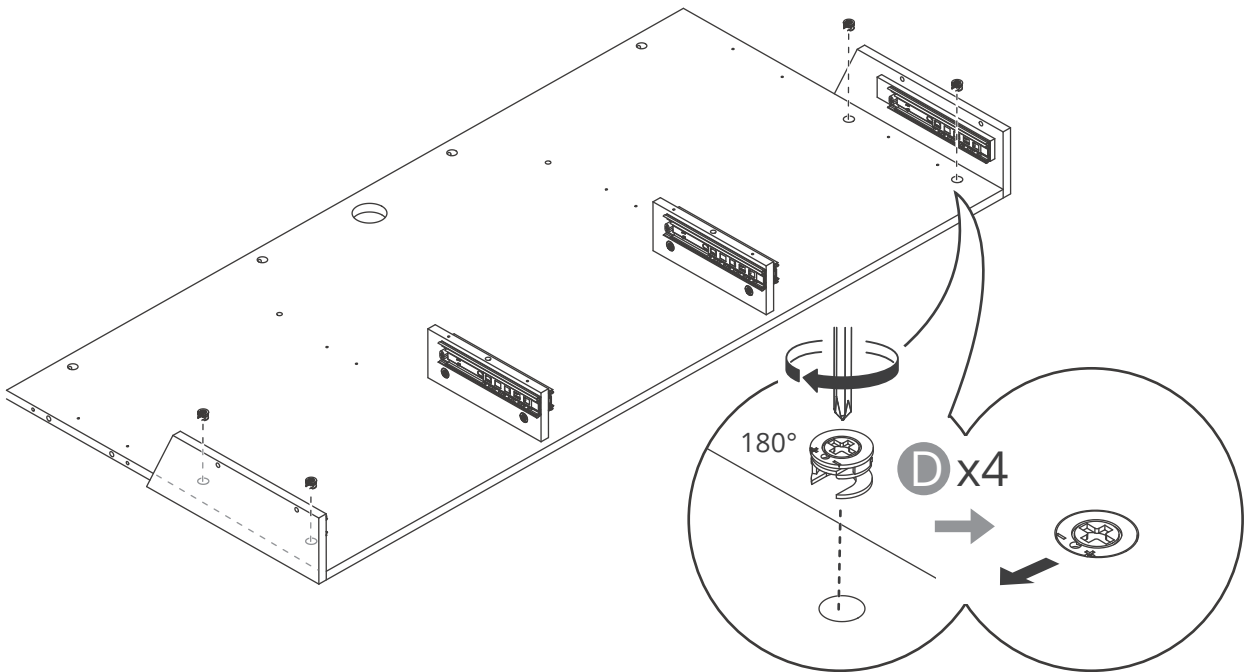



Please note: the deskframe below is for assembly reference only.  
The actual deskframe is subject to your own selection.

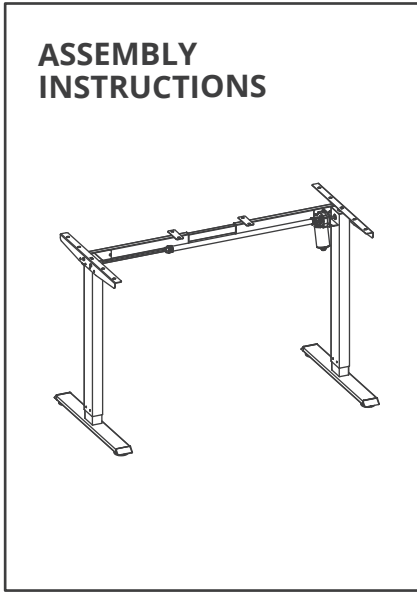

7

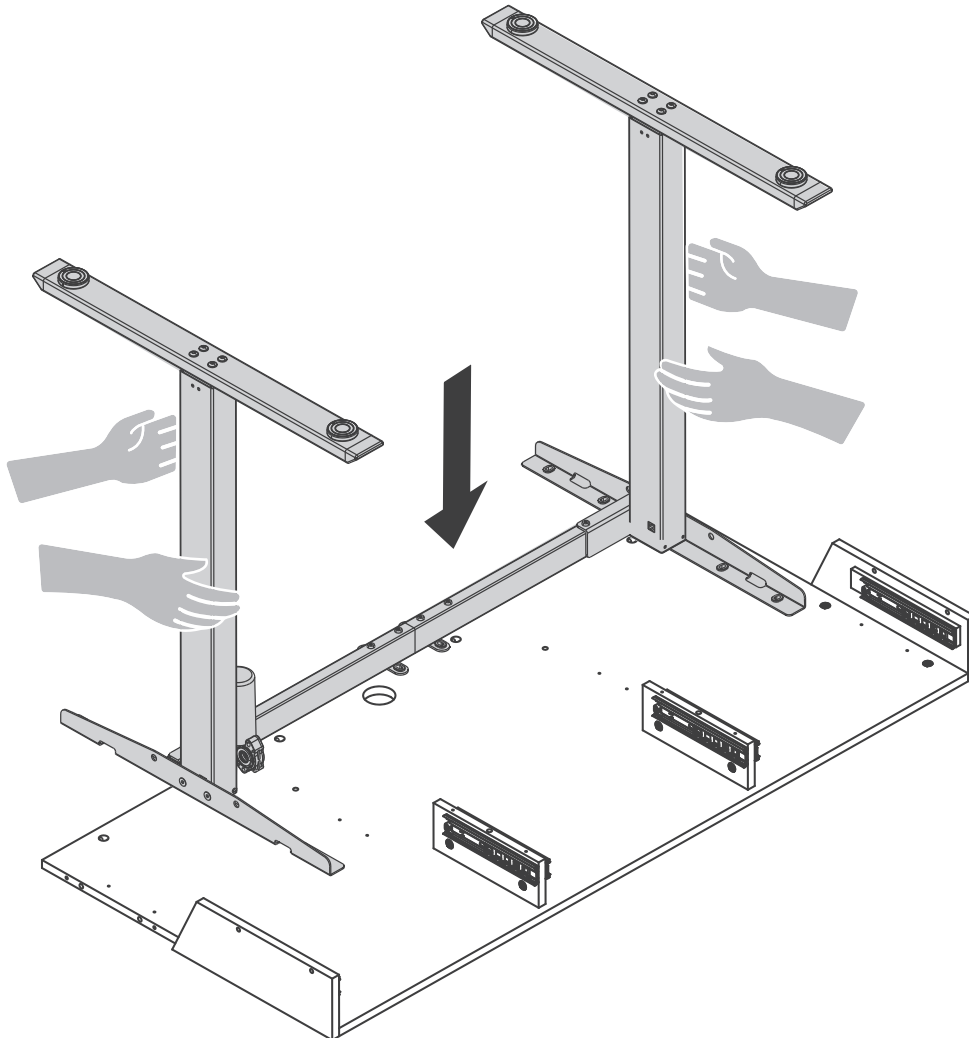

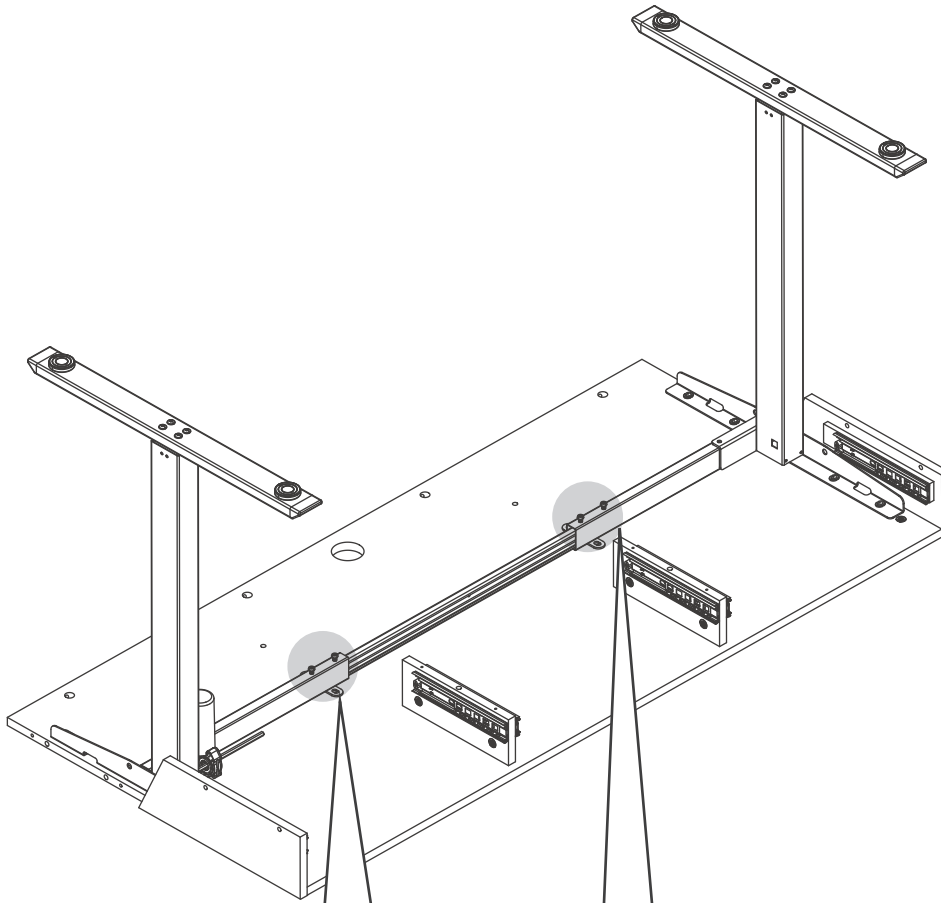

**1** Loosen the 4 screws.

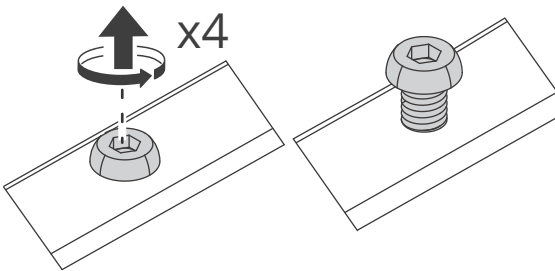

**2**

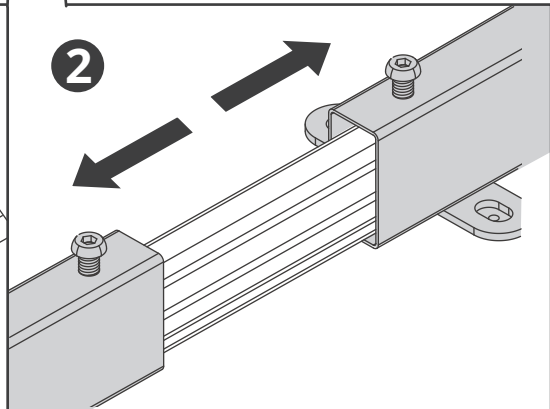

**3** Adjust the crossbar to the center position as shown.

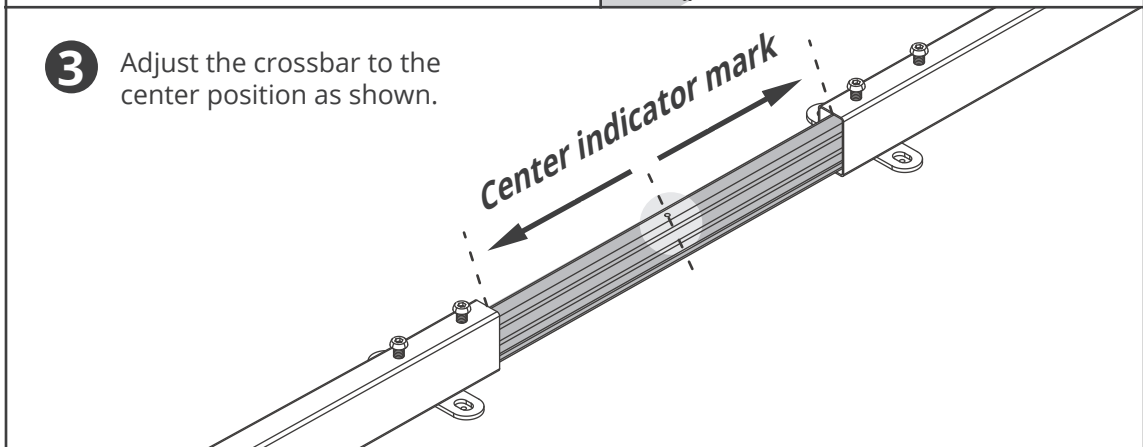

# 9

The recommended screw torque for locking the tabletop is 6-8 N·m; please keep the screws perpendicular to the mounting surface during installation.

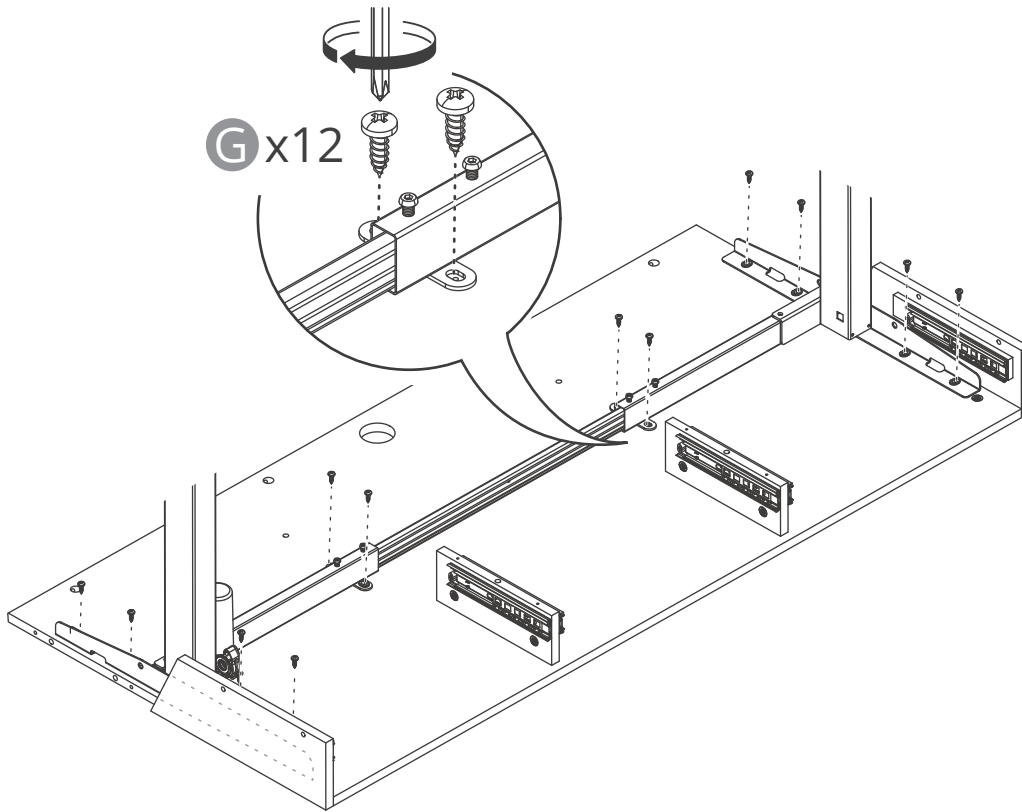

# 10

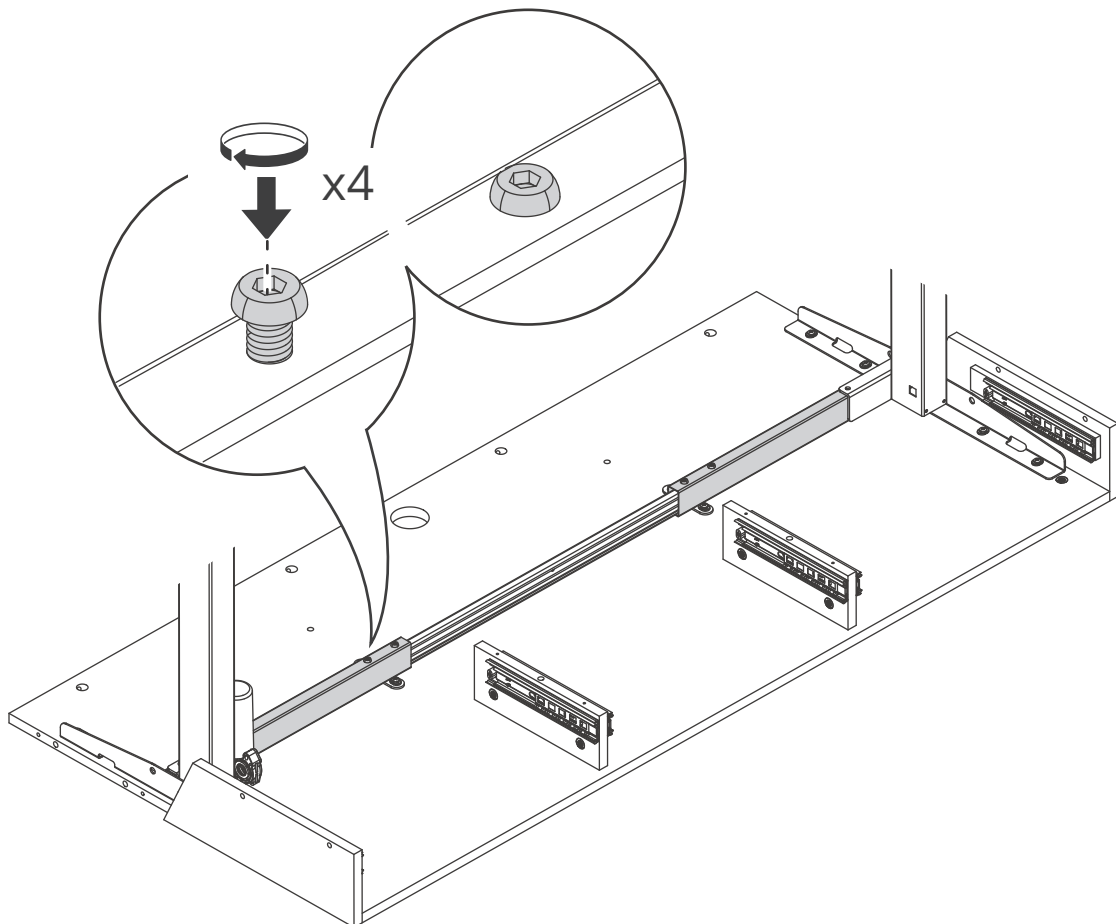

# 11

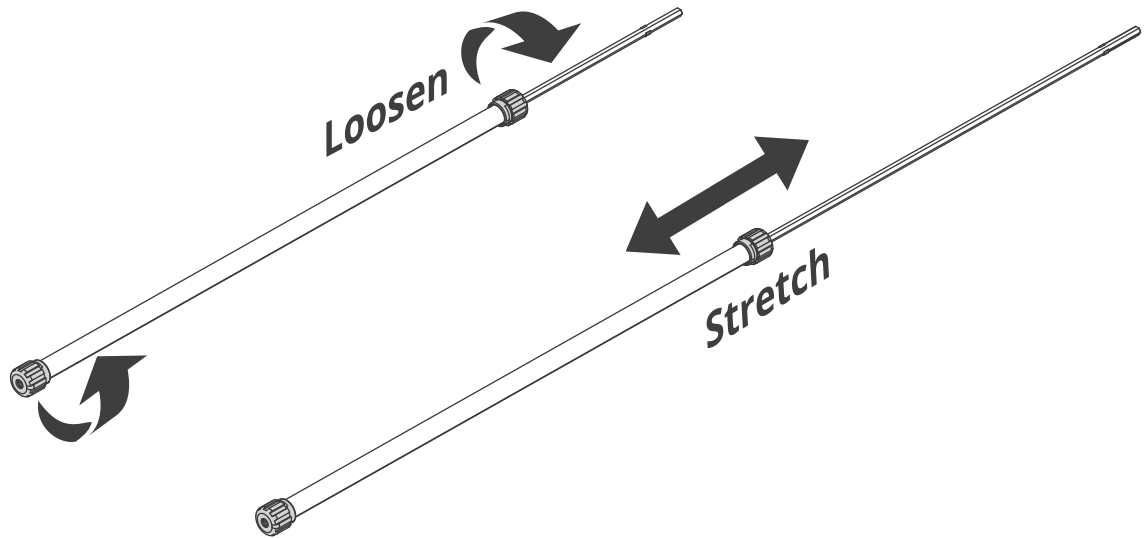

# 12

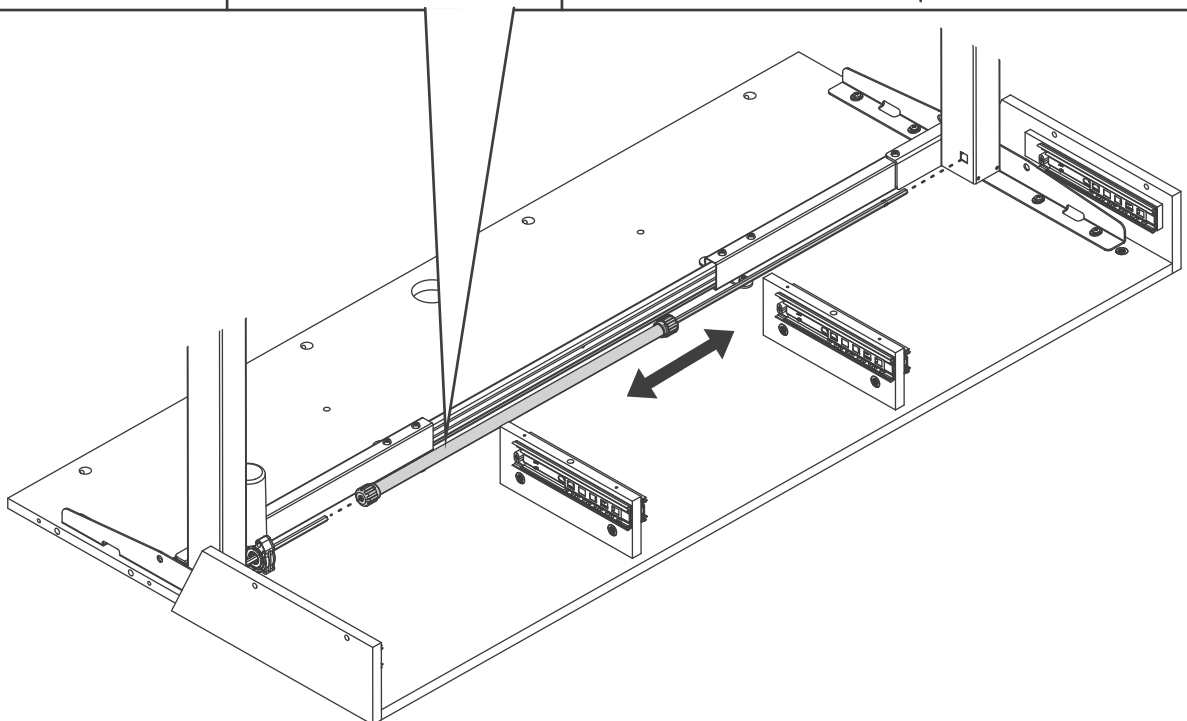
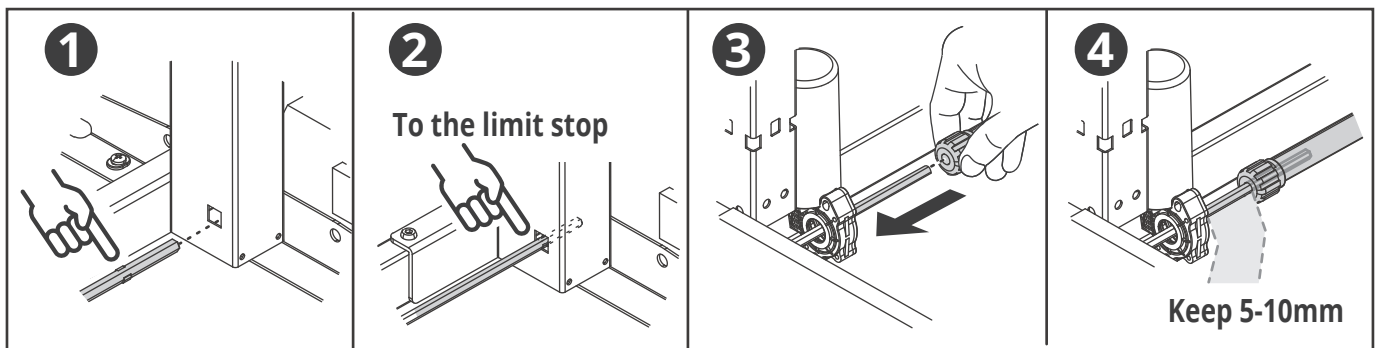

13

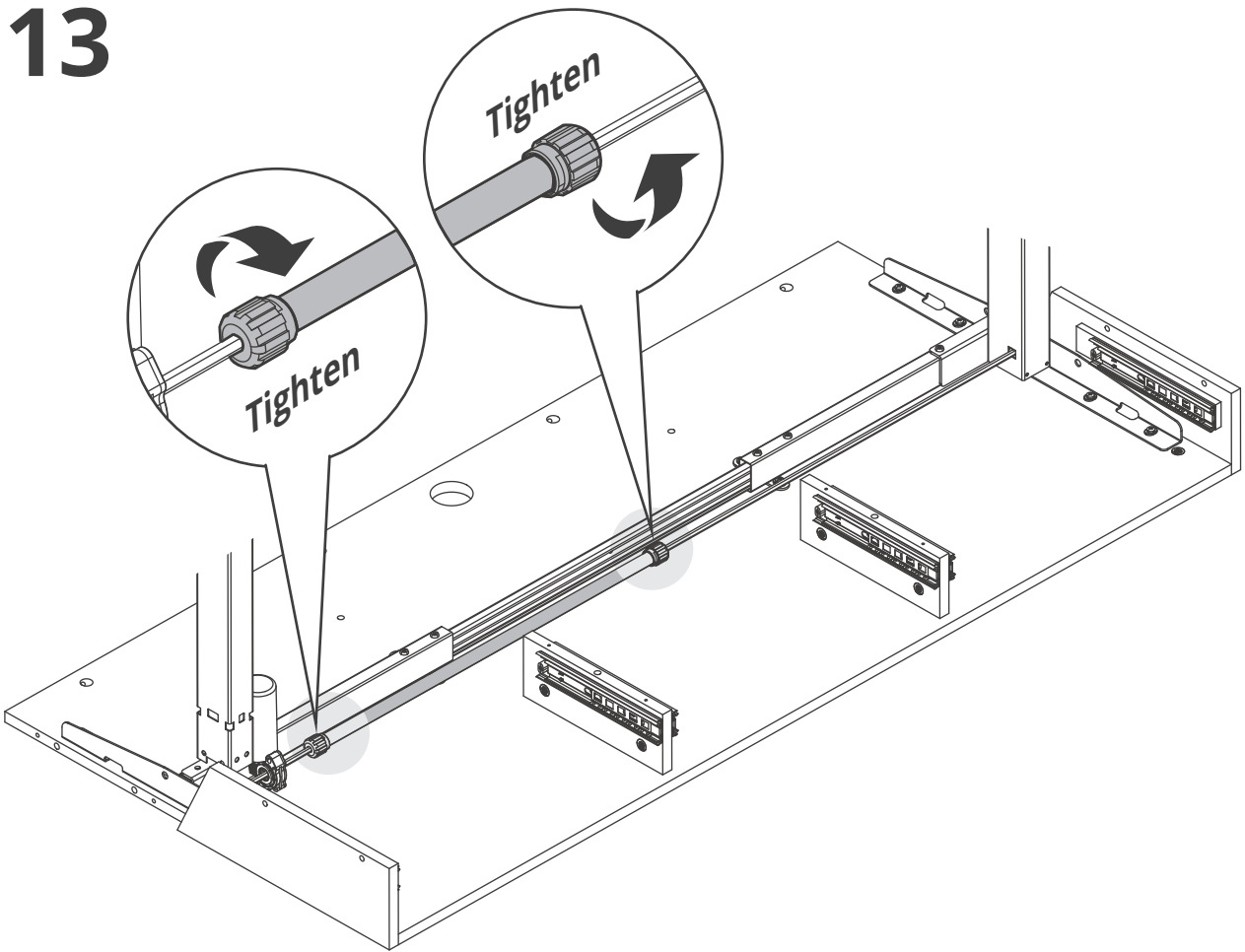

14

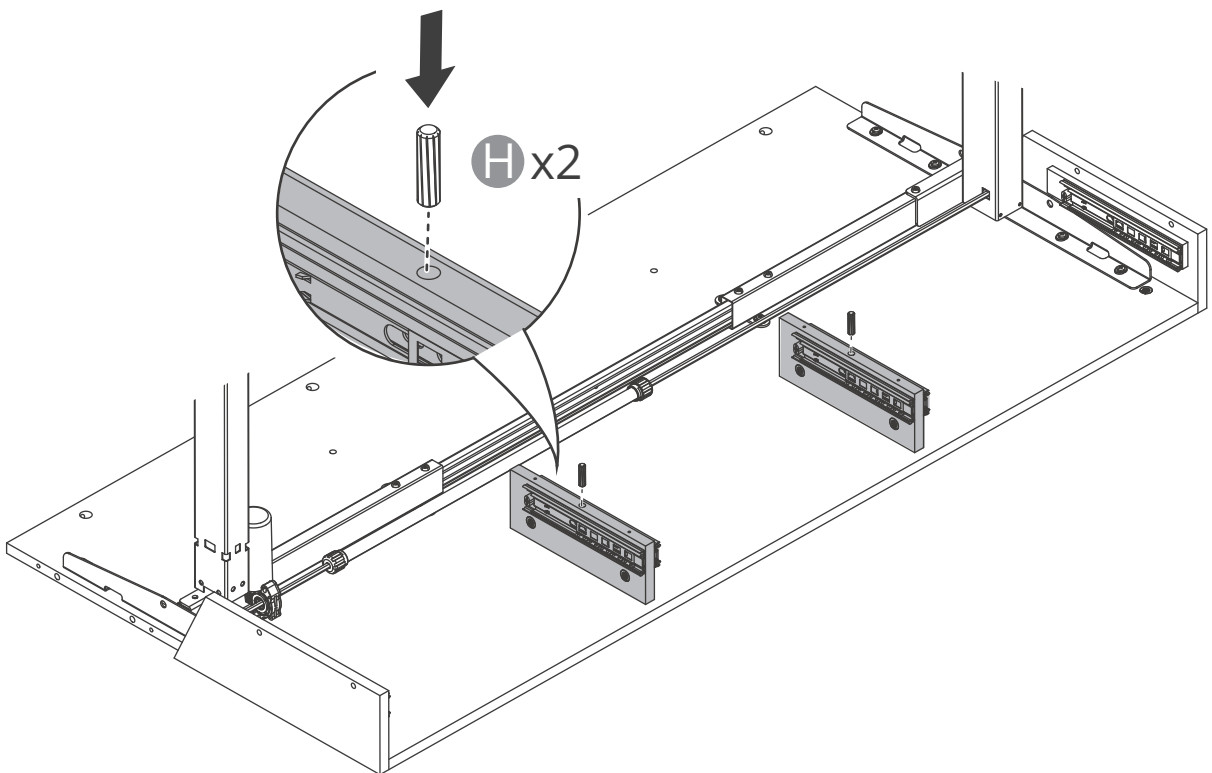

- 15** The recommended screw torque for locking the tabletop is 6-8 N·m; please keep the screws perpendicular to the mounting surface during installation.

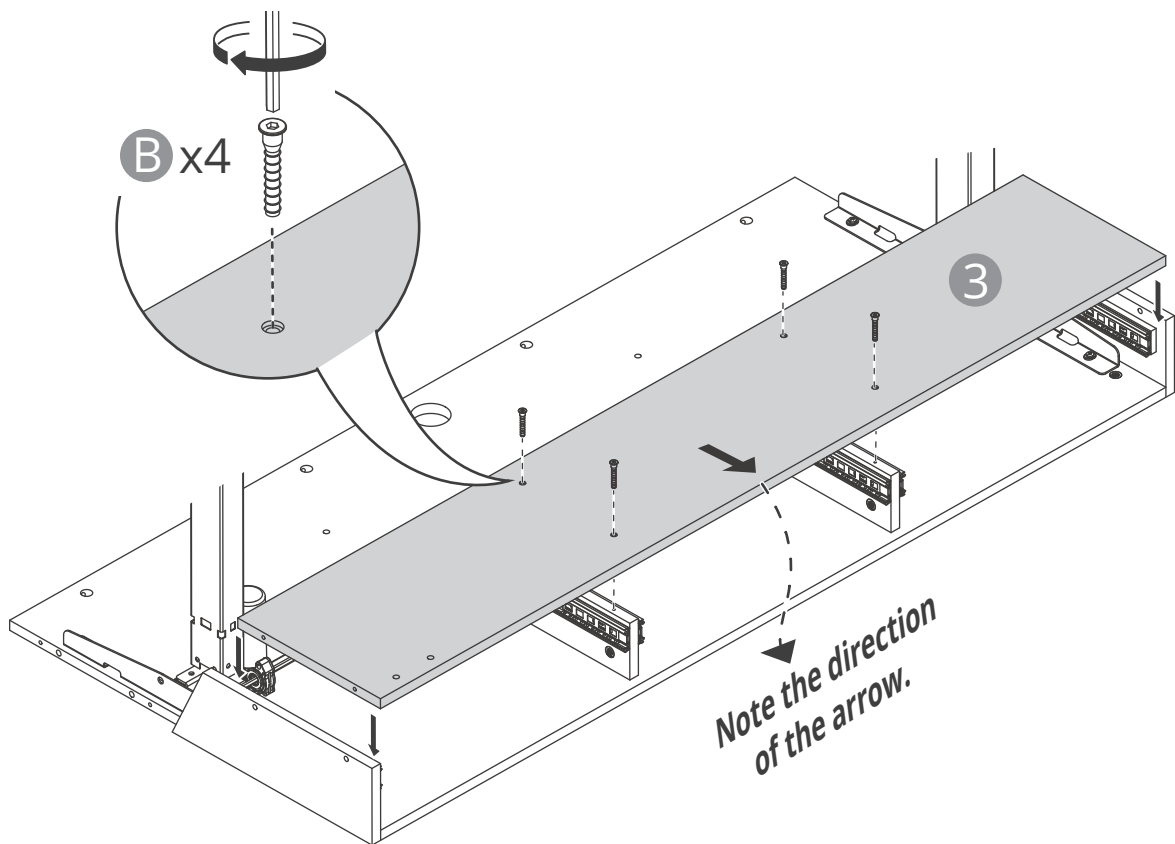

- 16** The recommended screw torque for locking the tabletop is 6-8 N·m; please keep the screws perpendicular to the mounting surface during installation.

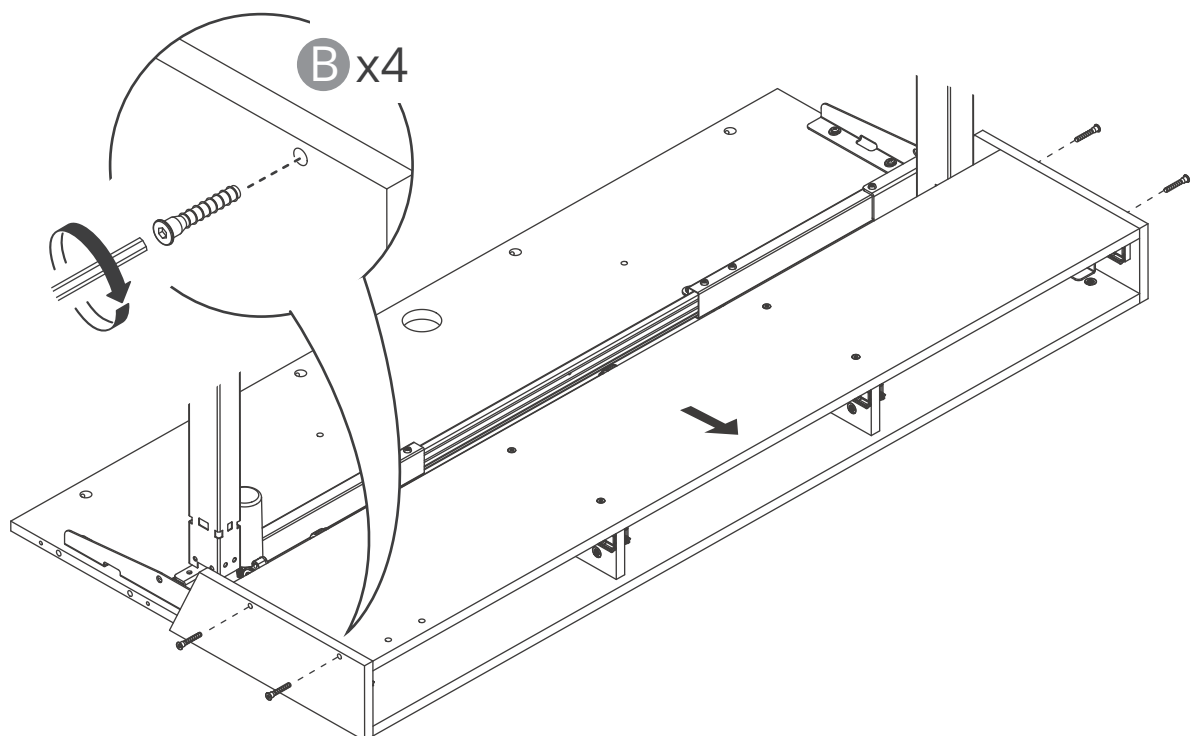

**17** The recommended screw torque for locking the tabletop is 6-8 N·m; please keep the screws perpendicular to the mounting surface during installation.

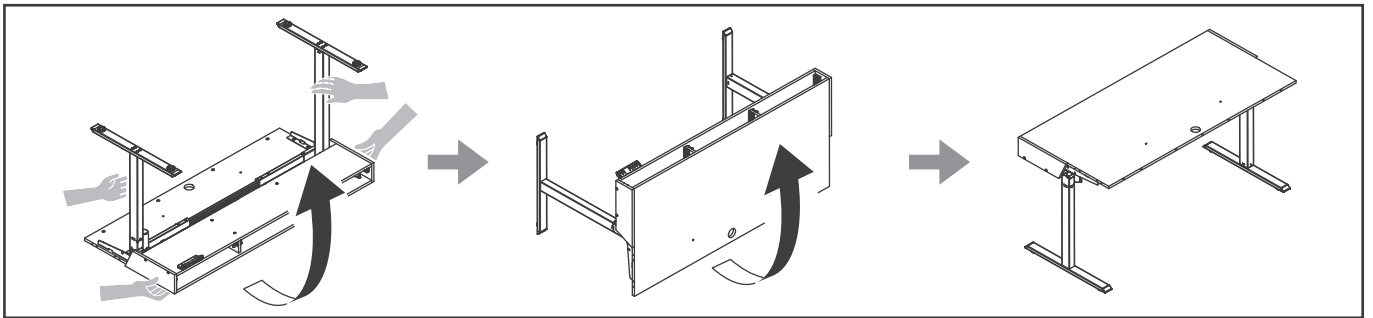
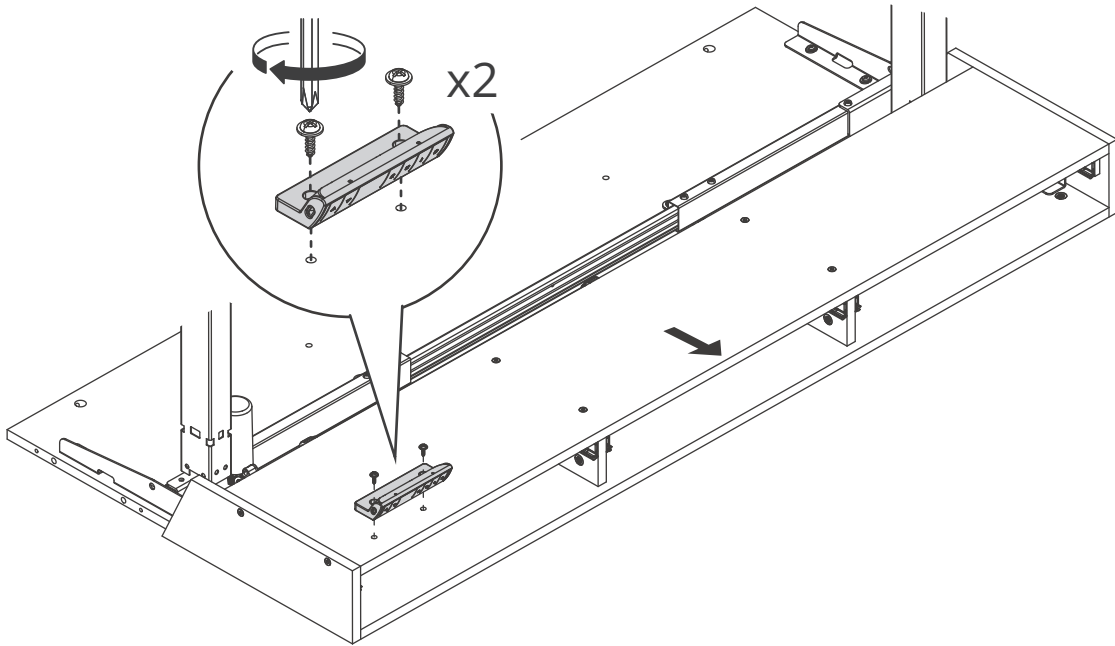

**18**

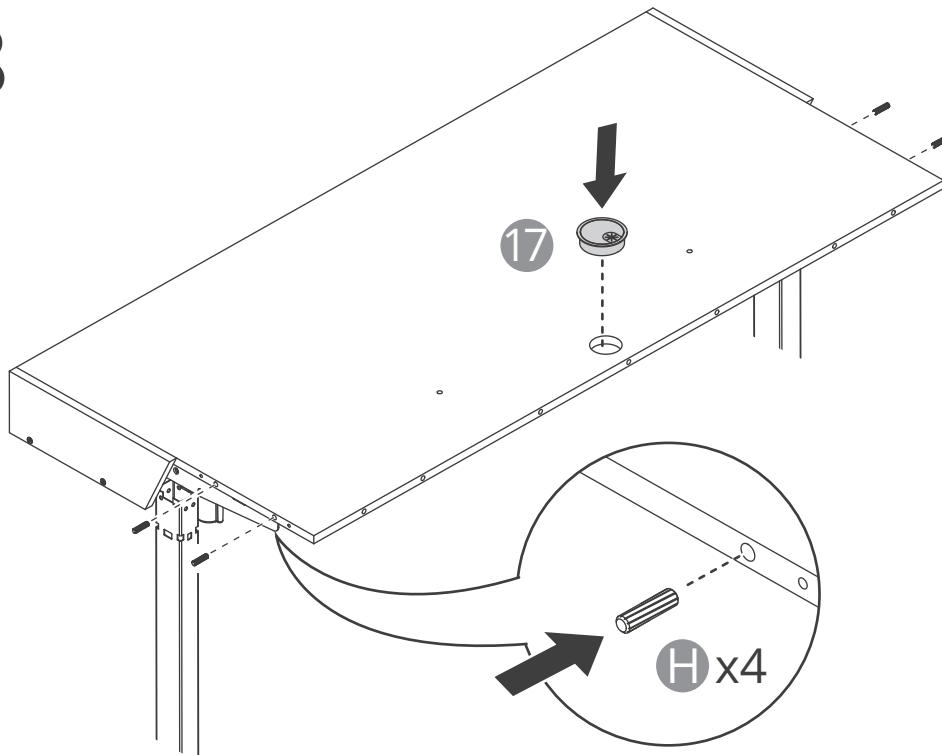

**19** The recommended screw torque for locking the tabletop is 6-8 N·m; please keep the screws perpendicular to the mounting surface during installation.

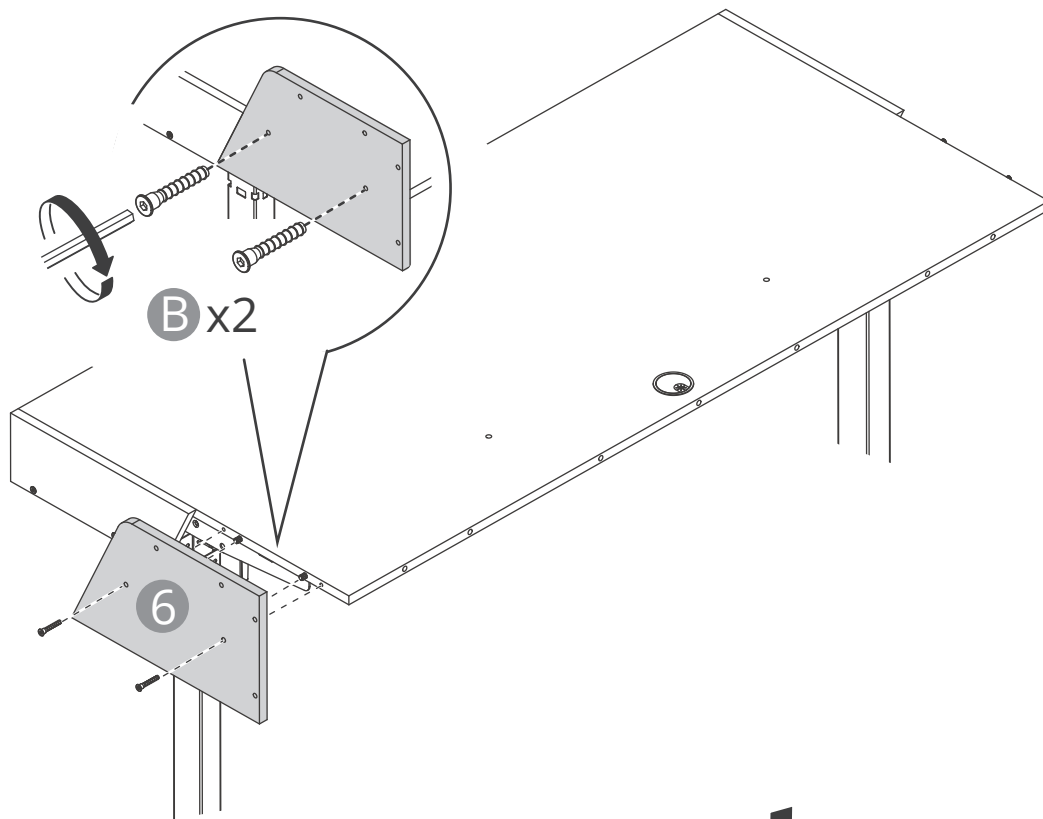

**20**

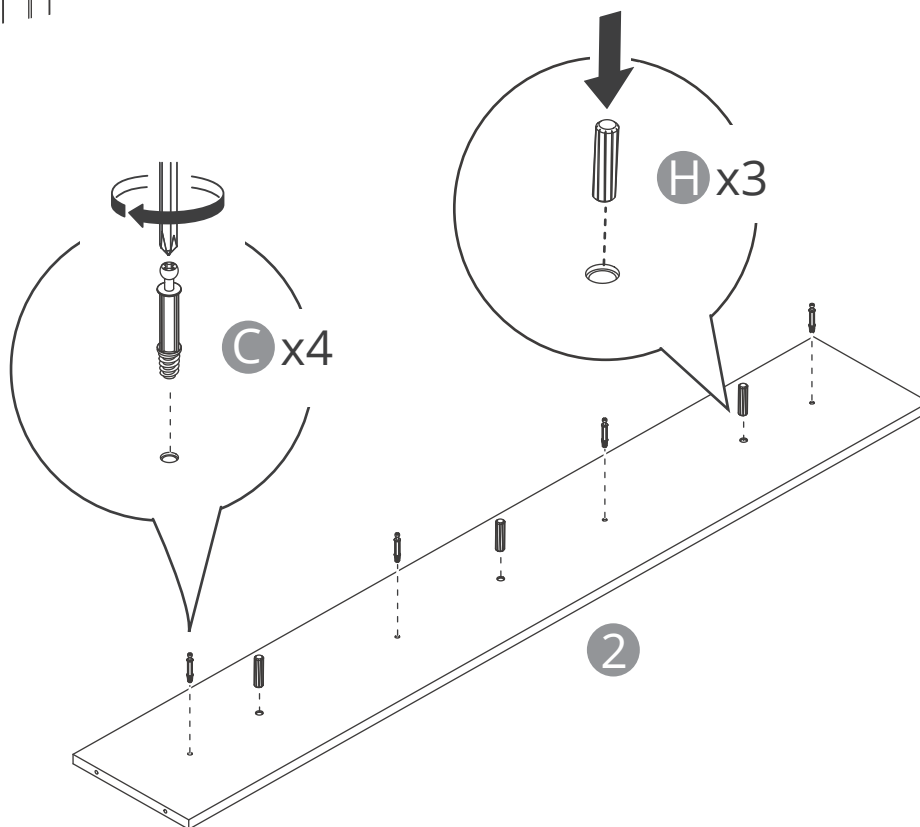

# 21

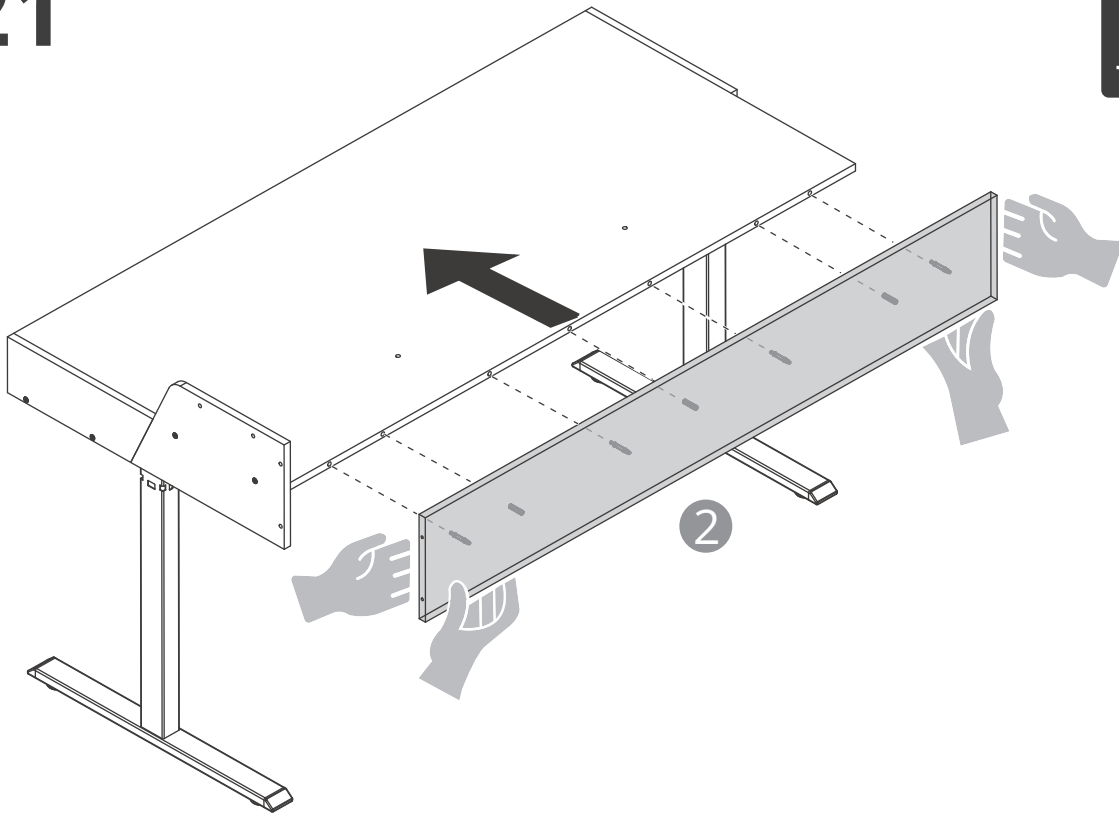

**22** The recommended screw torque for locking the tabletop is 6-8 N·m; please keep the screws perpendicular to the mounting surface during installation.

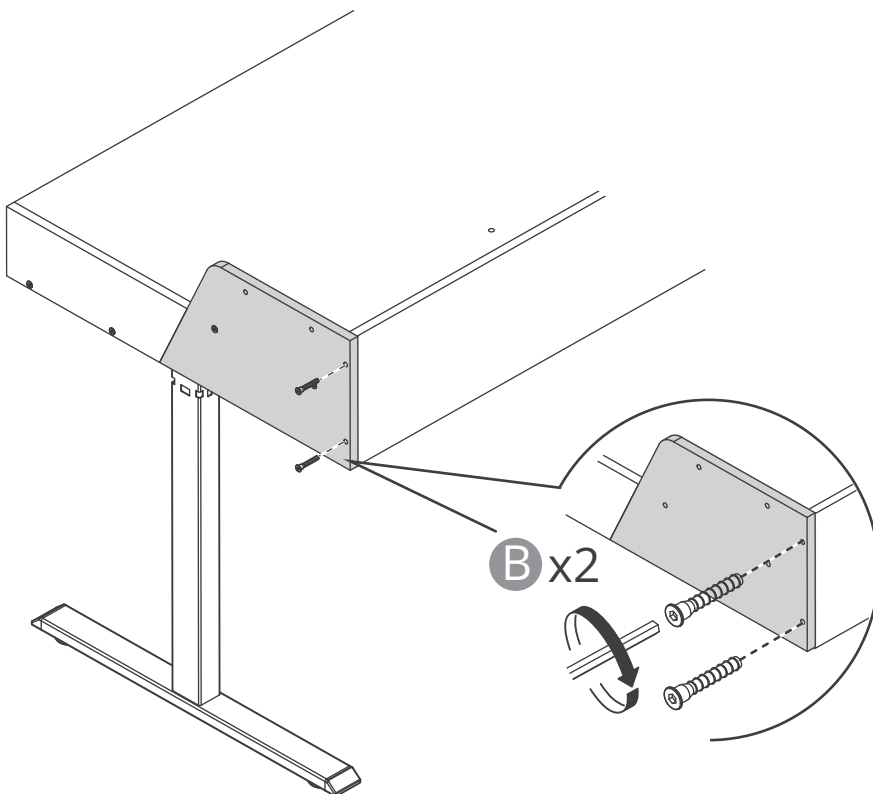

# 23

The recommended screw torque for locking the tabletop is 6-8 N·m; please keep the screws perpendicular to the mounting surface during installation.

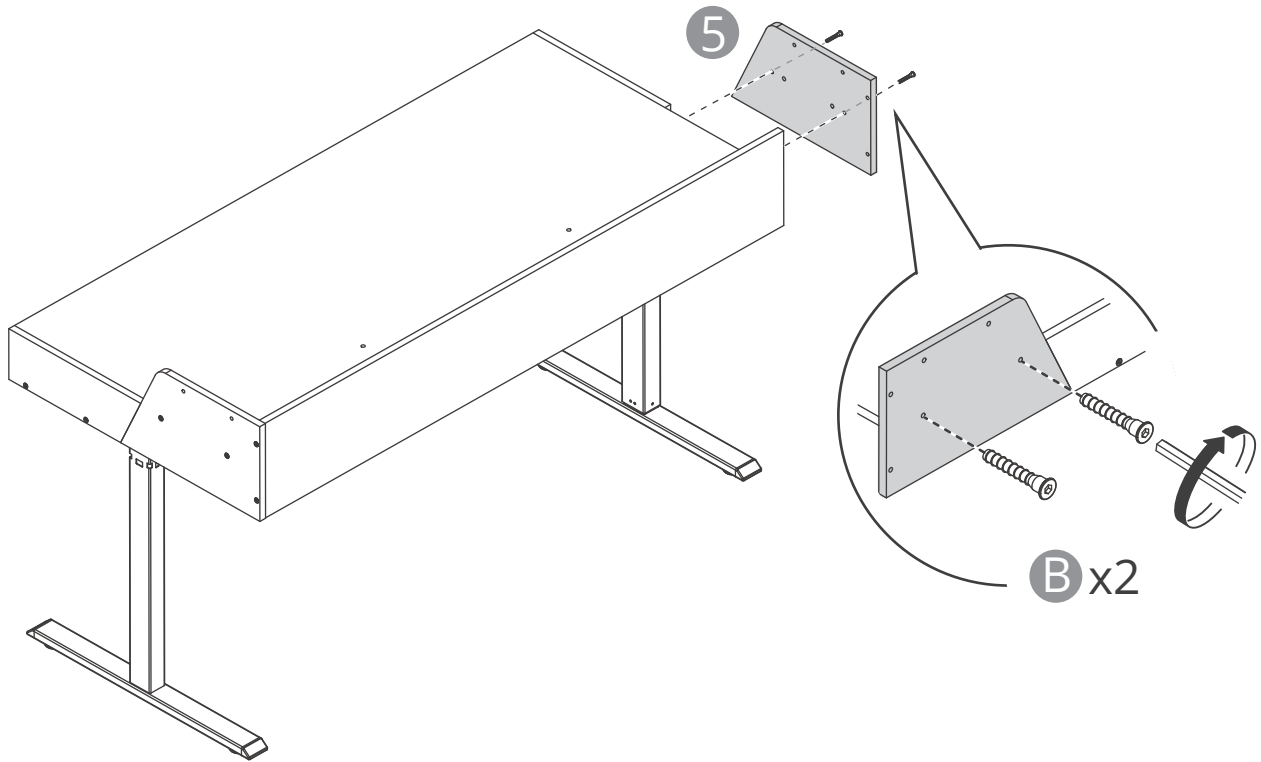

# 24

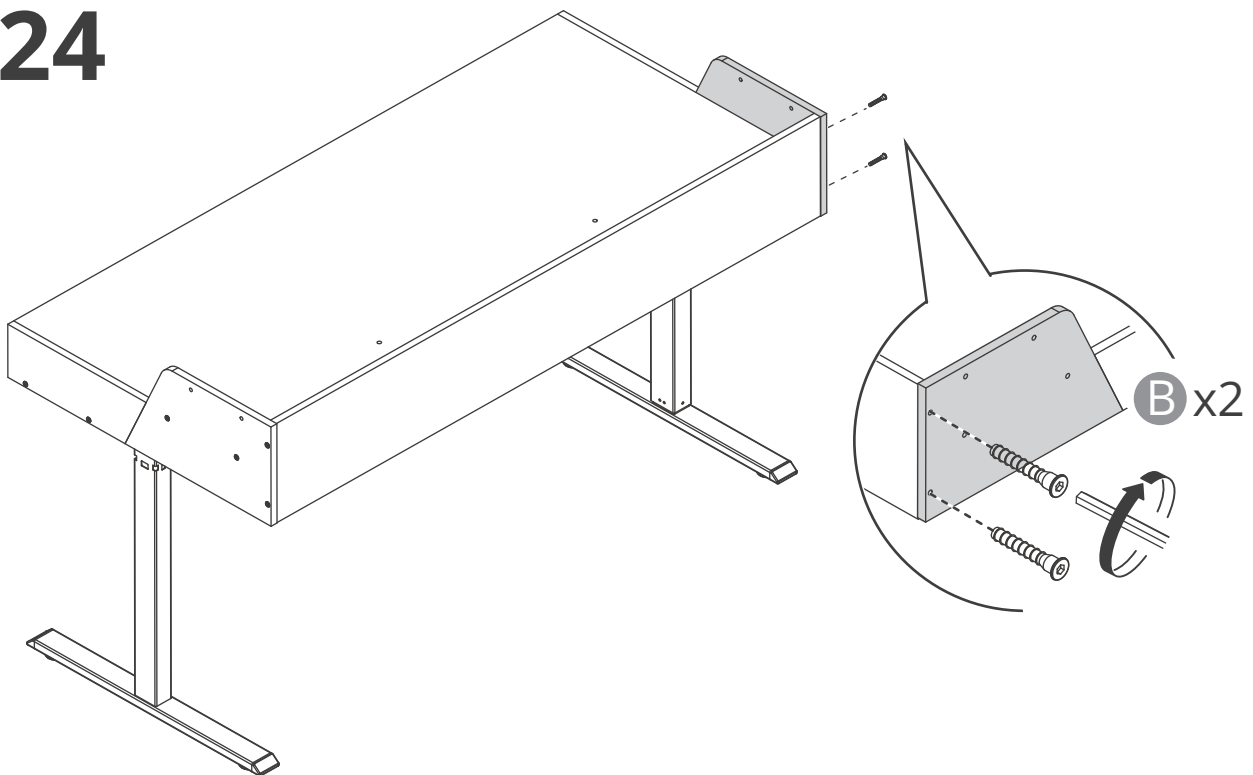

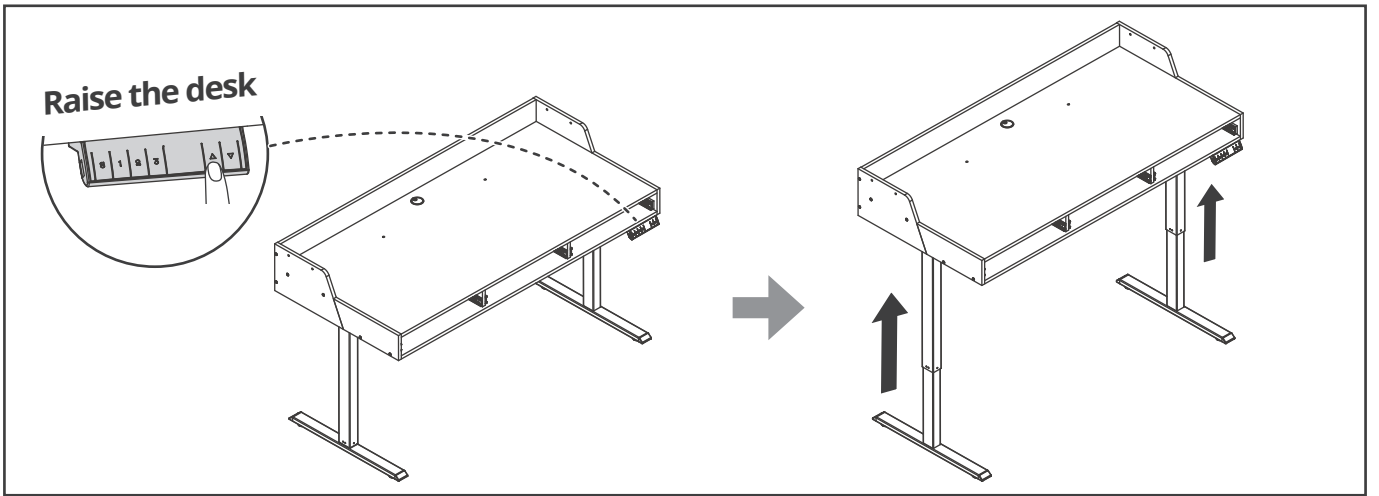

**25**

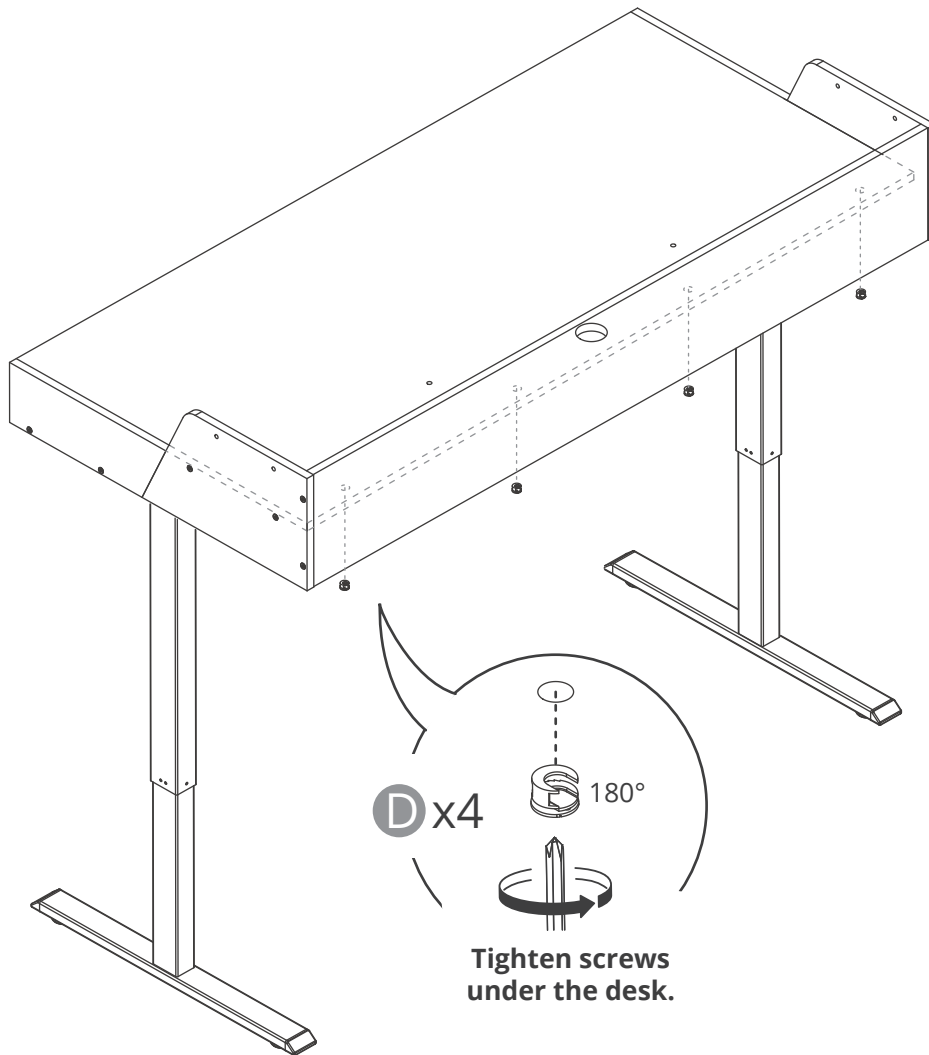

## 26 Option 1:

Install shelf with the **arrow sticker pointing backward**. This leaves a gap for cable management.

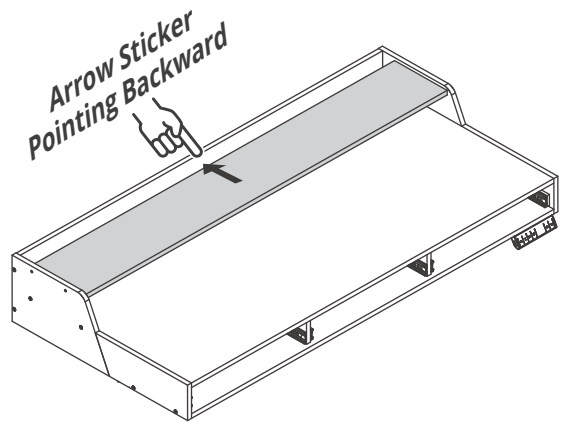
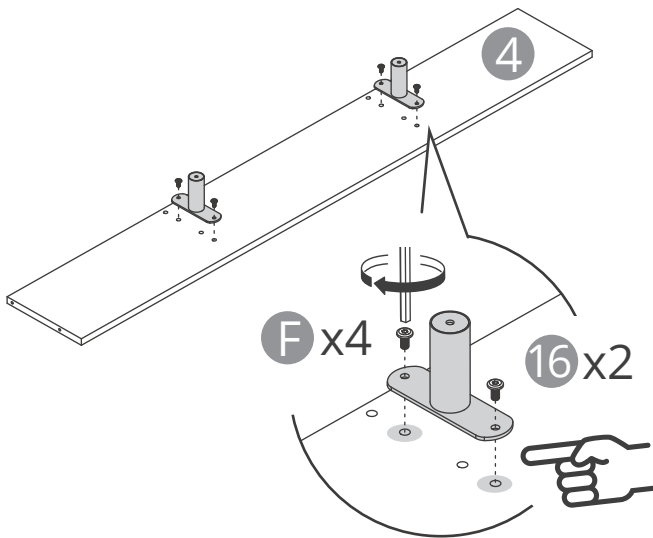
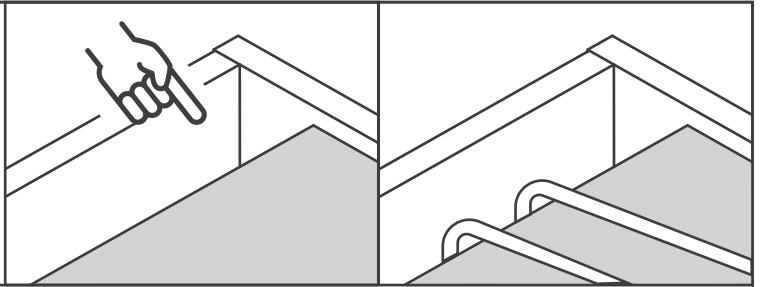

## 26 Option 2:

Install shelf with the **arrow sticker pointing forward**. The panel sits flush; cables must go behind.

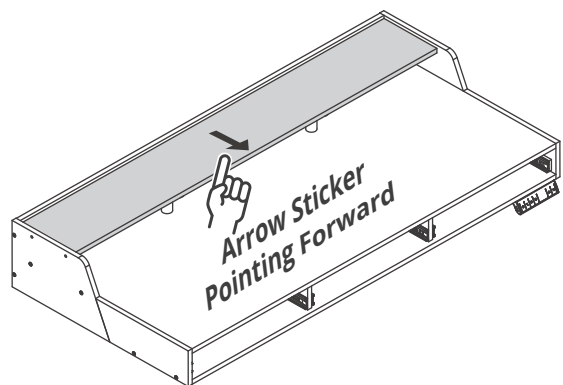
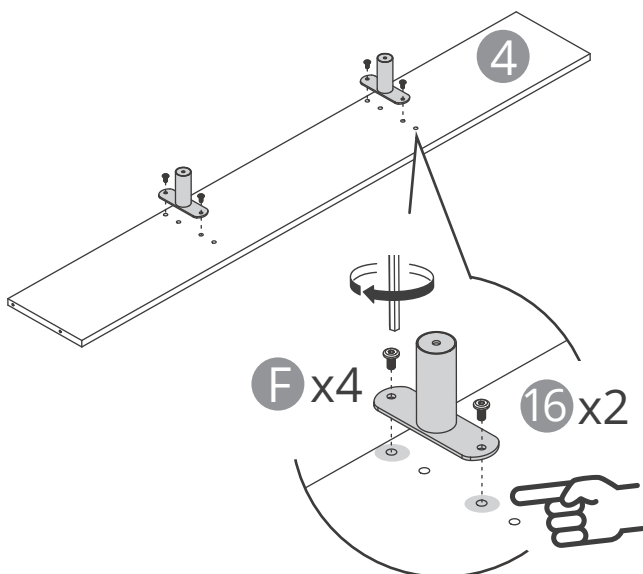
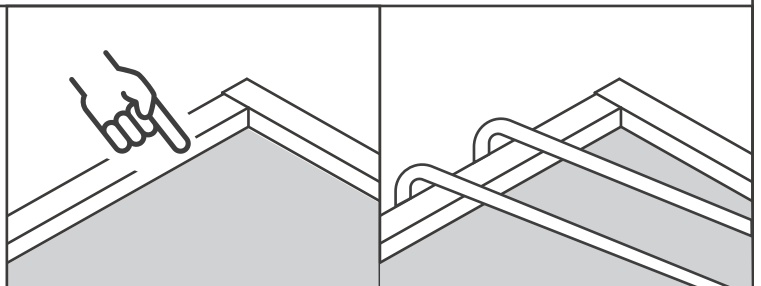

**27** The recommended screw torque for locking the tabletop is 6-8 N·m; please keep the screws perpendicular to the mounting surface during installation.

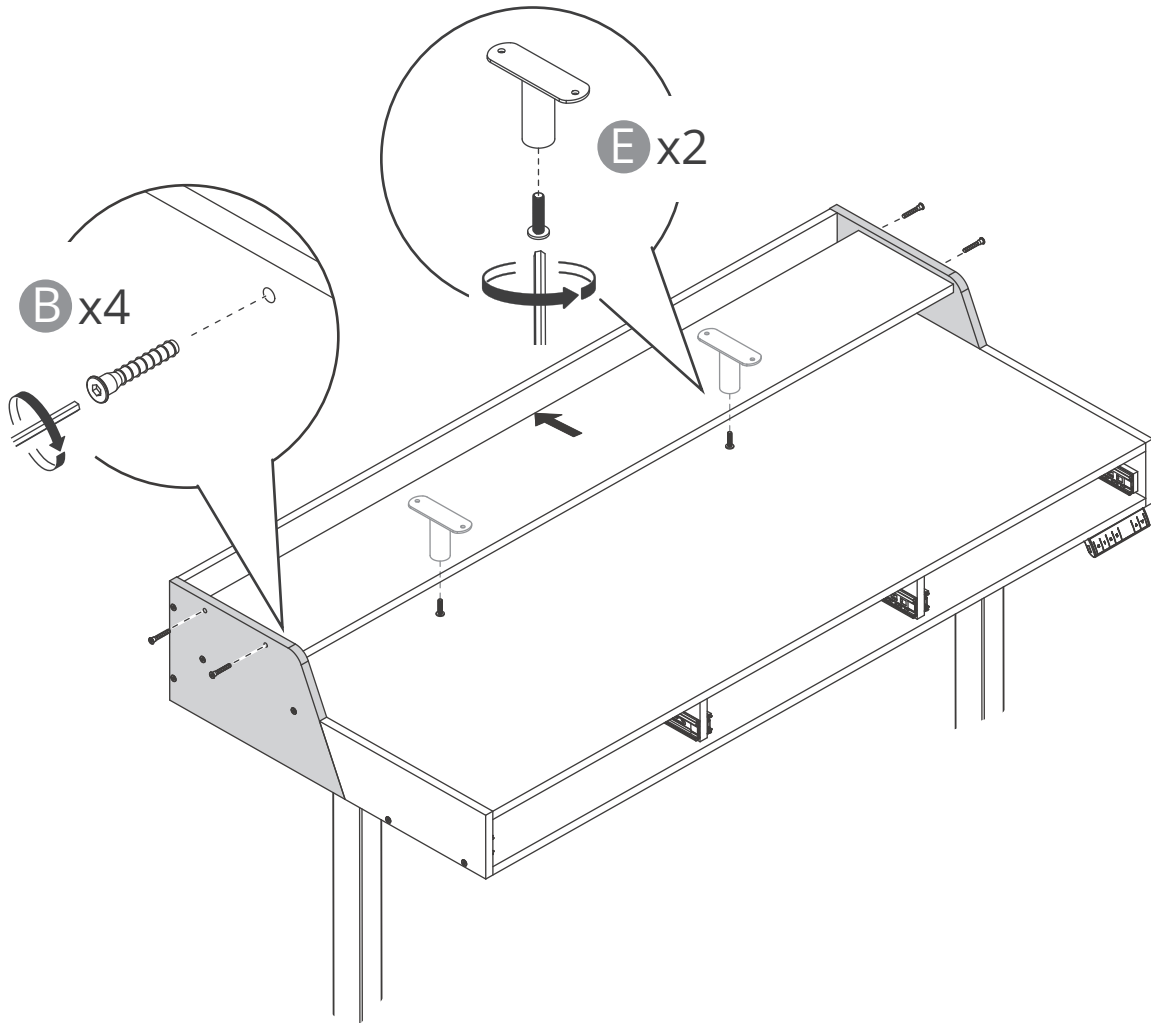

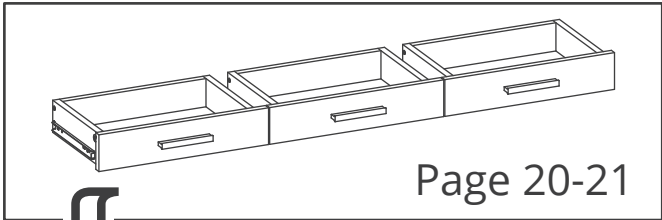

**i** The recommended screw torque for locking the tabletop is 6-8 N·m; please keep the screws perpendicular to the mounting surface during installation.

**28**

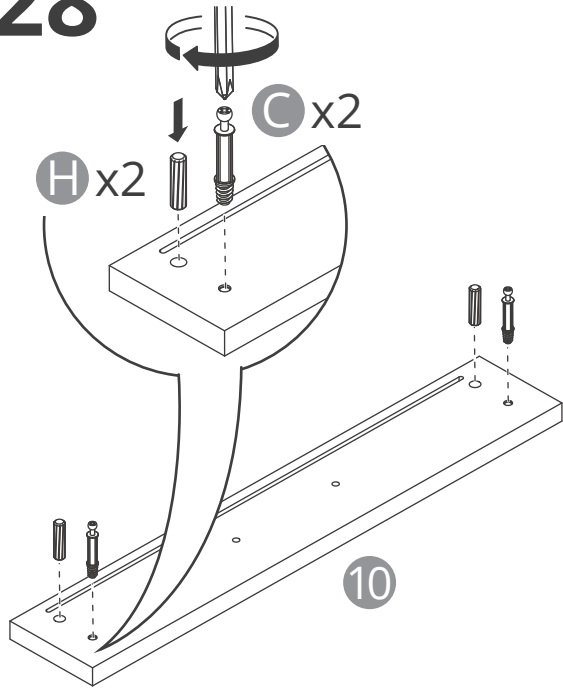

**29**

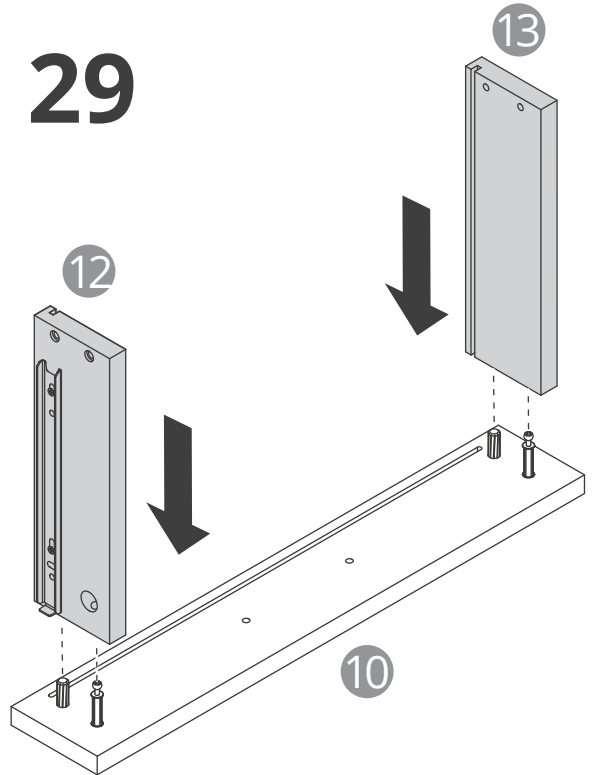

**30**

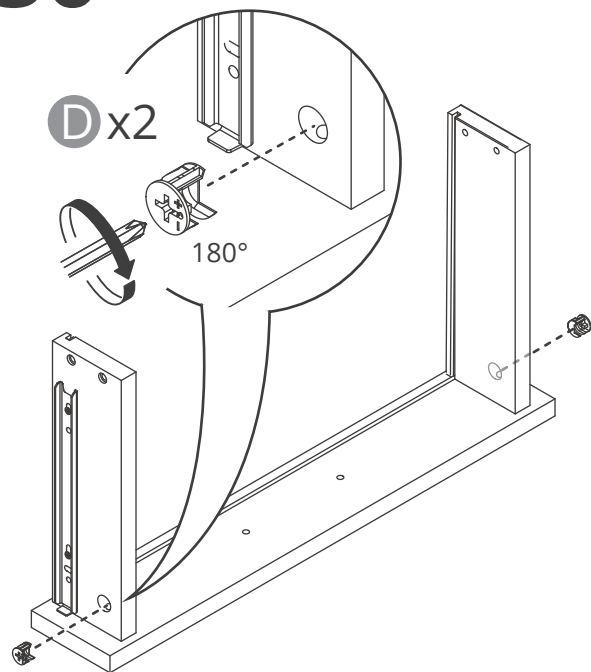

**31**

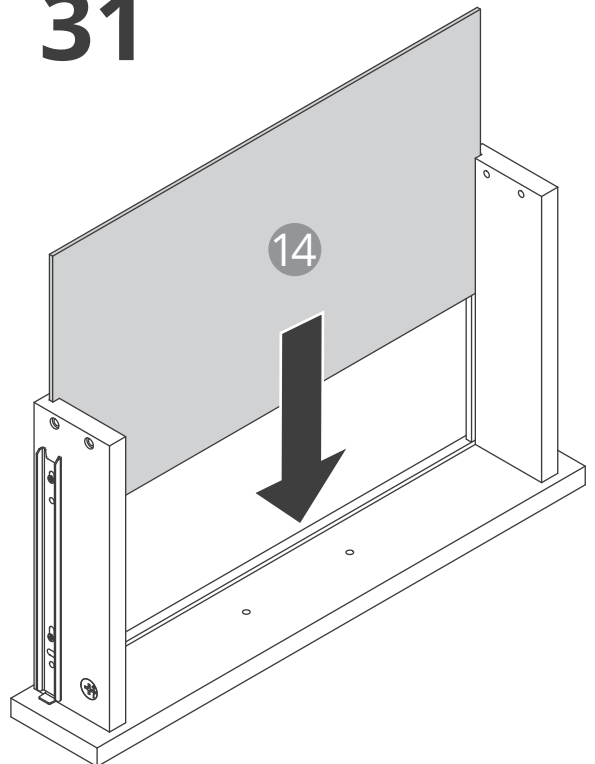

# 32

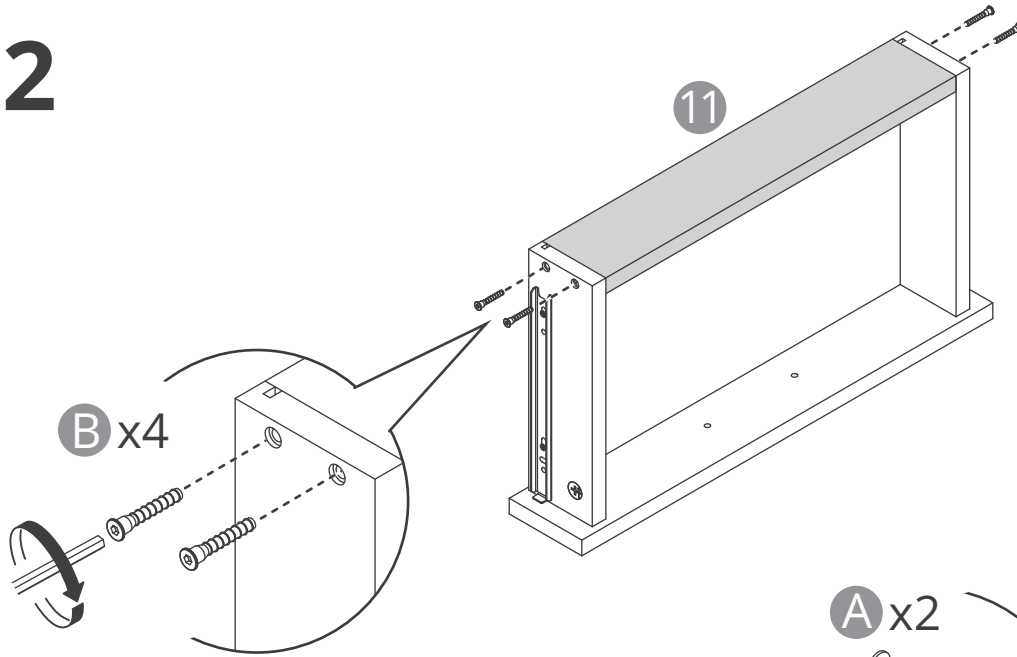

# 33

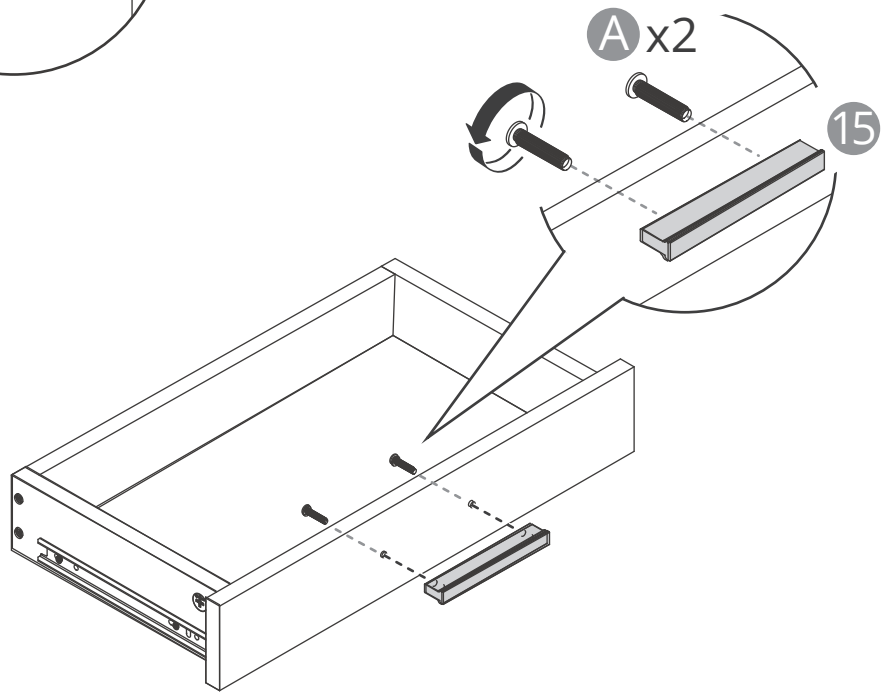

# 34

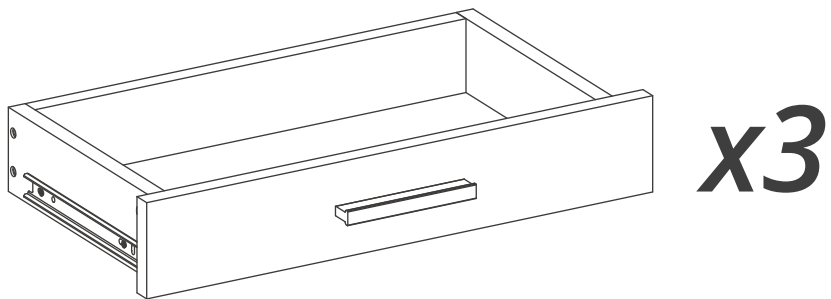

# 35

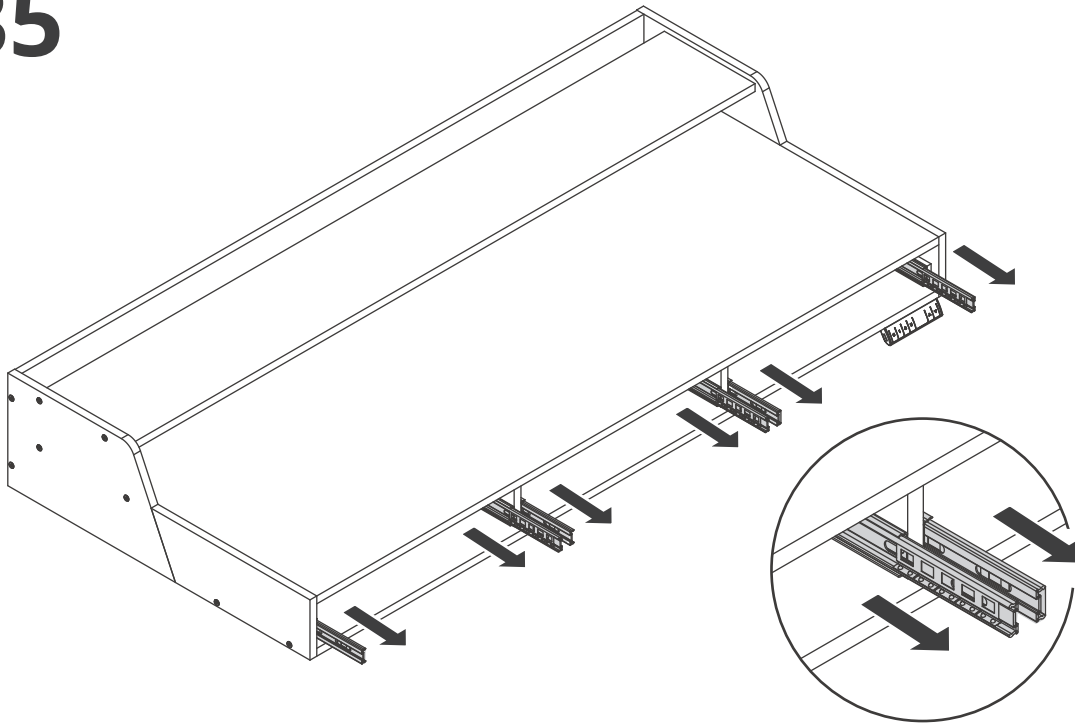

# 36

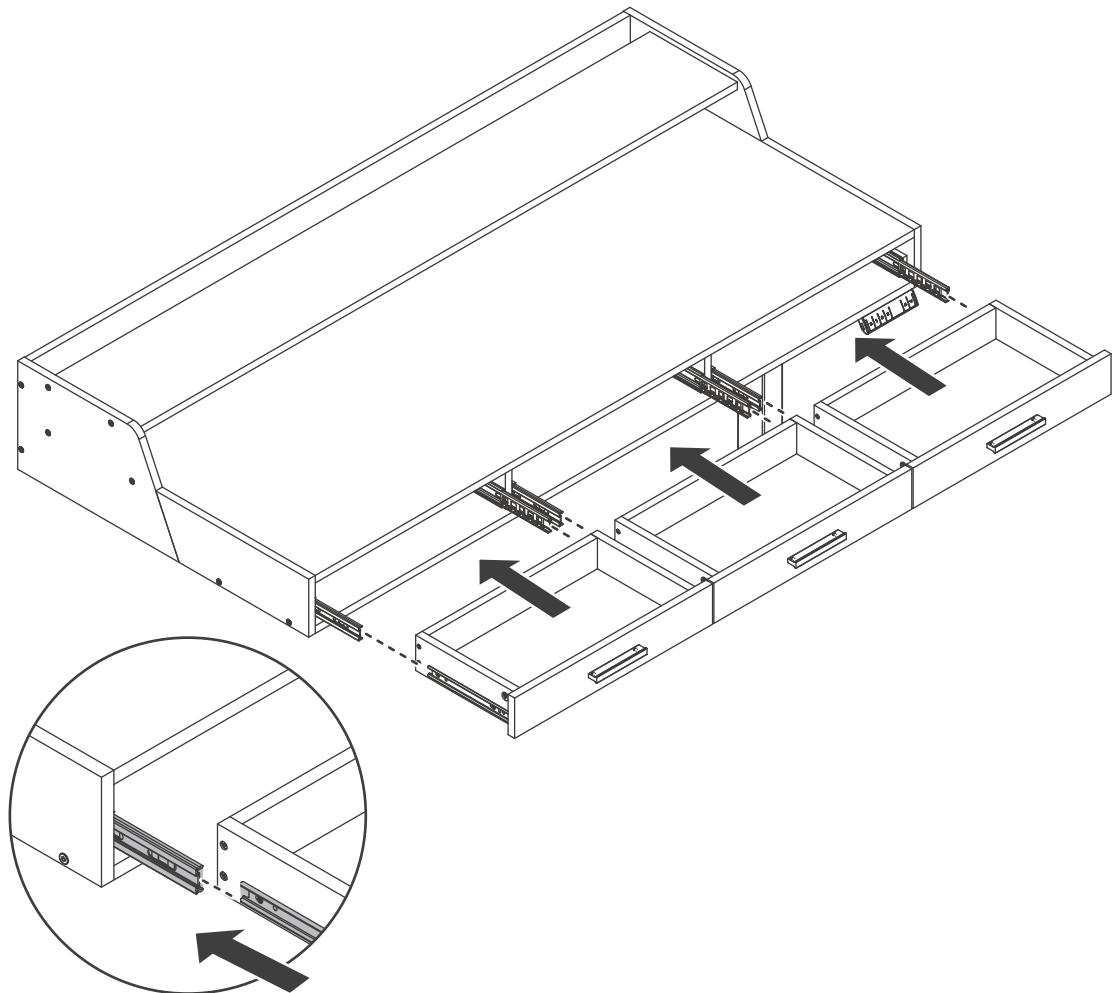

# 37

