

ASSEMBLY INSTRUCTIONS

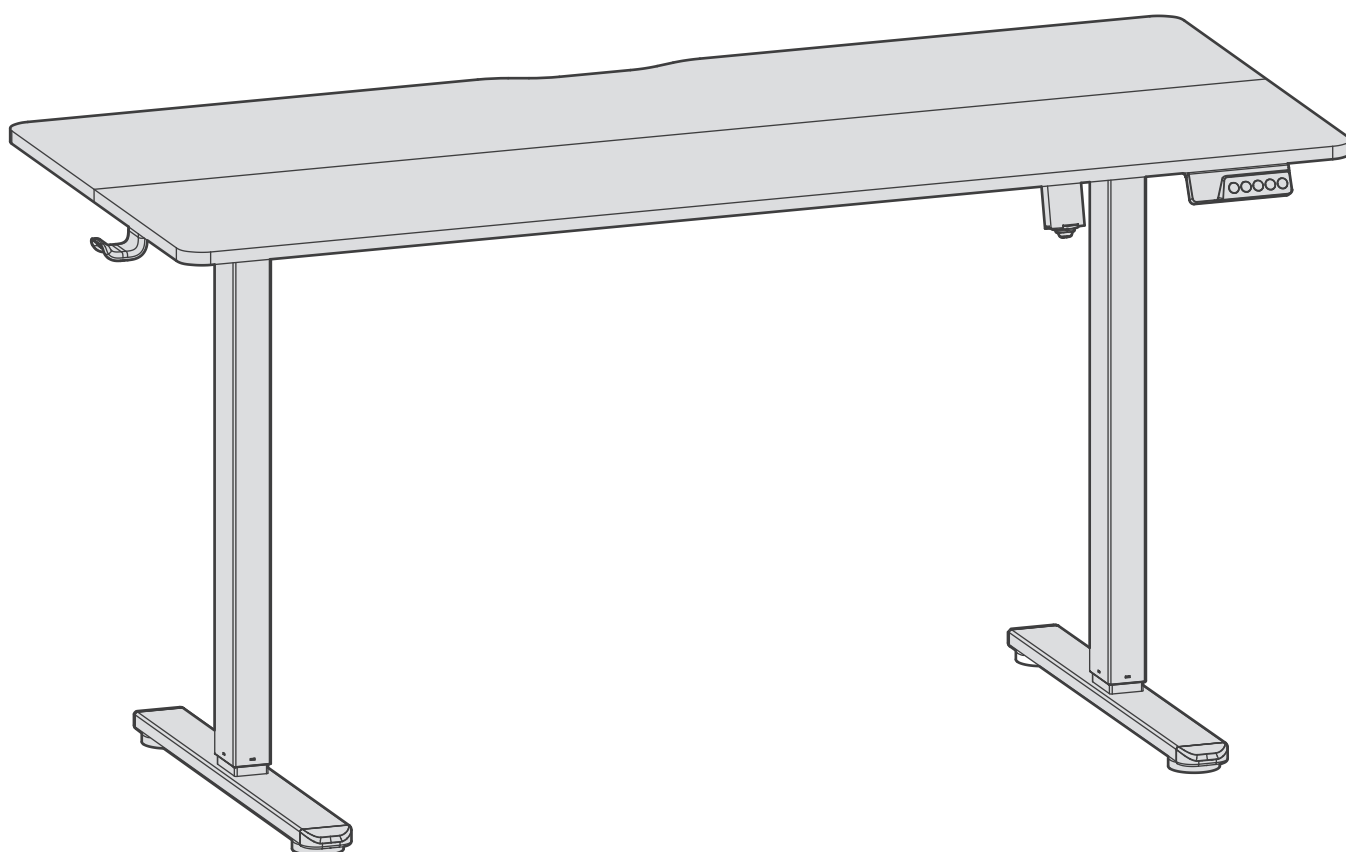

▶ Scan QR code for
installation video



For assembly assistance,
✉ support@yfs.life 🌐 yfs.life/sde0001-w1



Caution

- Keep children and animals away from the desk during use. Ensure the desktop is not touching any walls.
- Remove obstacles taller than 20"/51cm from underneath the desk.
- Operate only in a working environment temperature of 32°F-104°F/0°C-40°C.
- Keep product away from corrosive gases, liquids and dusty objects.
- Keep hands, feet and other body parts in a safe position during operation. Anti-collision is not automatically enabled during all resets.
- The company does not bear any warranty or liability for damage and human injury caused by any abnormal or un-intended operation of the equipment.
- It is necessary to perform a manual reset after the initial installation or power cycling the equipment.

Assembly Guide



Scan the QR code for installation videos and detailed user instructions.

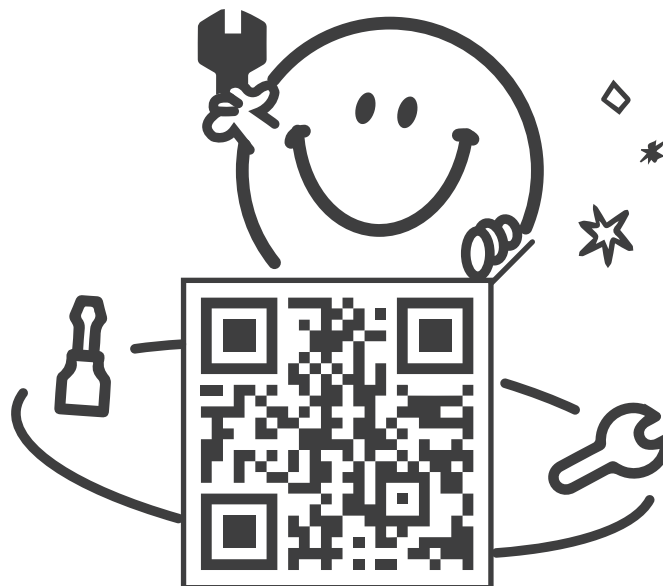

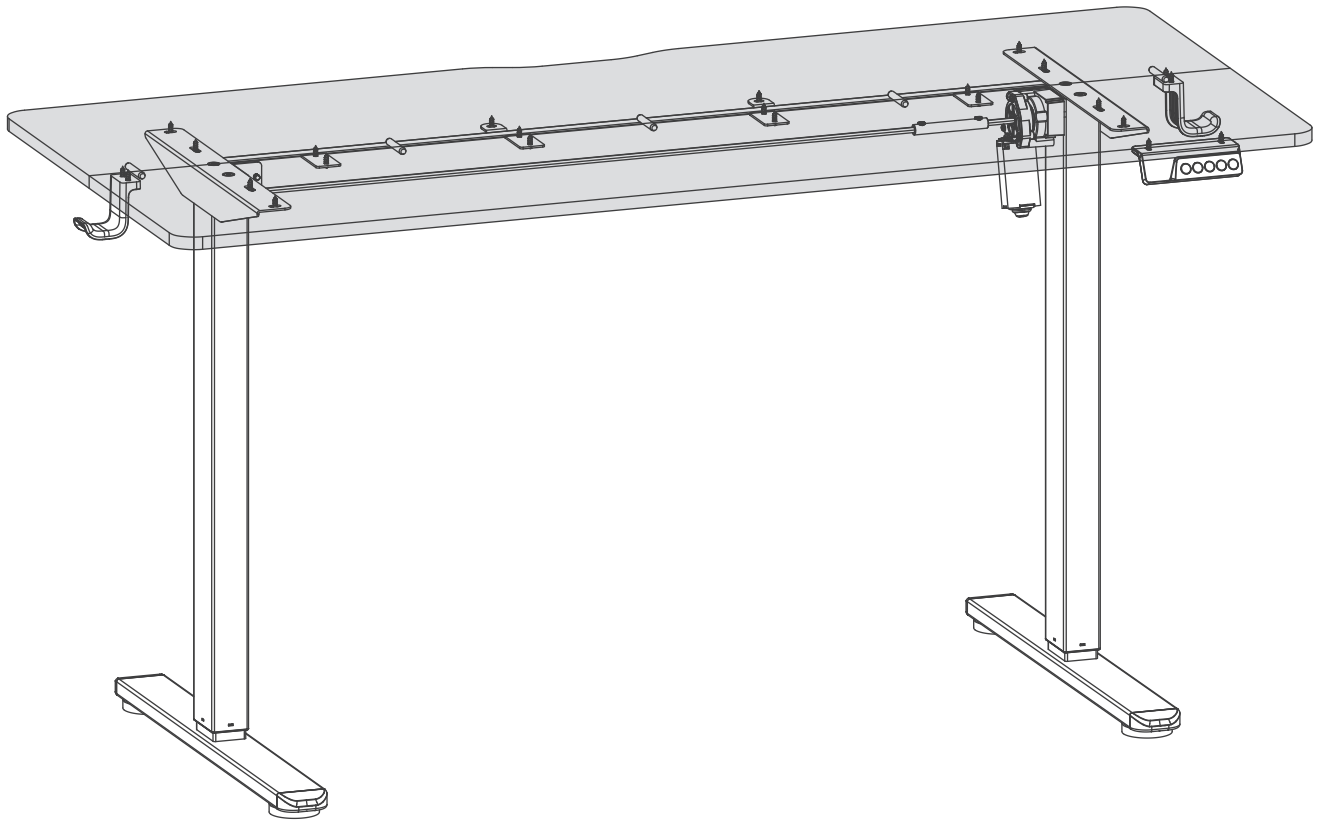
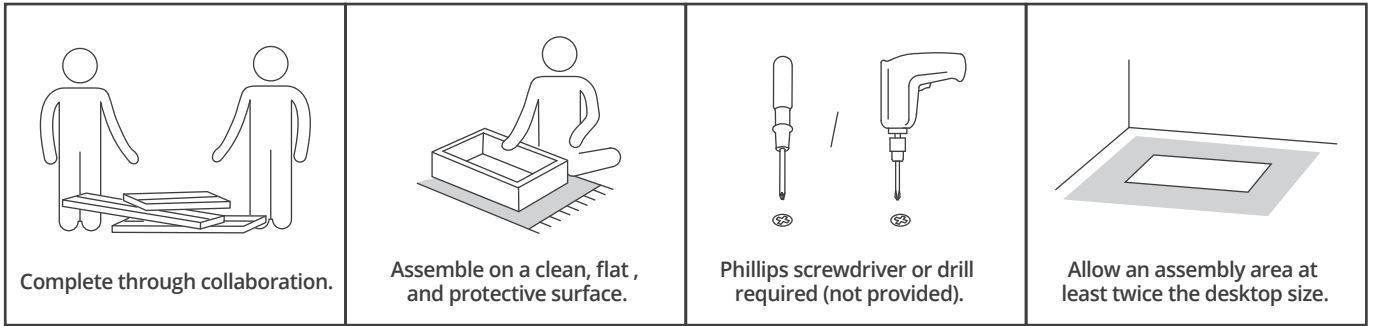

A x4

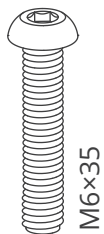

B x8



C x4



D x2

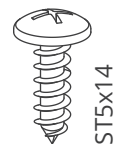

E x19 (40/48")
x24 (55")
x25 (63")

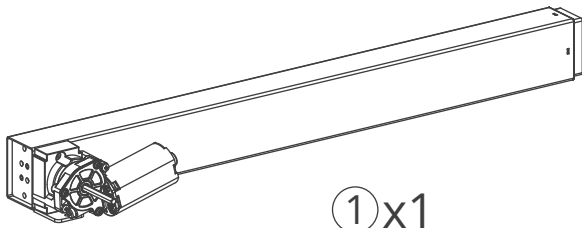

①x1

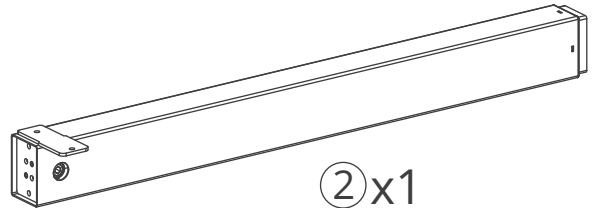

②x1

③

40"/48"

(685/885mm)

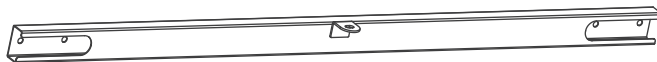

55"

(1085mm)



63"

(1285mm)

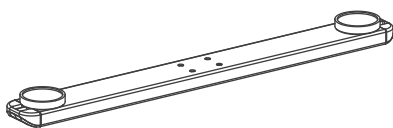
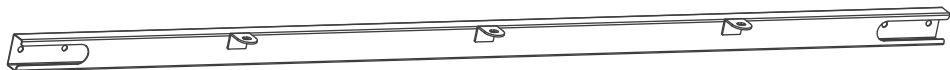

④x2

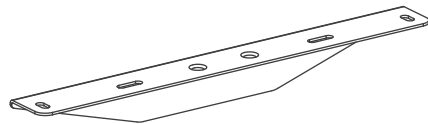

⑤x2 (40"/48": 378 mm)
(55"/63": 450 mm)

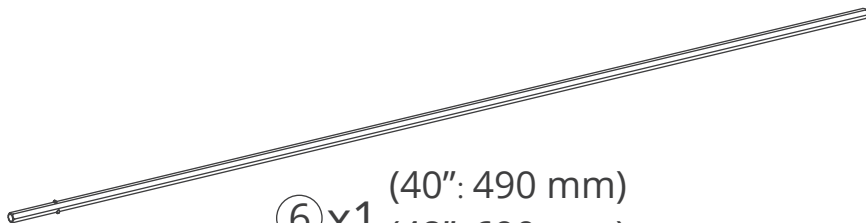

⑥x1

(40": 490 mm)
(48": 690 mm)
(55": 890 mm)
(63": 1090 mm)



⑦x1

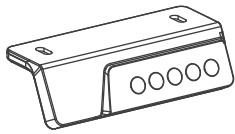

⑧x1

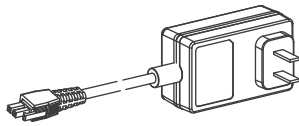

⑨x1

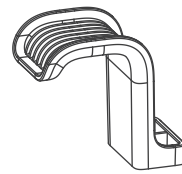

⑩x2

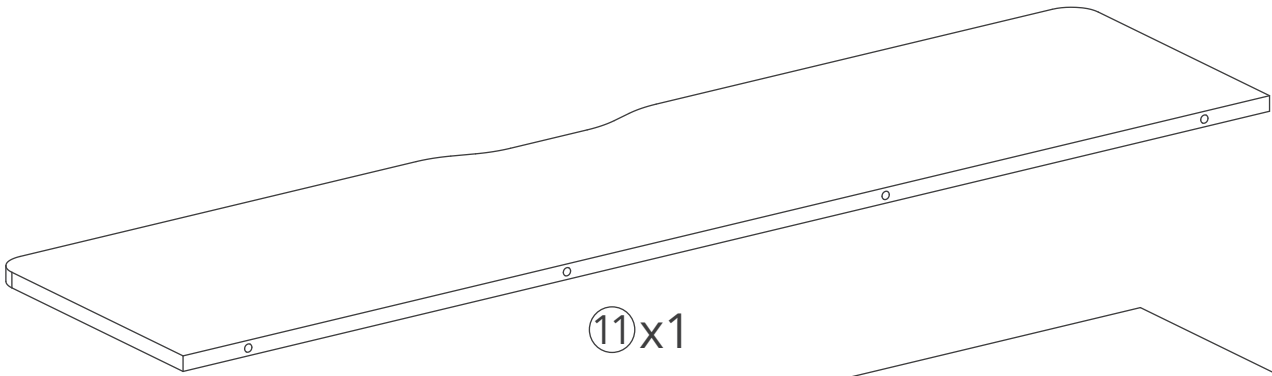

⑪x1

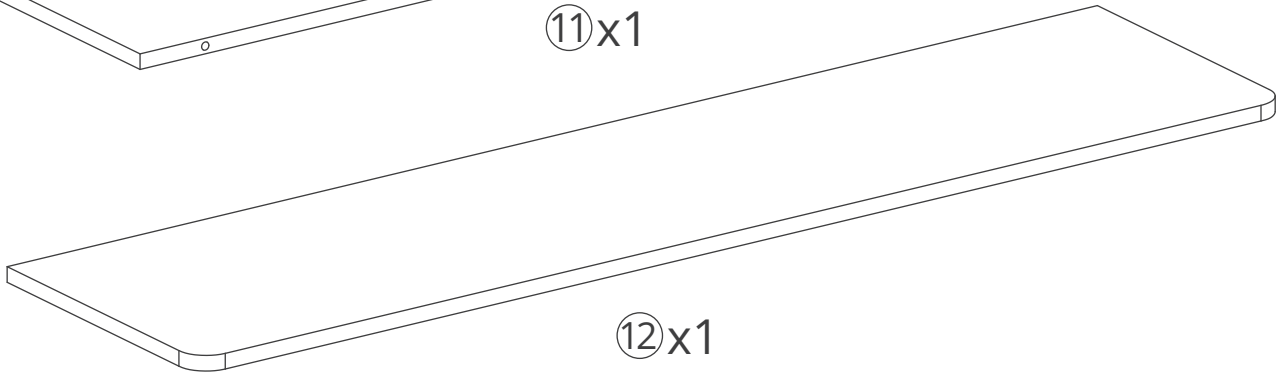

⑫x1

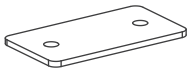

⑬x2 (40"/48")
x4 (55"/63")



⑭x4 (40"/48")
x5 (55")
x6 (63")



⑮x1



⑯x1



⑰x1

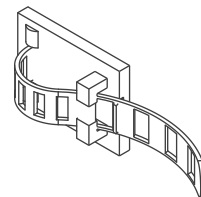

⑱x2

1

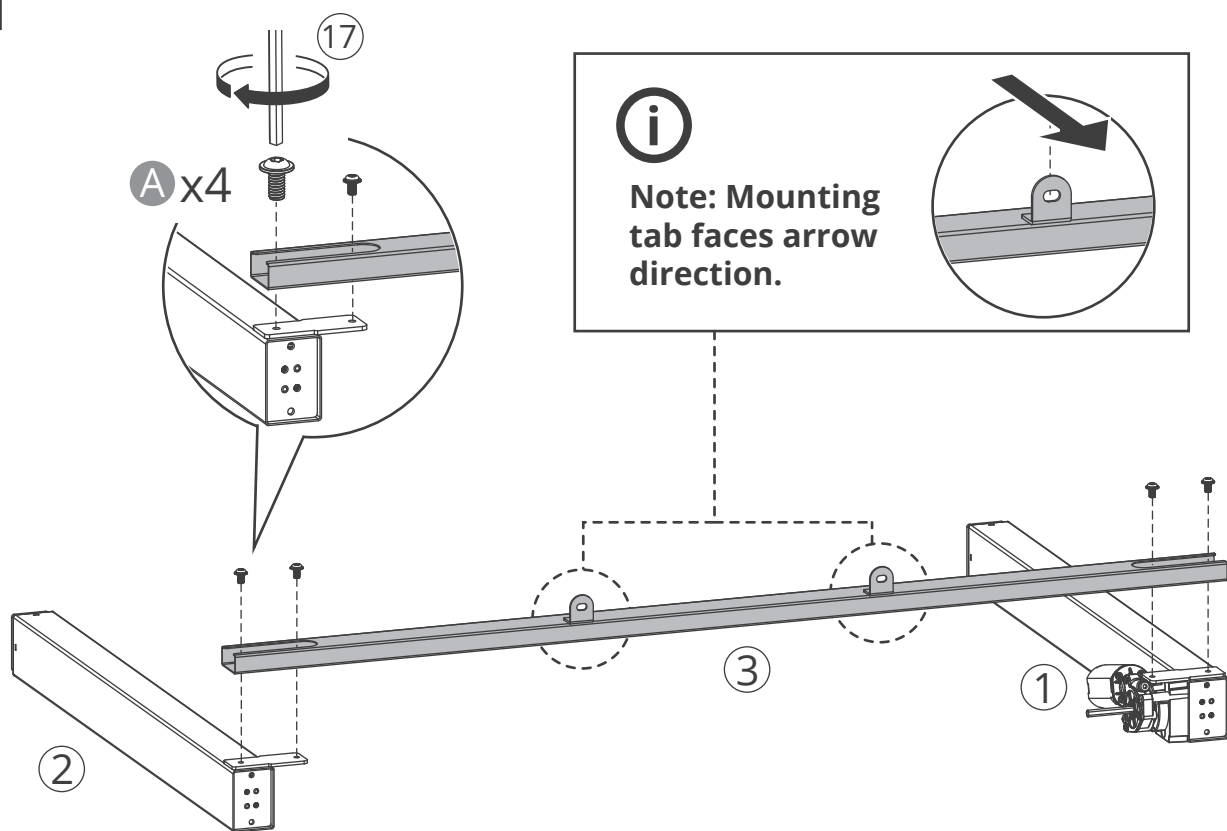

2

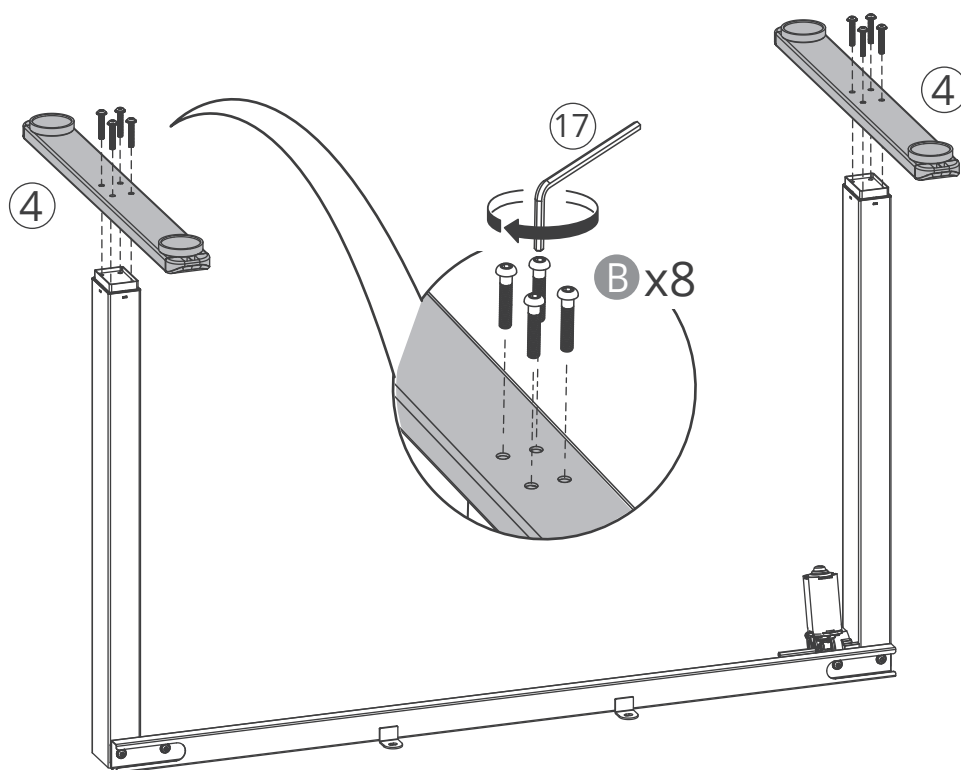

3

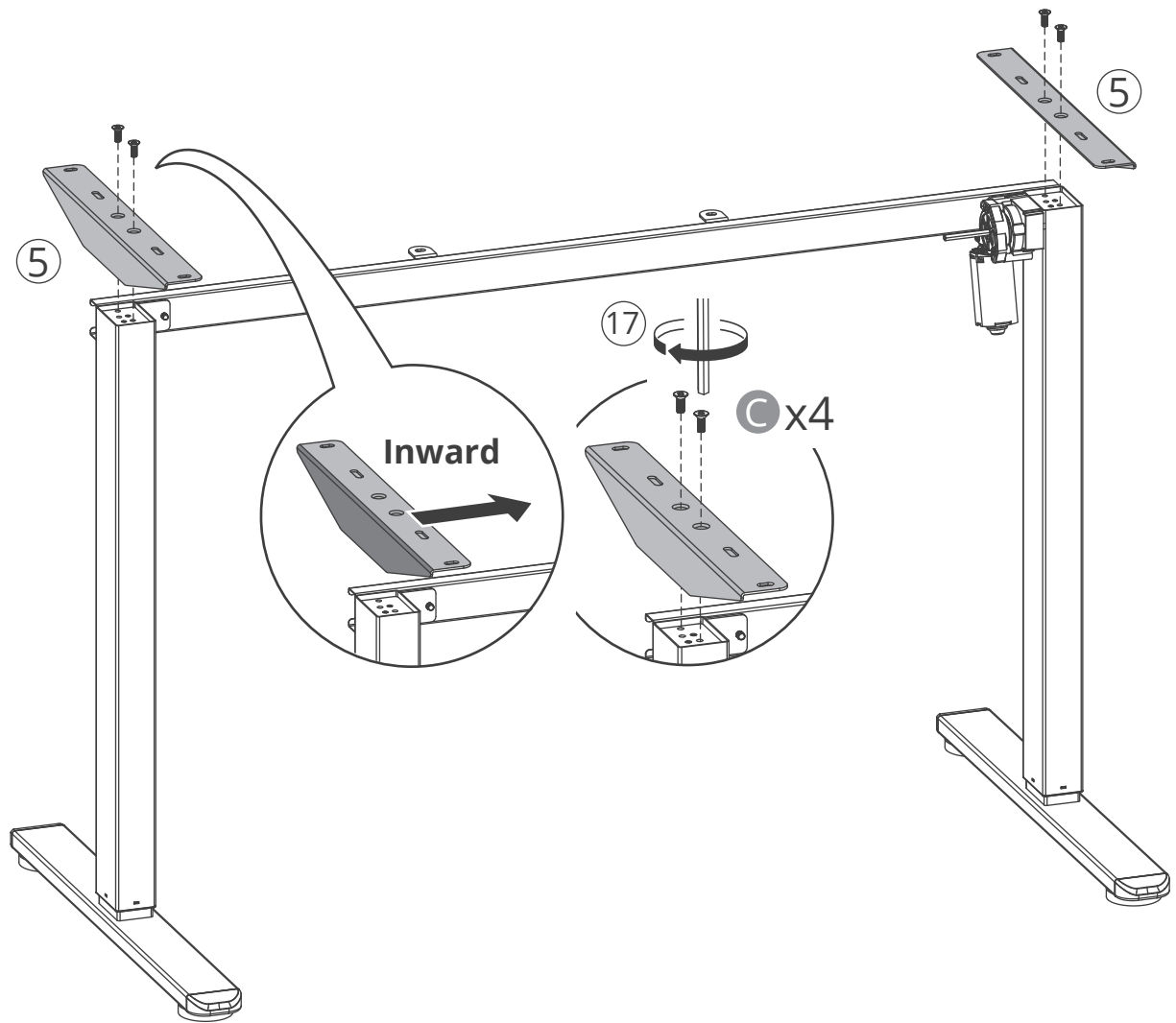

4

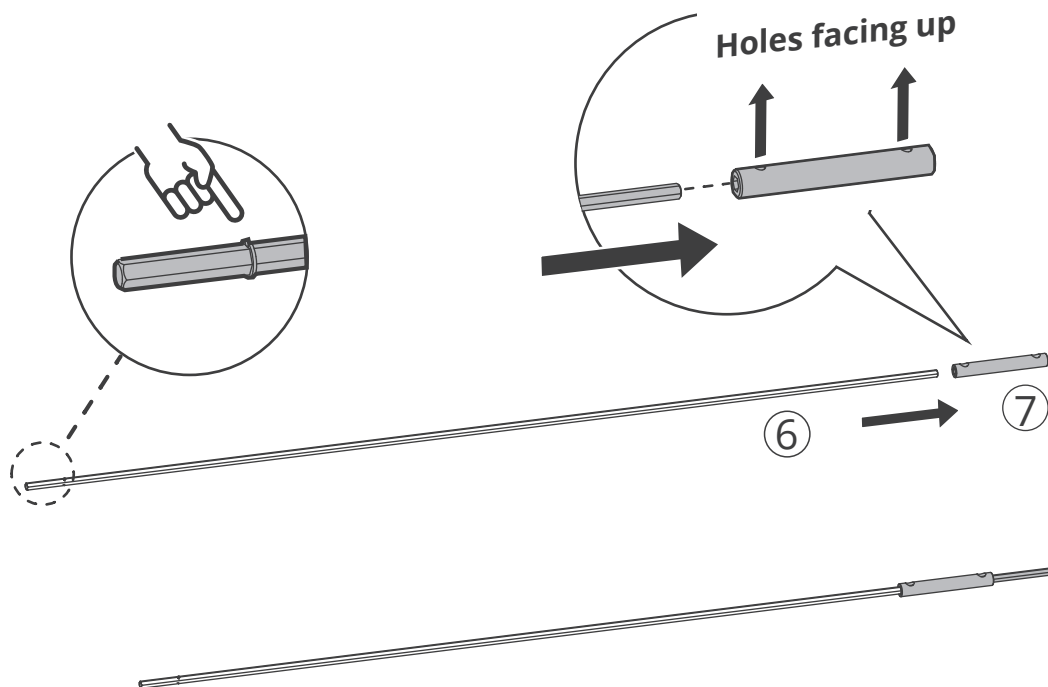

5

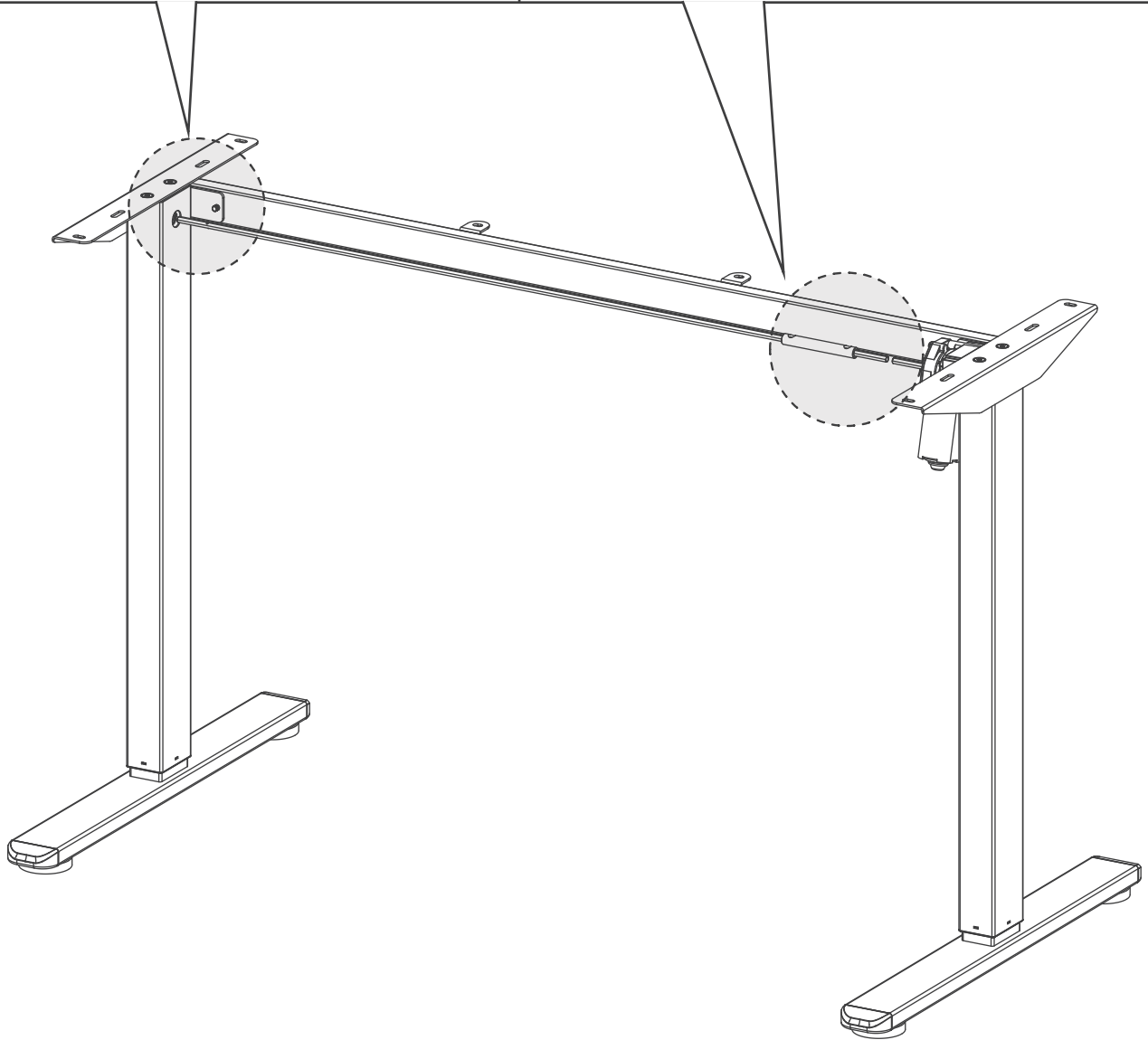
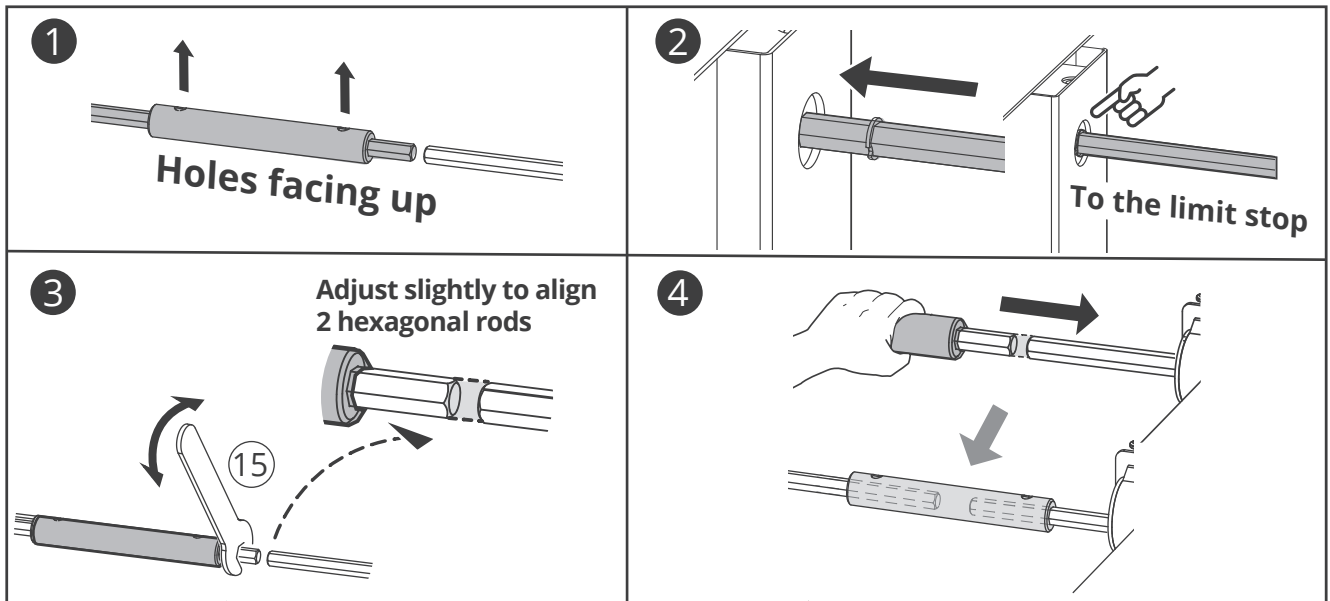

6

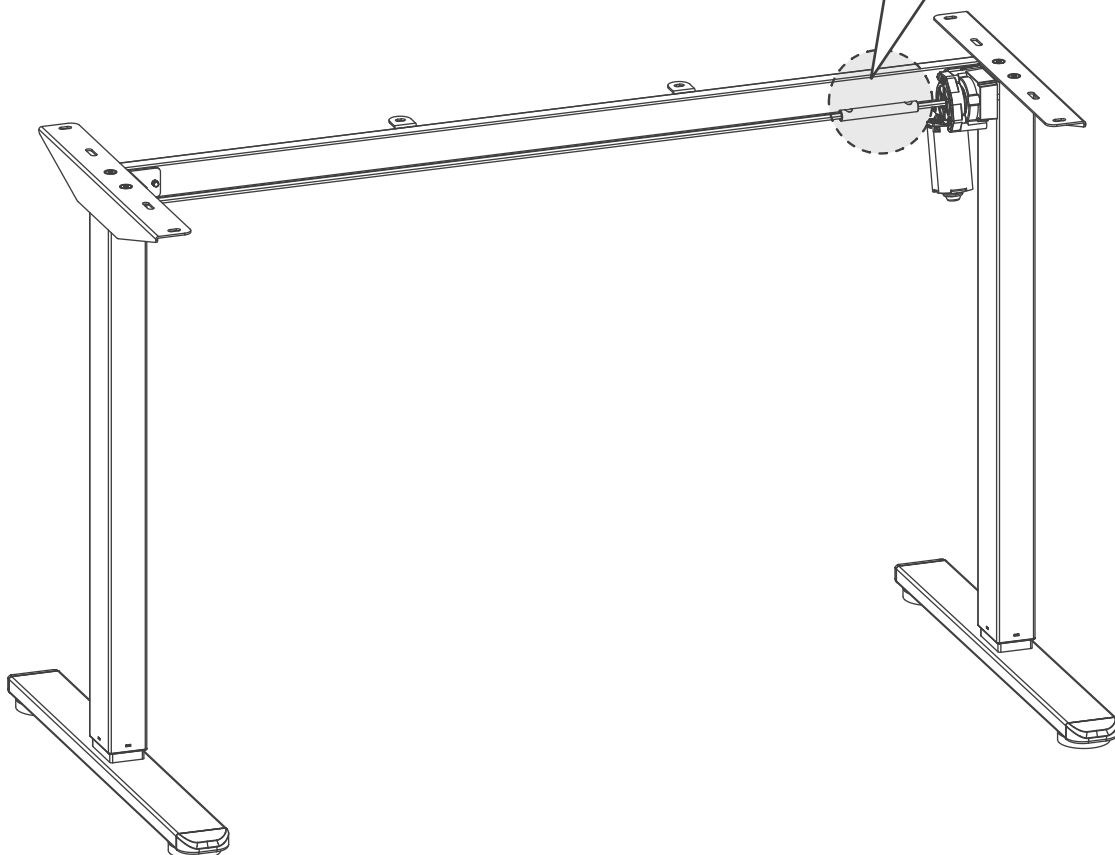
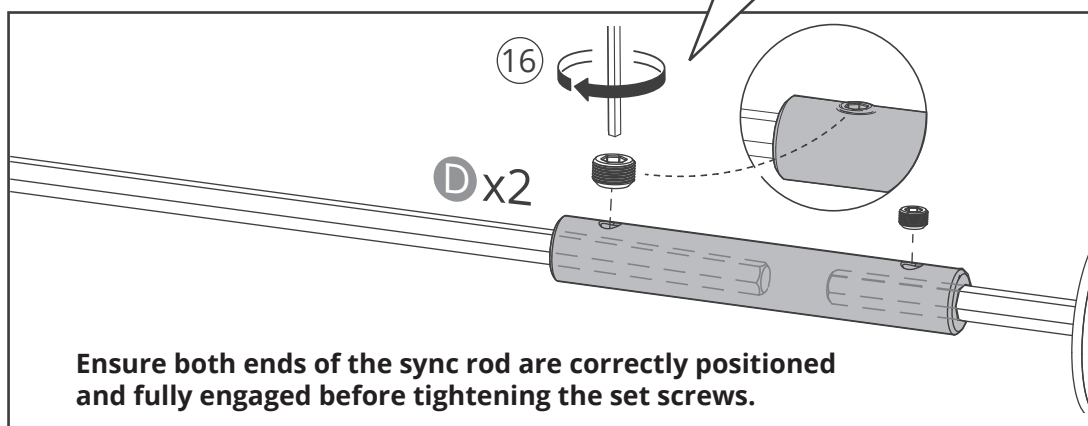
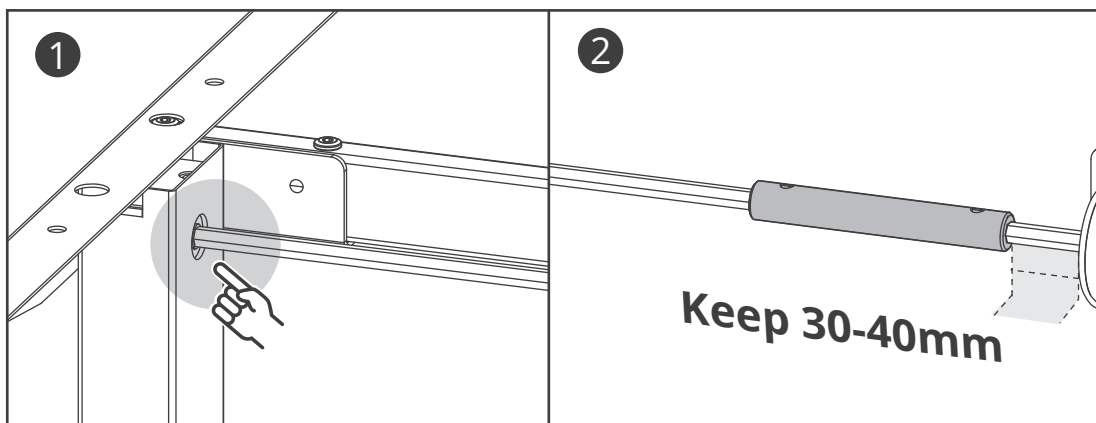

7

40"/48"
(100cm/120cm)

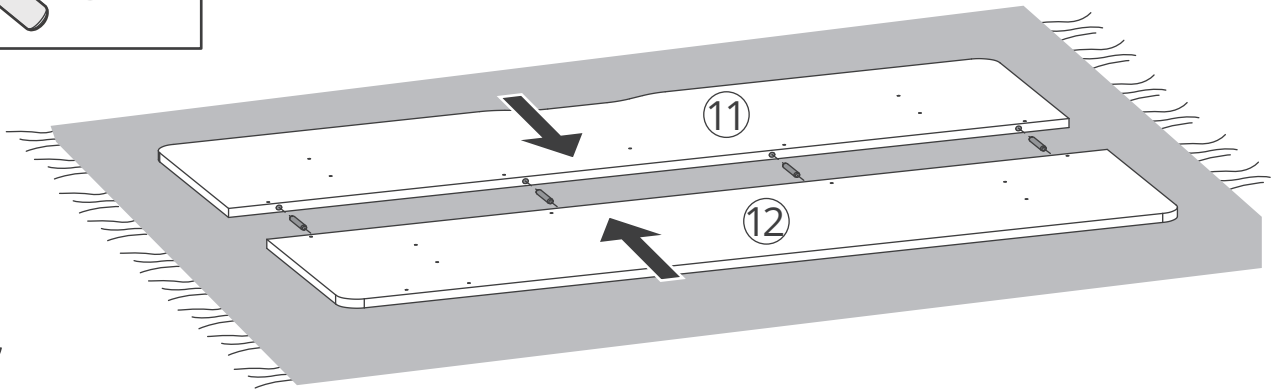
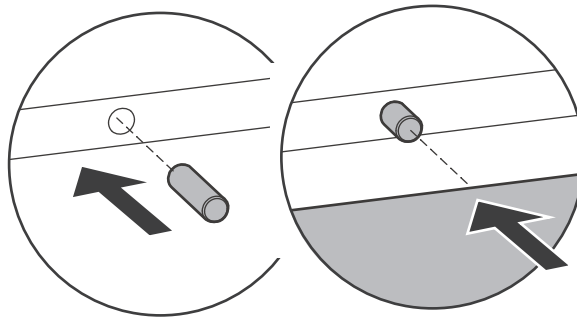
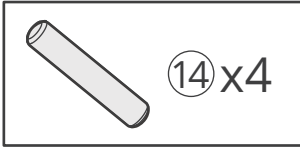

55"
(140cm)

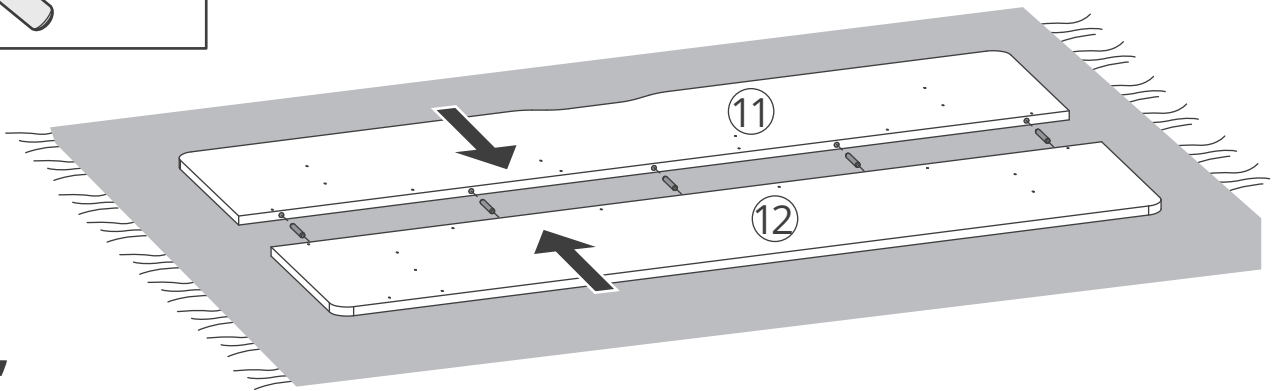
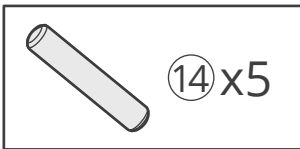

63"
(160cm)

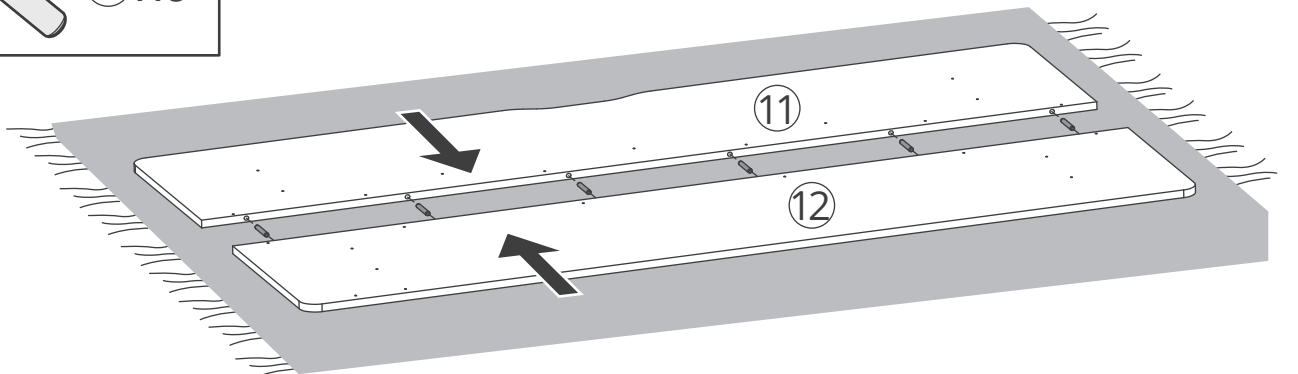
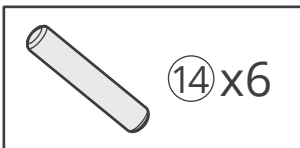

8

⚠ WARNING:

Do not over-tighten, risk damaging the tabletop.
Recommended drill torque: 4-5 N·m.

40"/48"
(100cm/120cm)

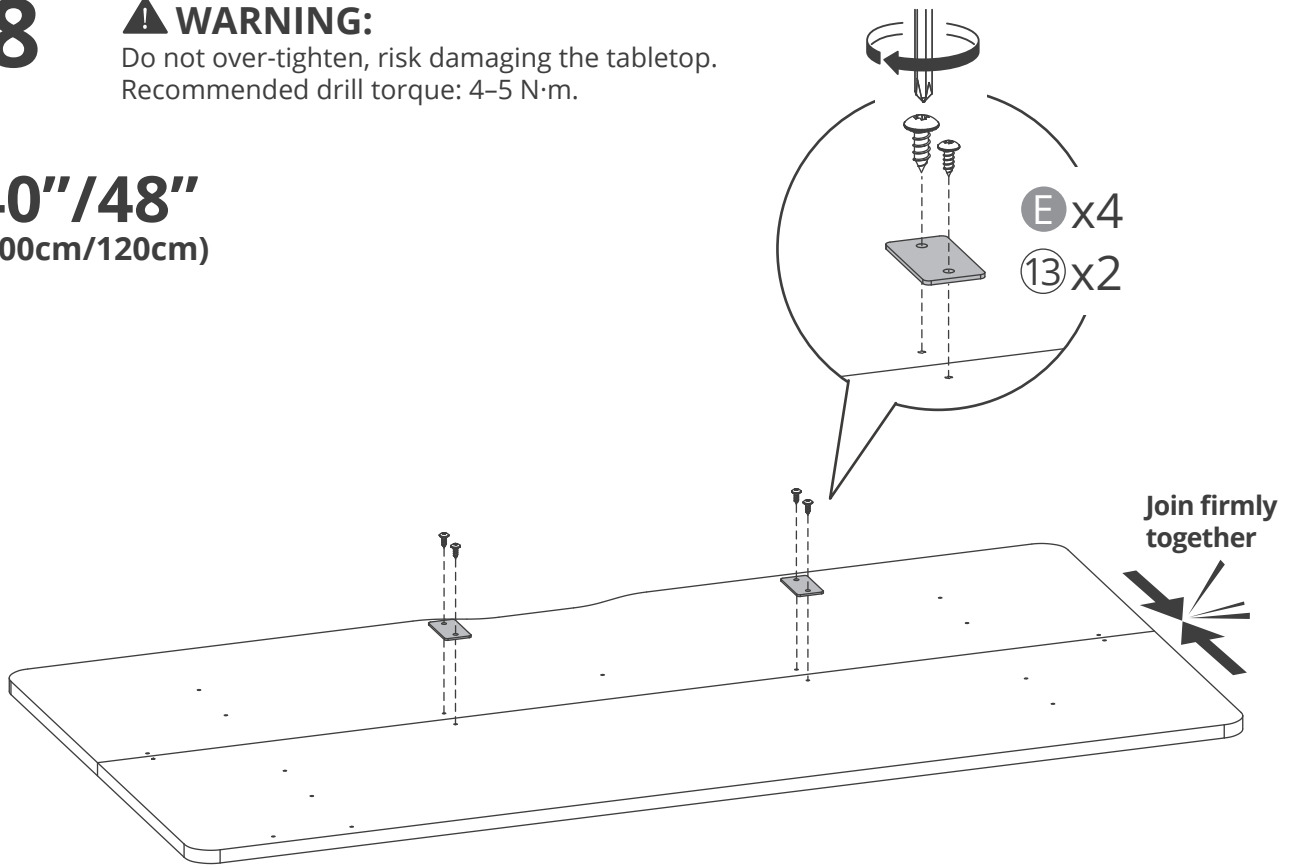

55"/63"
(140cm/160cm)

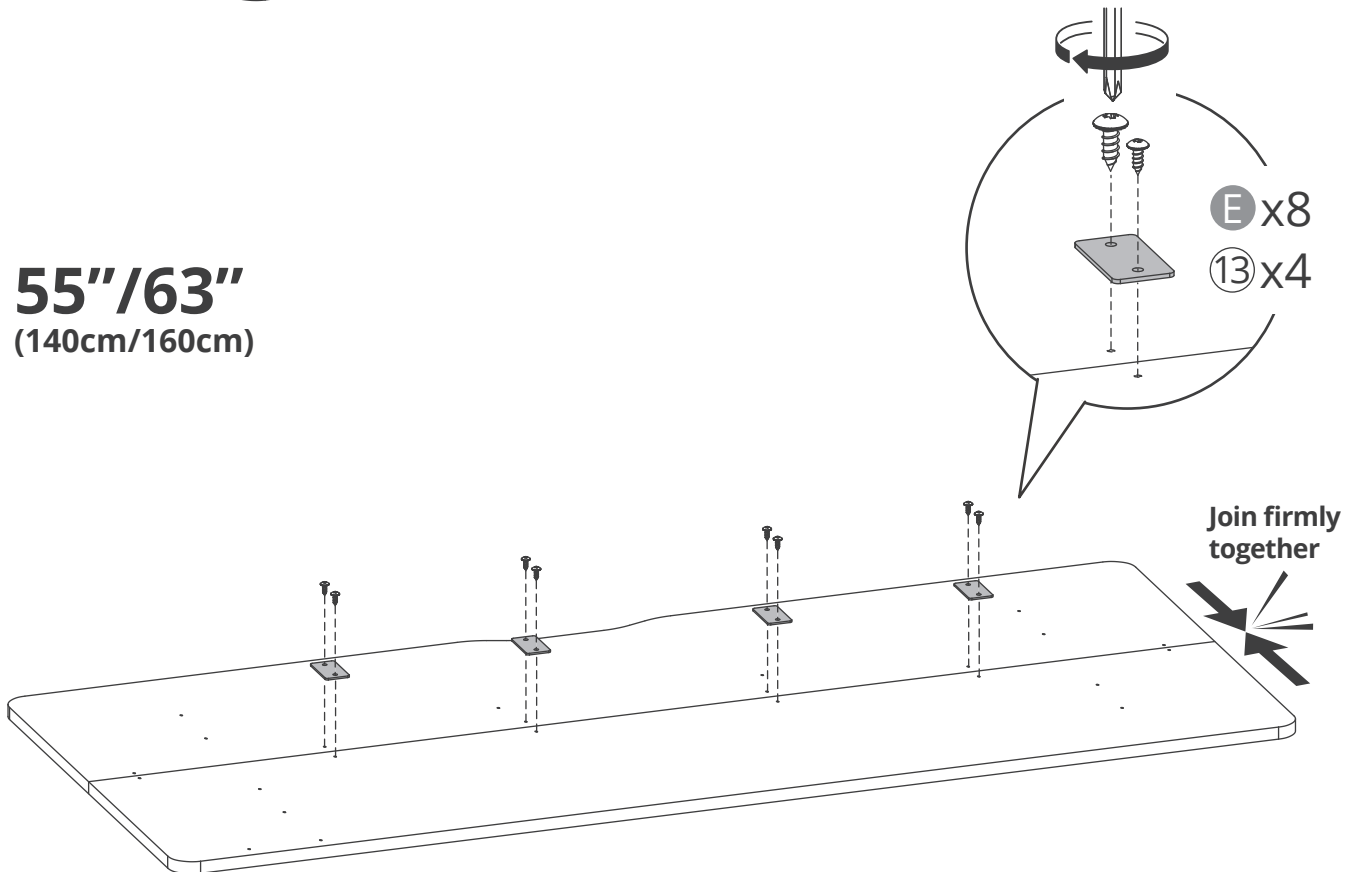

9

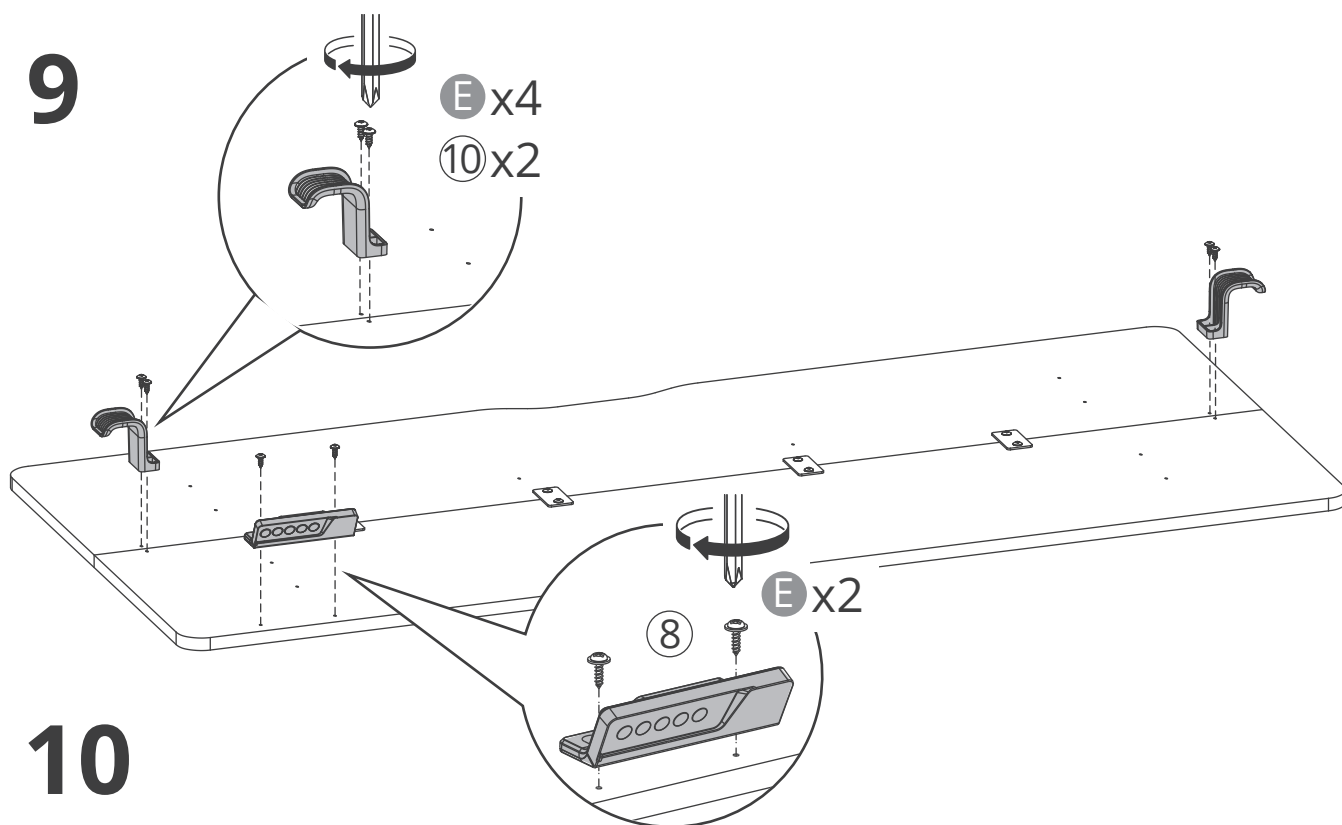

10

40"/48"
(100cm/120cm)

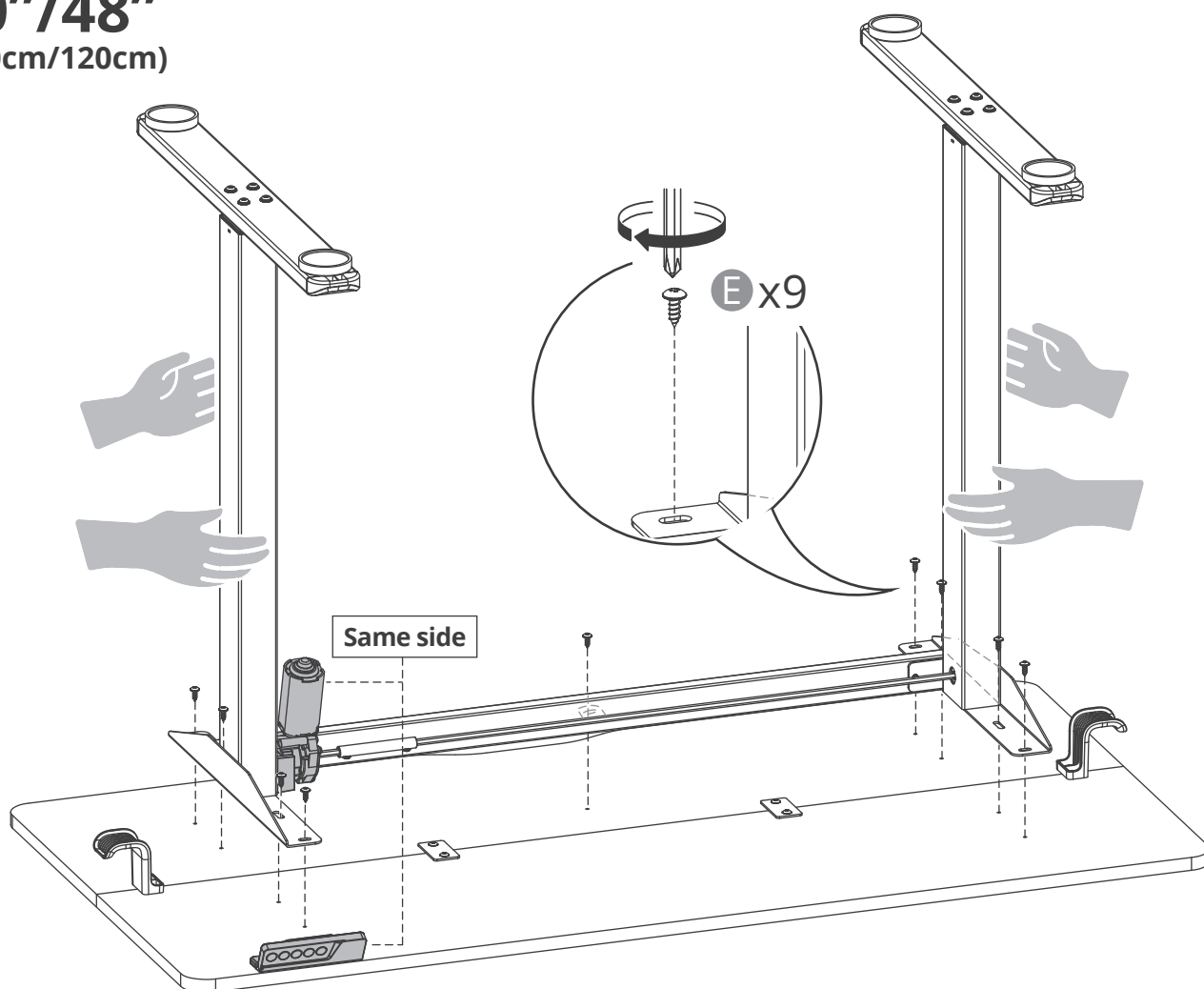

55"
(140cm)

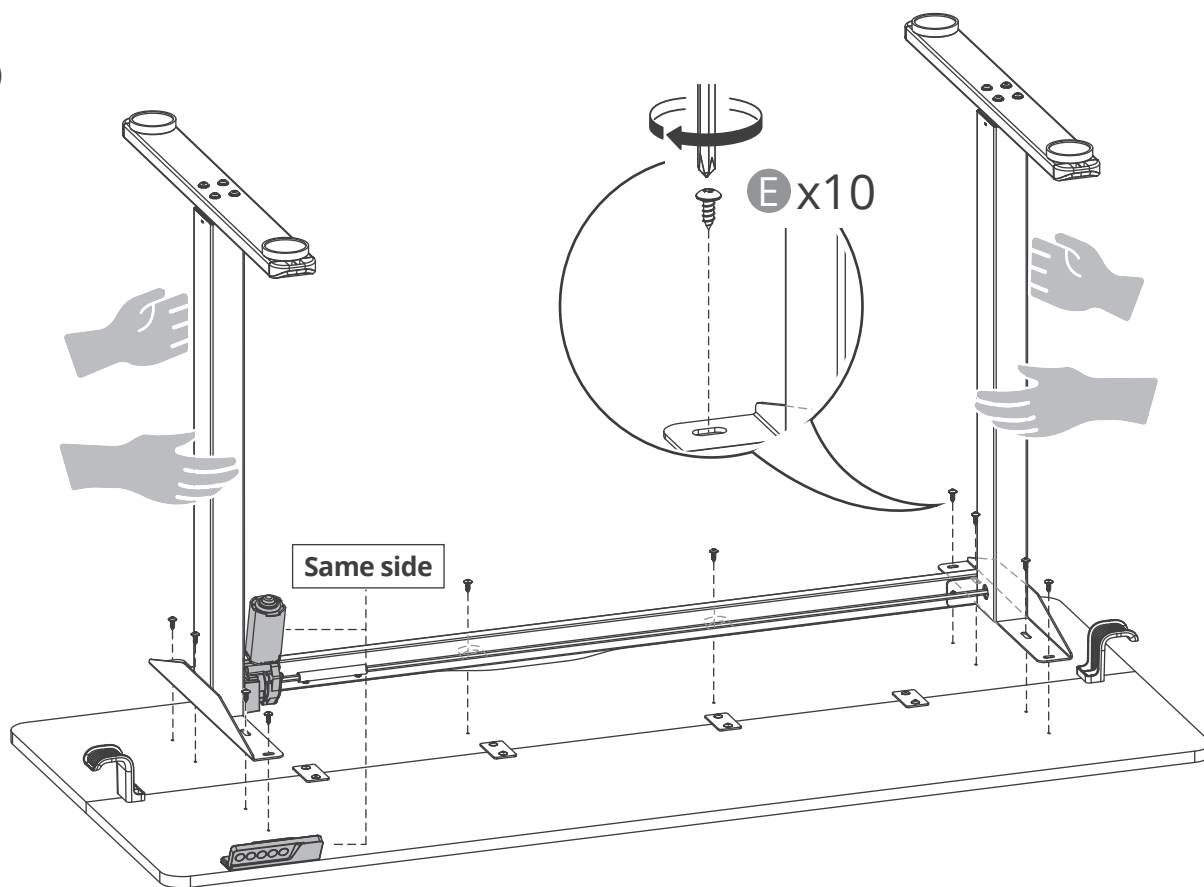

63"
(160cm)

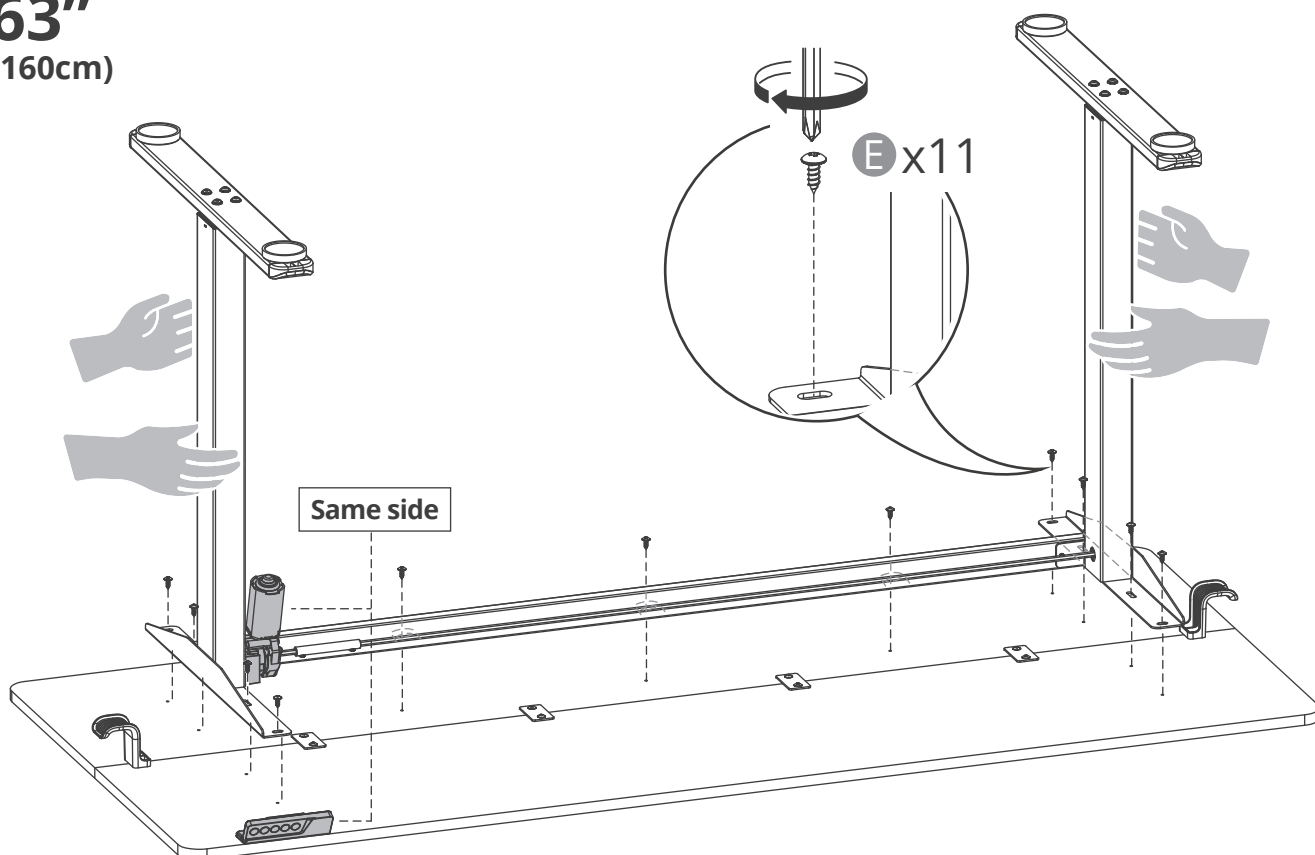

11

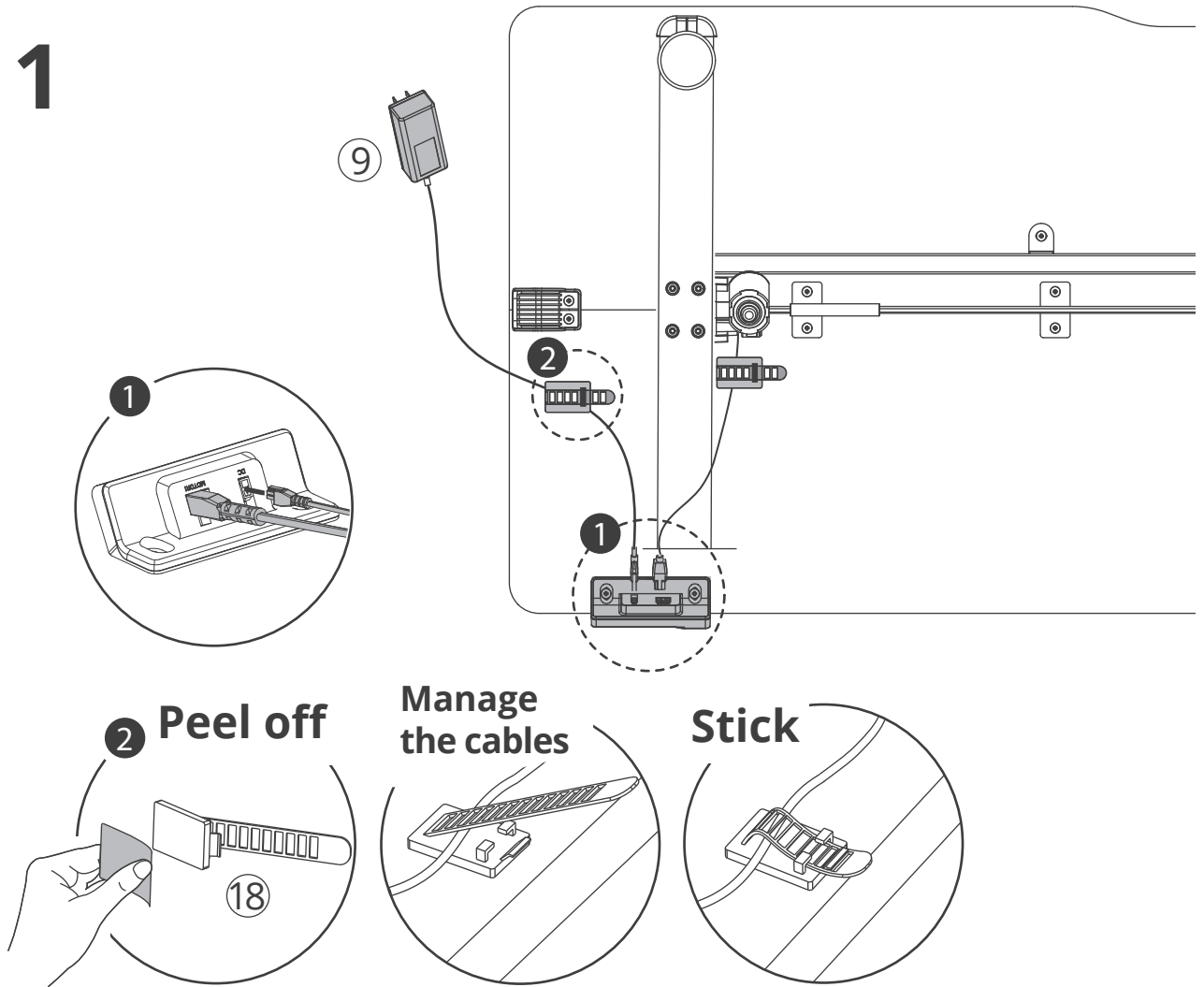

12

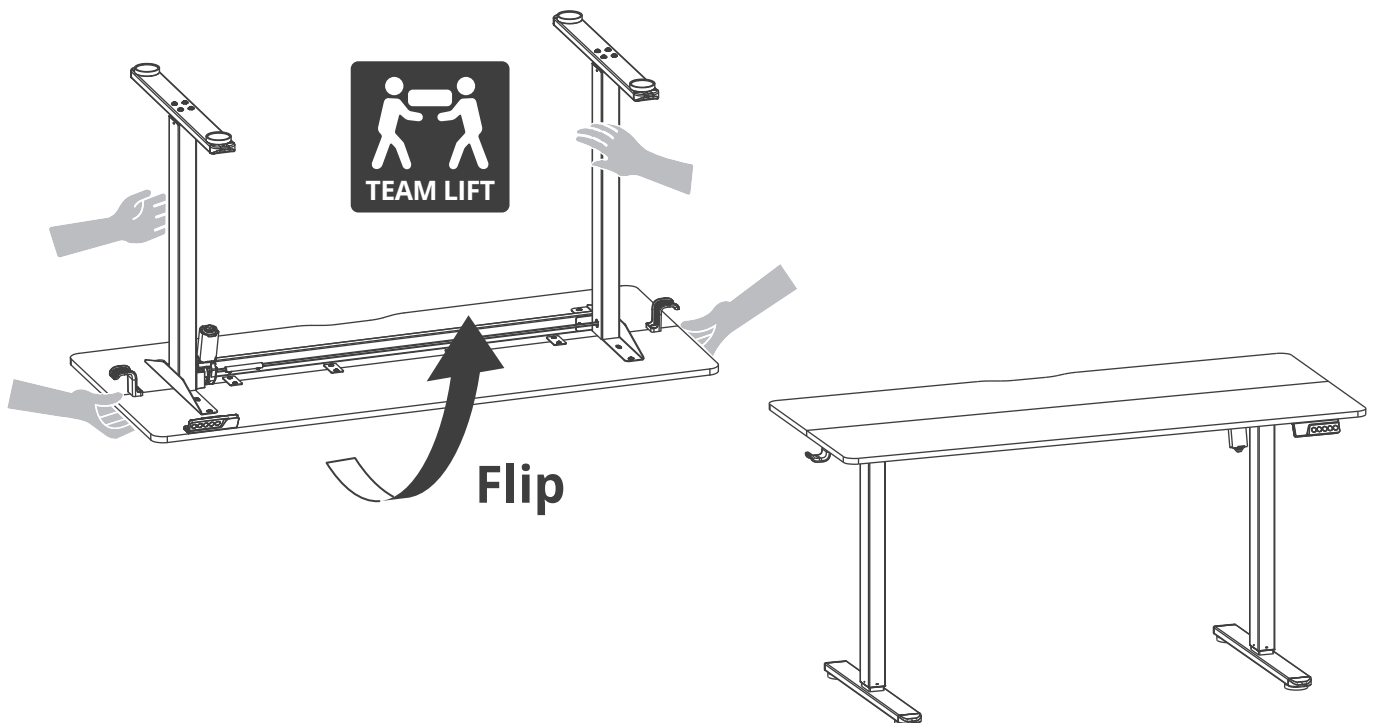

Handset User Guide

Initial Power-Up

After plugging in the desk, the handset will display the current height.

IMPORTANT: A reset procedure is required if

The height shown on the display does not match the actual height of the desk.
The desk has been disassembled and reassembled.

If the displayed height is correct and the desk has not been reassembled, it is ready for immediate use.

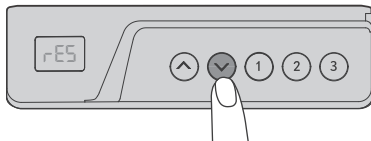

Reset Procedure

1. Press and hold the button until the desk lowers to its lowest position.
2. Once the desk has stopped moving, continue to hold the button for 5 seconds.
3. The display will show , and the desk will automatically rebound (approx. 0.5 cm / 0.2 in).
4. The reset is complete when the display returns to showing the current height. You may now release the button.

NOTE: The reset process will continue to completion even if the button is released midway through the automatic movement.

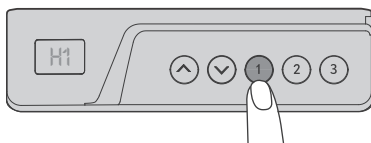

Memory Heights

You can save your favorite heights for quick access. Saved positions are retained even if the desk is unplugged.

To Save a Memory Position:

1. Use the or buttons to adjust the desk to your desired height.
2. Press and hold , , or for 3 seconds.
3. The display will show , , or for 2 seconds to confirm that the position has been saved.

To Recall a Memory Position:

1. Briefly press the desired memory button , , or .
2. The desk will automatically move to the saved height.
3. To stop the desk during movement, press any button.

NOTE: For a 3-button handset, the factory default presets are:

- Button : Lowest height
- Button : 860 mm (33.9 in)
- Button : Highest height

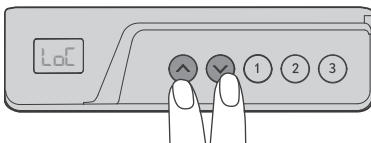

Child Lock

To Lock the Handset:

Press and hold the and buttons simultaneously for 3 seconds. The display will show to confirm the handset is locked. Height adjustment will be disabled.

To Unlock the Handset:

While locked, press and hold the and buttons simultaneously for 3 seconds. The display will change from back to the current height, indicating the handset is unlocked.

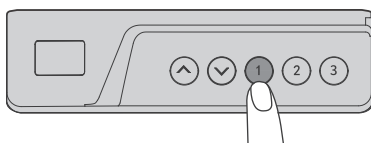

Wake the Handset

When the display is off, a single, short press of , , or will wake the handset and immediately move the desk to that preset height. A second press is not needed.

Power-Saving Mode

If no buttons are pressed for 30 seconds, the desk will enter power-saving mode to conserve energy. The handset display will turn off, and the control box will enter a low-power state.

To wake the desk and exit power-saving mode, press any button.

Codes	Description	Solution
E31	Low Voltage Error: The input voltage from the power supply is below 20V.	Replace the main power supply unit.
E32	High Voltage Error: The input voltage from the power supply is above 36V.	Replace the main power supply unit.
E02	Anti-Collision Activated: The desk has detected an obstacle while moving and has automatically reversed slightly.	Remove the obstacle from the desk's path and try again.
Hot	Overheat Protection: The motor has been used too frequently or continuously and needs to cool down. This is a normal safety feature.	Wait for approximately 15 minutes. The error will clear automatically once the motor has cooled. Alternatively, you can unplug the desk and plug it back in.
E10	Motor Connection Error: A motor cable is not securely connected to the control box.	Check that all motor cables are firmly plugged into the correct ports on the control box.
E20	Overload Error: The weight on the desk surface exceeds the maximum capacity (140 kg / 308 lbs).	Reduce the weight on the desk to bring it below the maximum load limit.