

ASSEMBLY INSTRUCTIONS

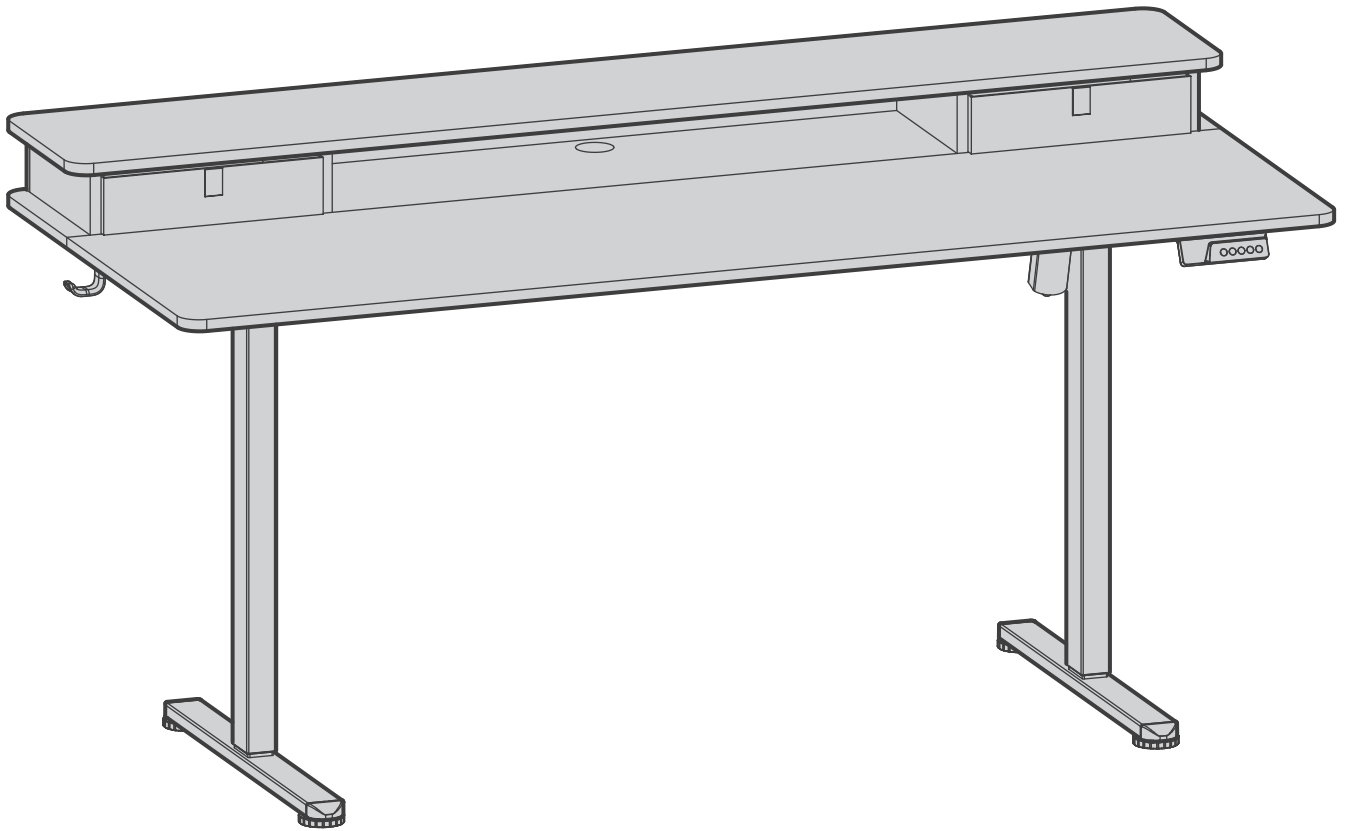

For assembly assistance,
✉ support@yfs.life 🌐 yfs.life/sde0017-jz1

▶ Scan QR code for
installation video





Caution

- Keep children and animals away from the desk during use. Ensure the desktop is not touching any walls.
- Remove obstacles taller than 20"/51cm from underneath the desk.
- Operate only in a working environment temperature of 32°F-104°F/0°C-40°C.
- Keep product away from corrosive gases, liquids and dusty objects.
- Keep hands, feet and other body parts in a safe position during operation. Anti-collision is not automatically enabled during all resets.
- The company does not bear any warranty or liability for damage and human injury caused by any abnormal or un-intended operation of the equipment.
- It is necessary to perform a manual reset after the initial installation or power cycling the equipment.

Assembly Guide



Scan the QR code for installation videos and detailed user instructions.

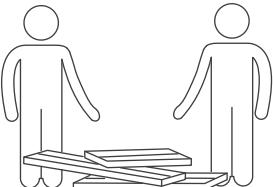
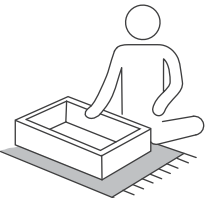
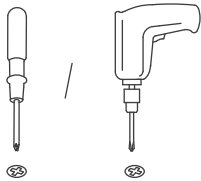
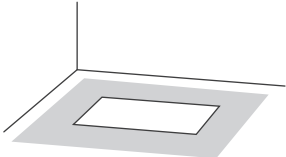

 <p>Complete through collaboration.</p>	 <p>Assemble on a clean, flat , and protective surface.</p>	 <p>Phillips screwdriver or drill required (not provided).</p>	 <p>Allow an assembly area at least twice the desktop size.</p>
--	--	--	--

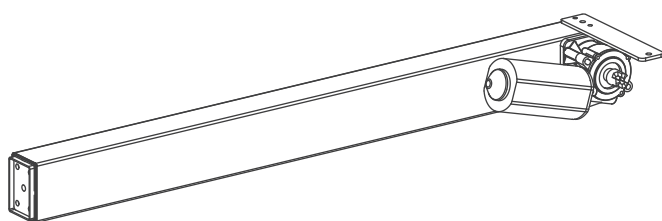

① x1

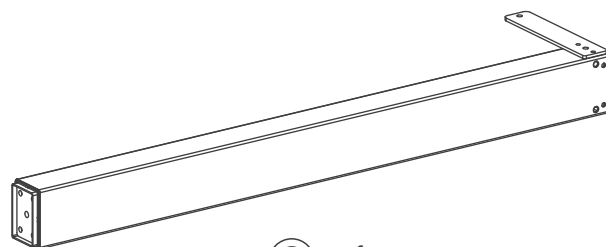

② x1

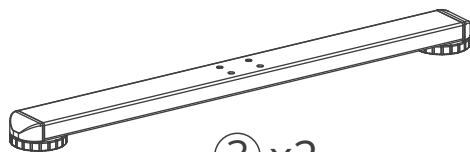

③ x2

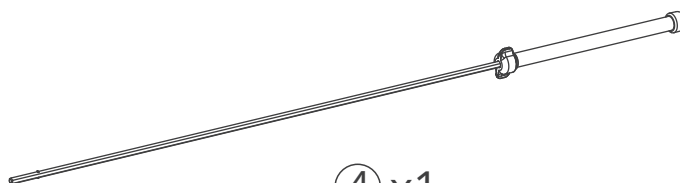

④ x1

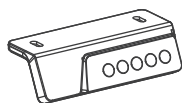

⑤ x1

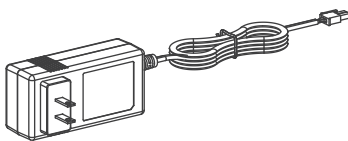

⑥ x1

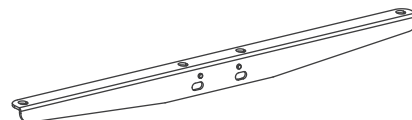

⑦ x2

(40"/48"/55"X24" : 412mm)
(63"X28" : 496mm)

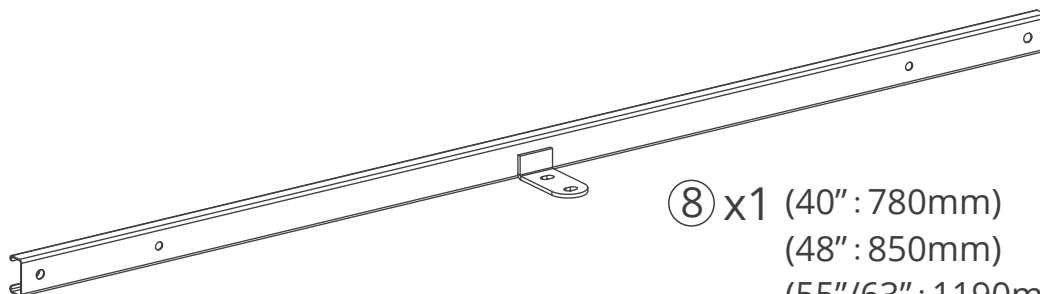

⑧ x1 (40" : 780mm)
(48" : 850mm)
(55"/63" : 1190mm)

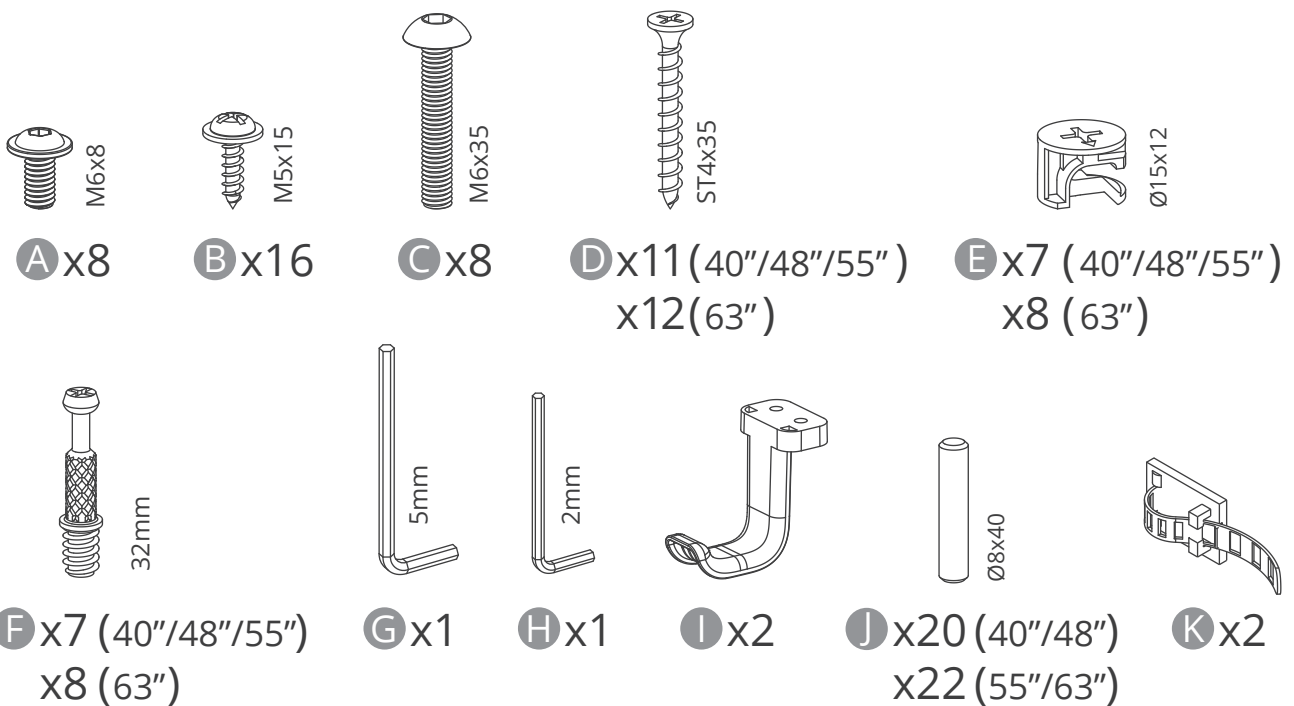
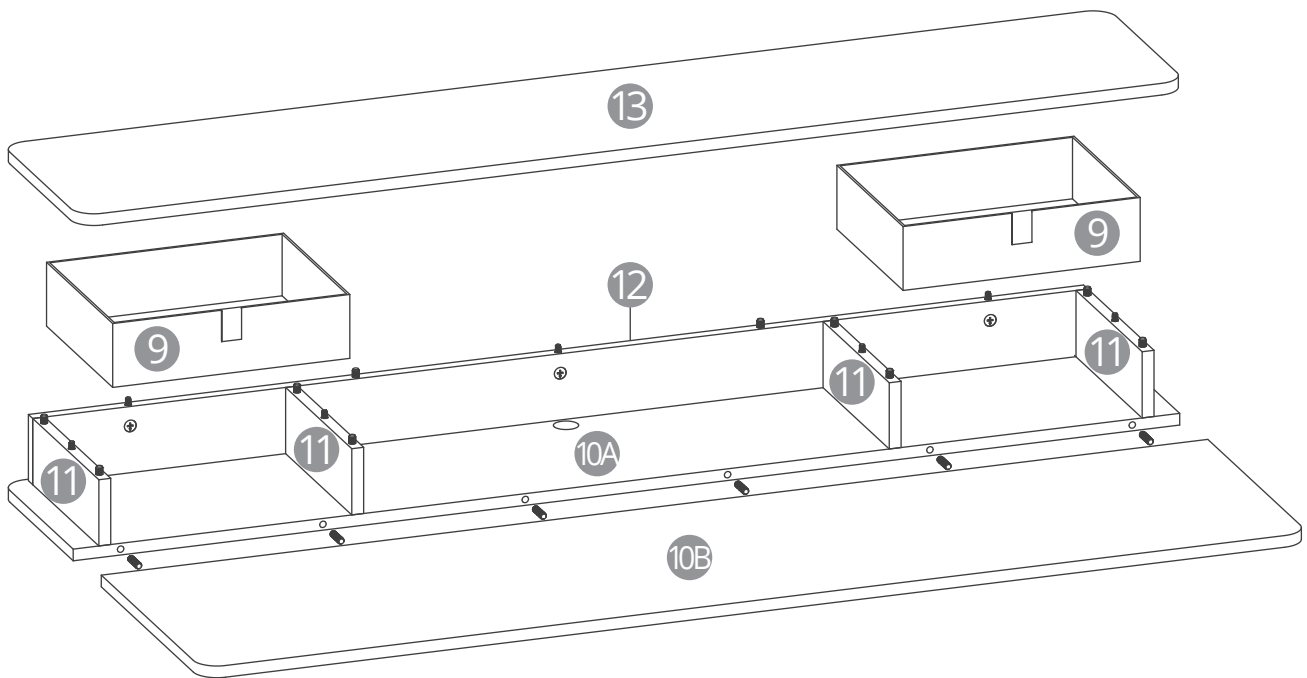

PART A

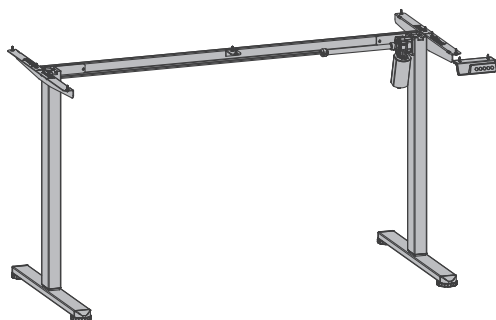

Page 4 - 6

PART B

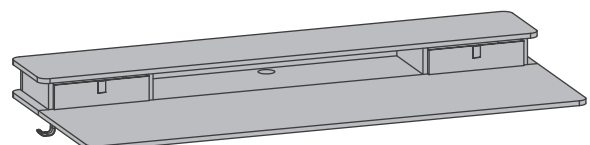

Page 7-15

1

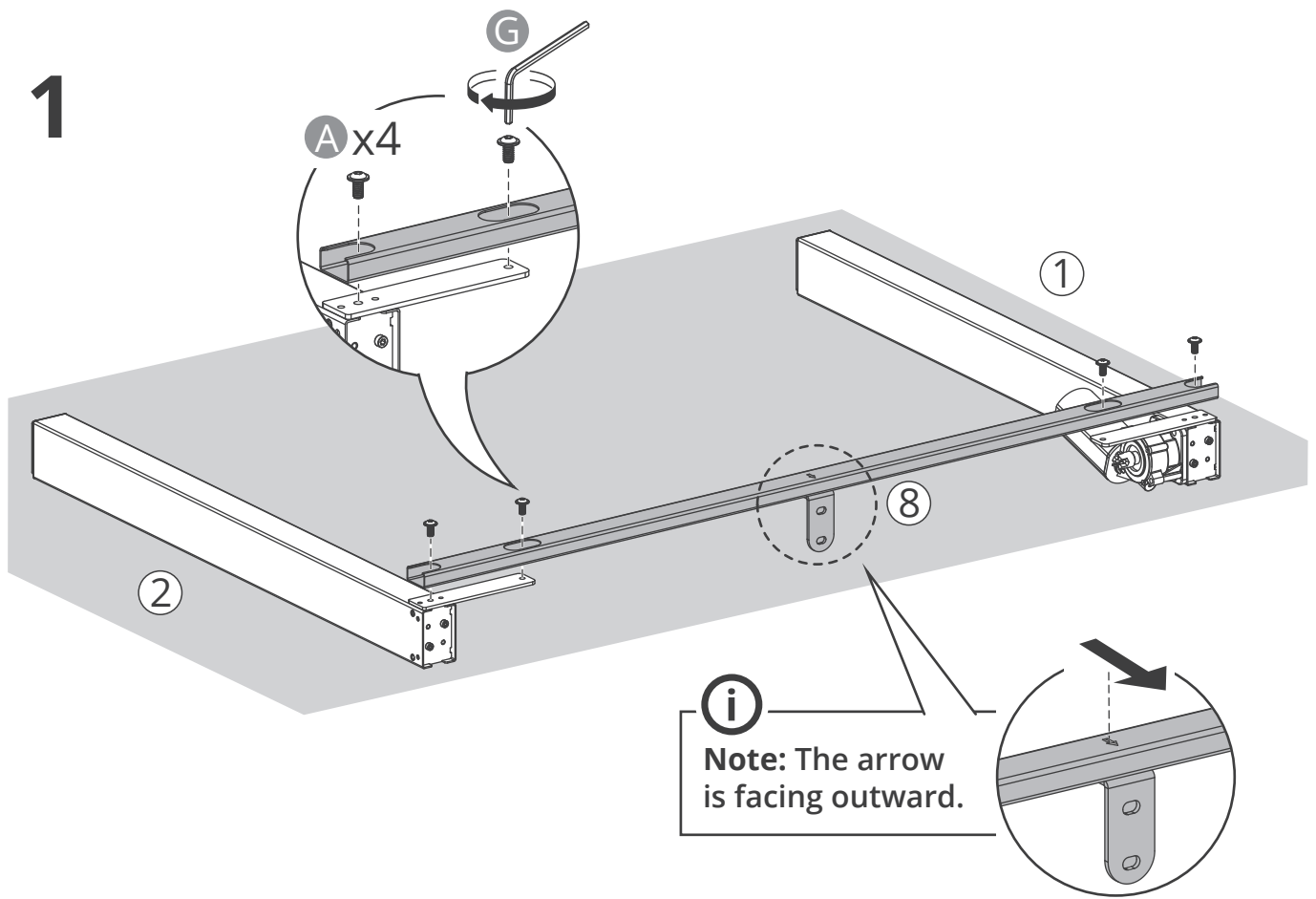

2

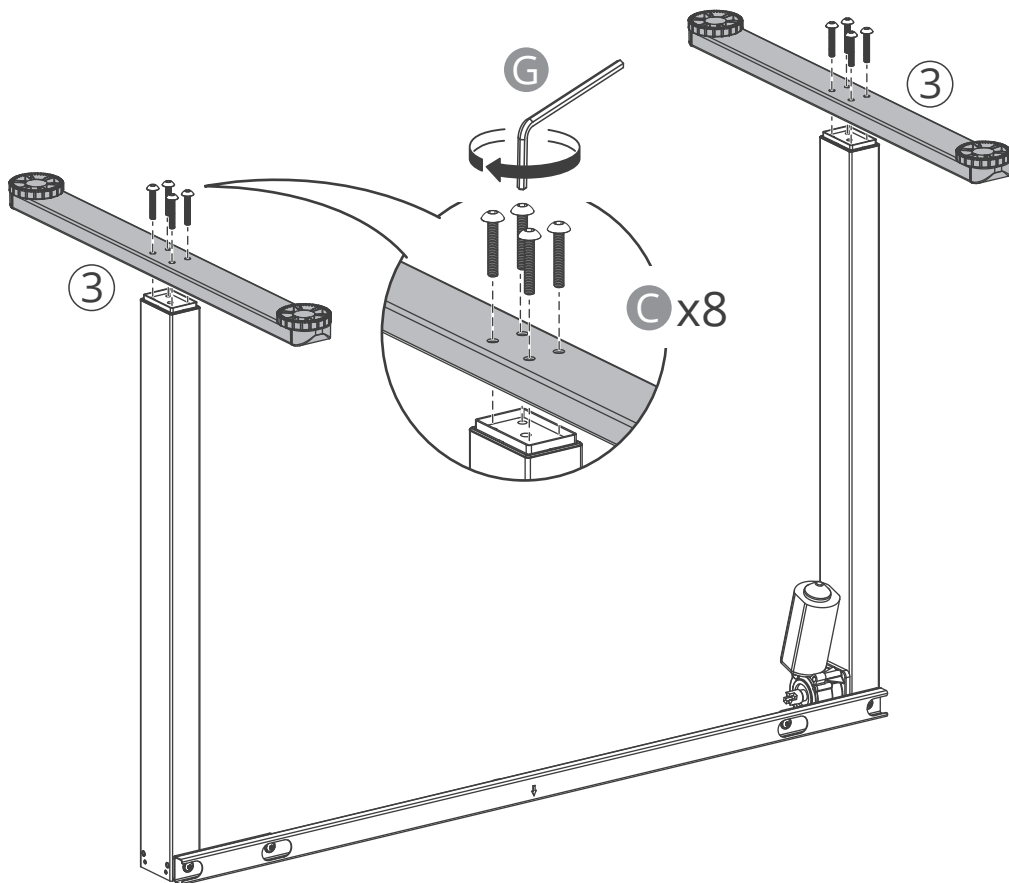

3

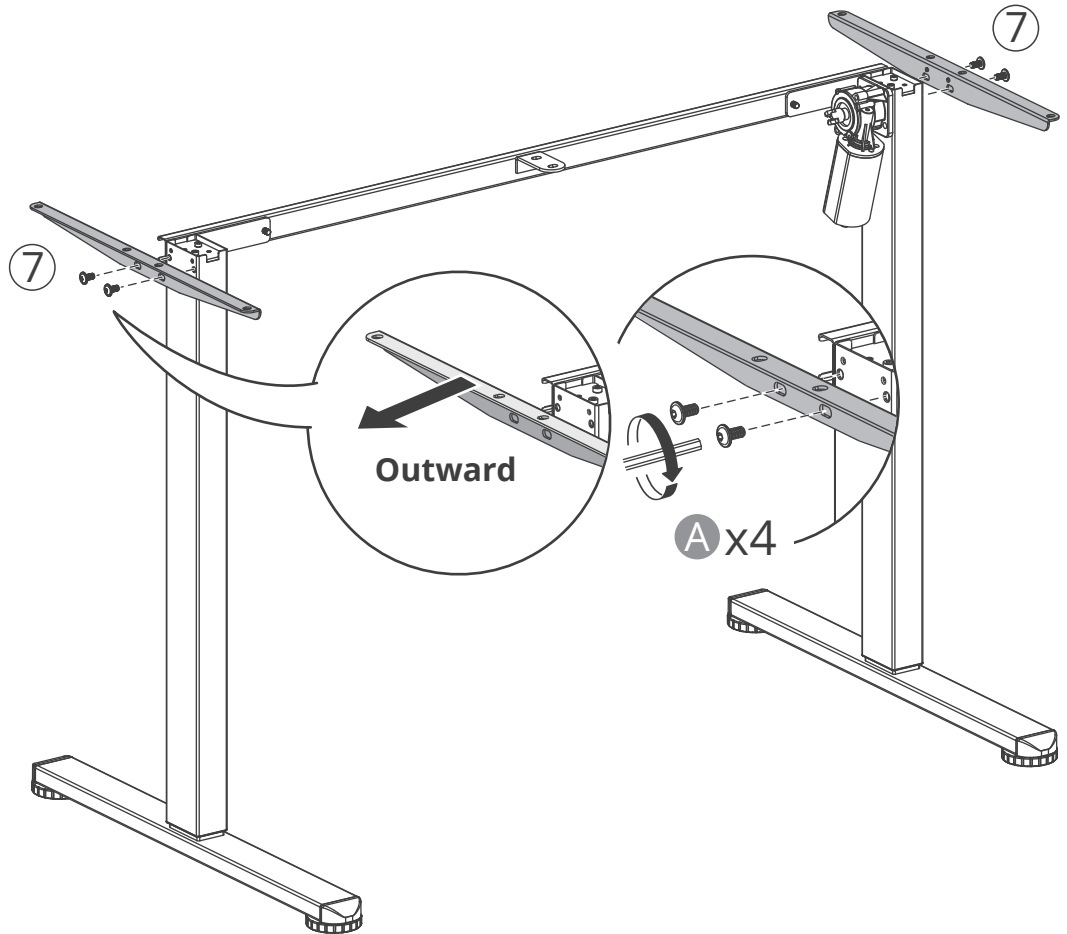

4

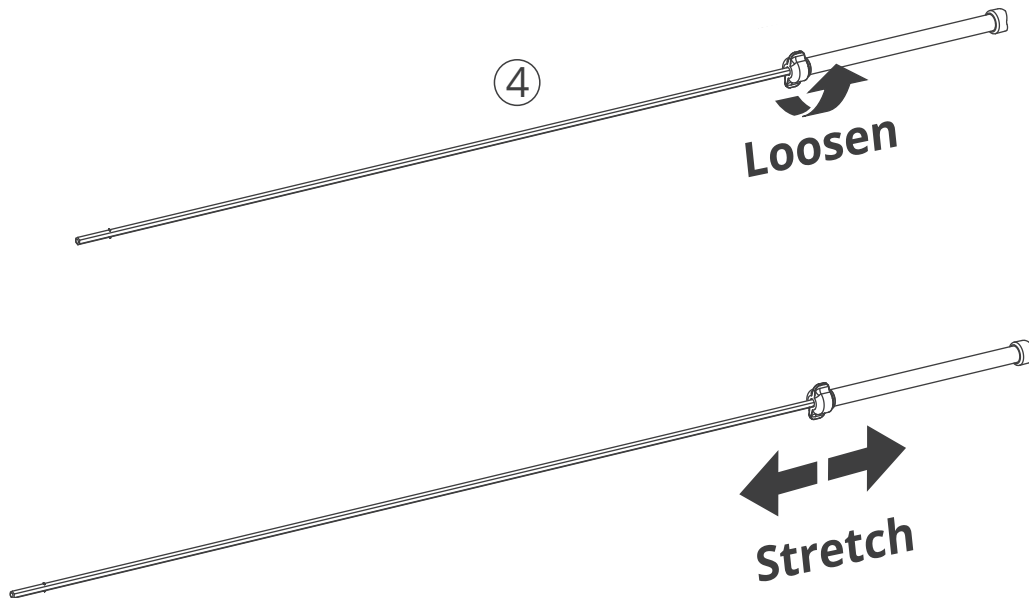

5

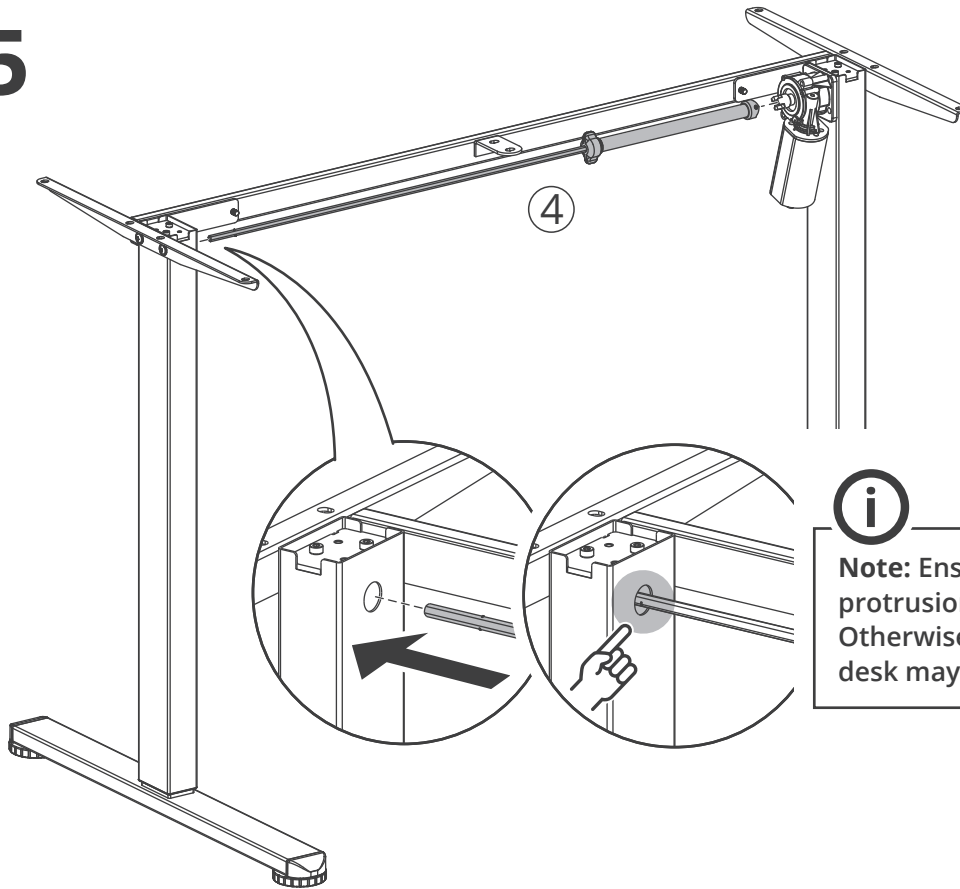

Note: Ensure the sync rod's protrusion is fully engaged. Otherwise, the left column of the desk may not adjust properly.

6

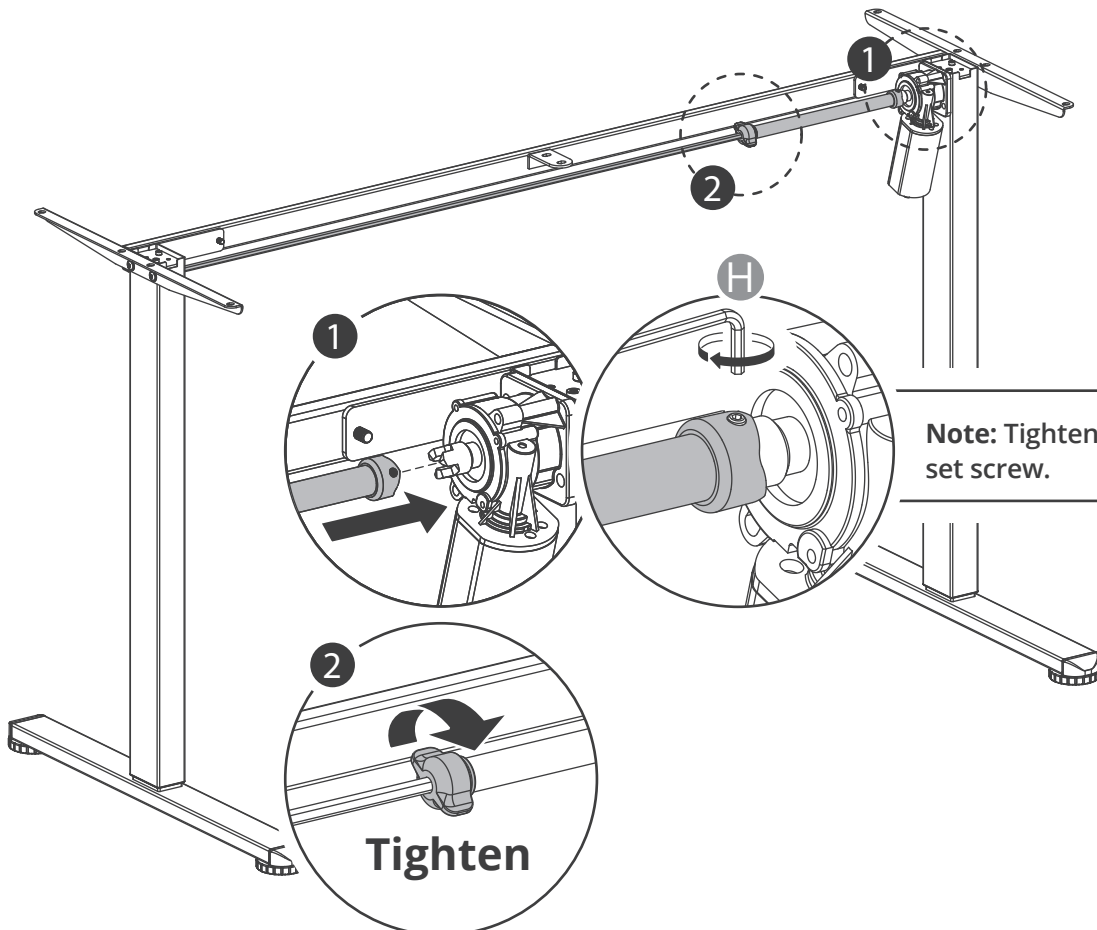

Note: Tighten the set screw.

40" / 48" / 55"
(100cm/120cm/140cm)

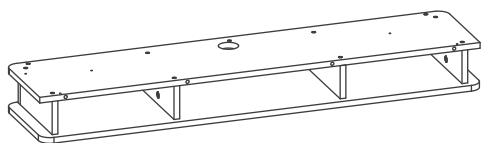

Page 7 - 10

63"
(160cm)

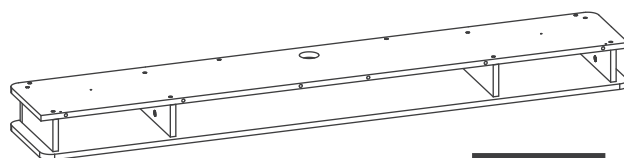

11-14

7

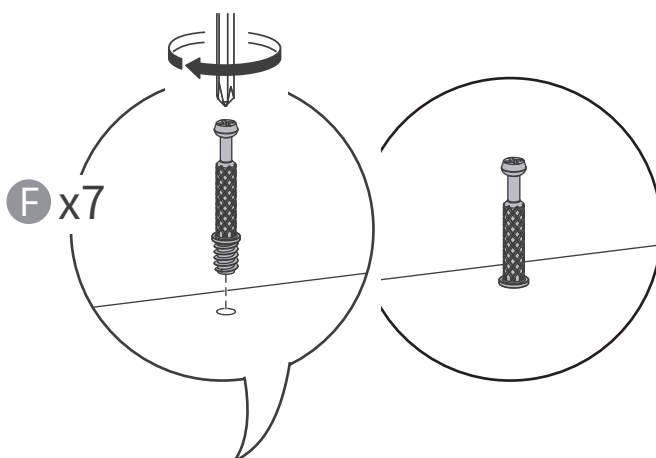

13

8

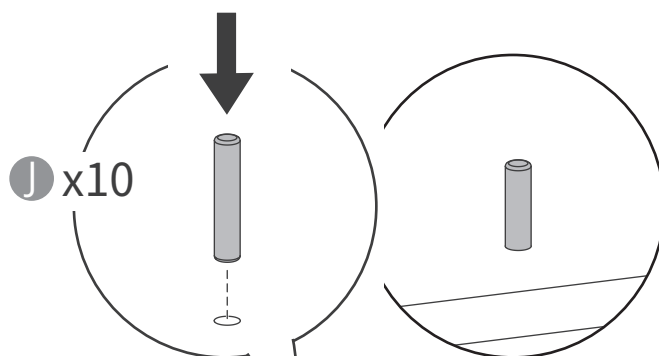

9

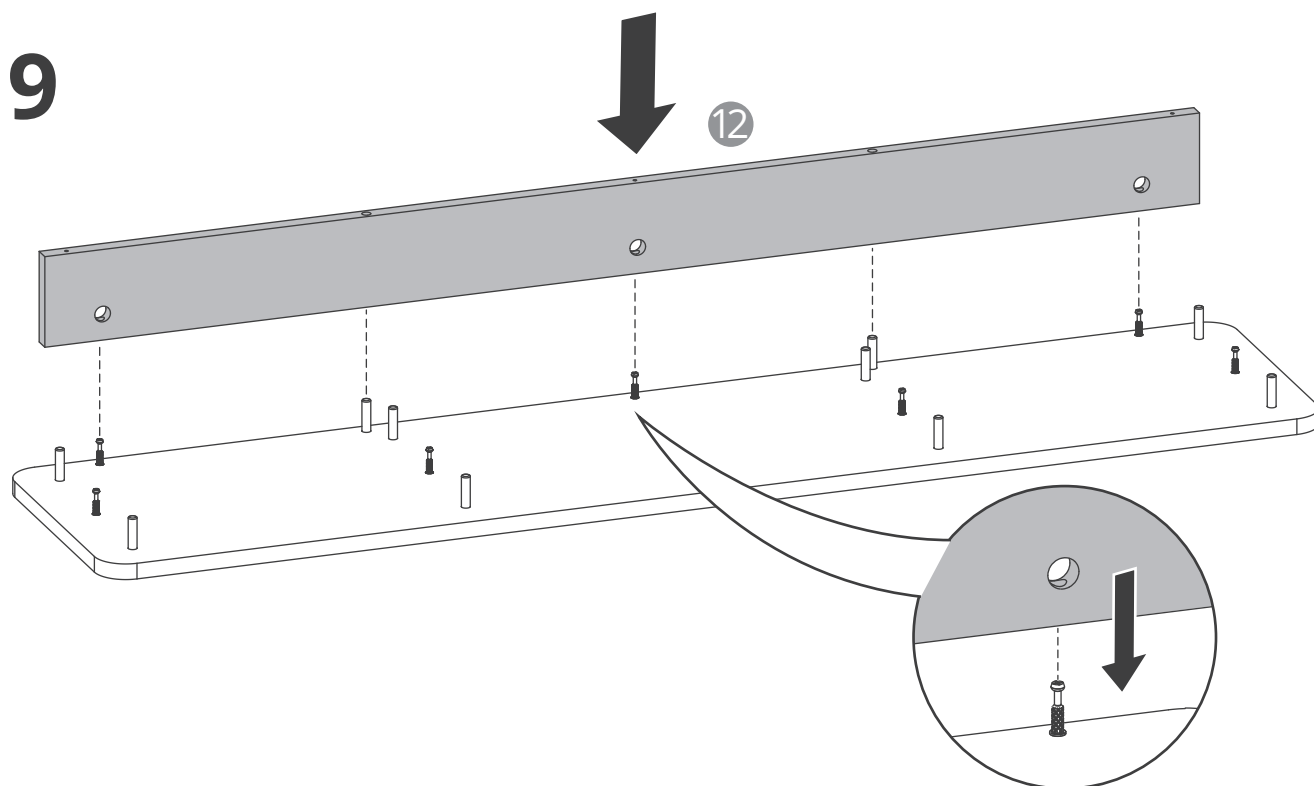

10

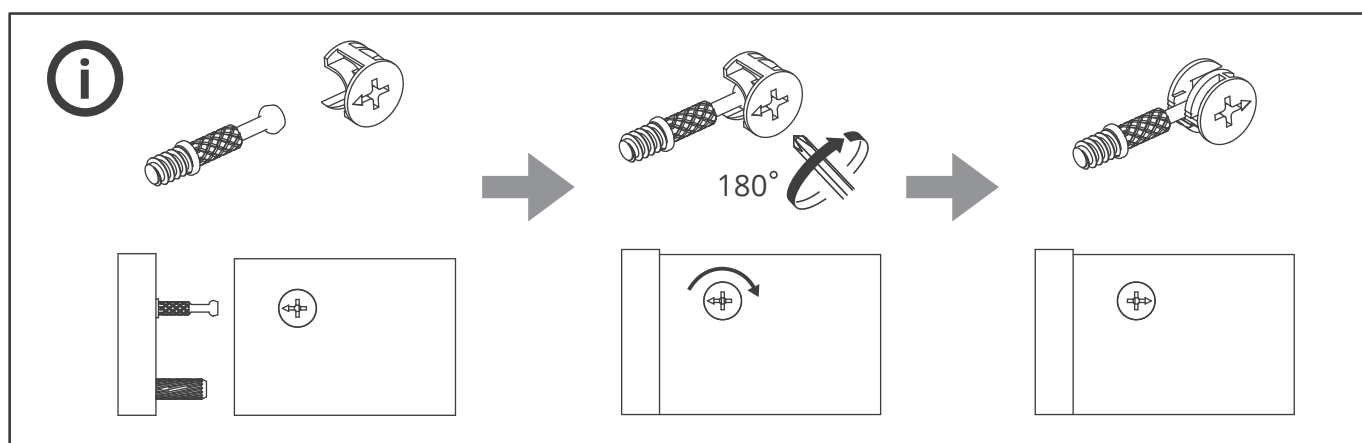
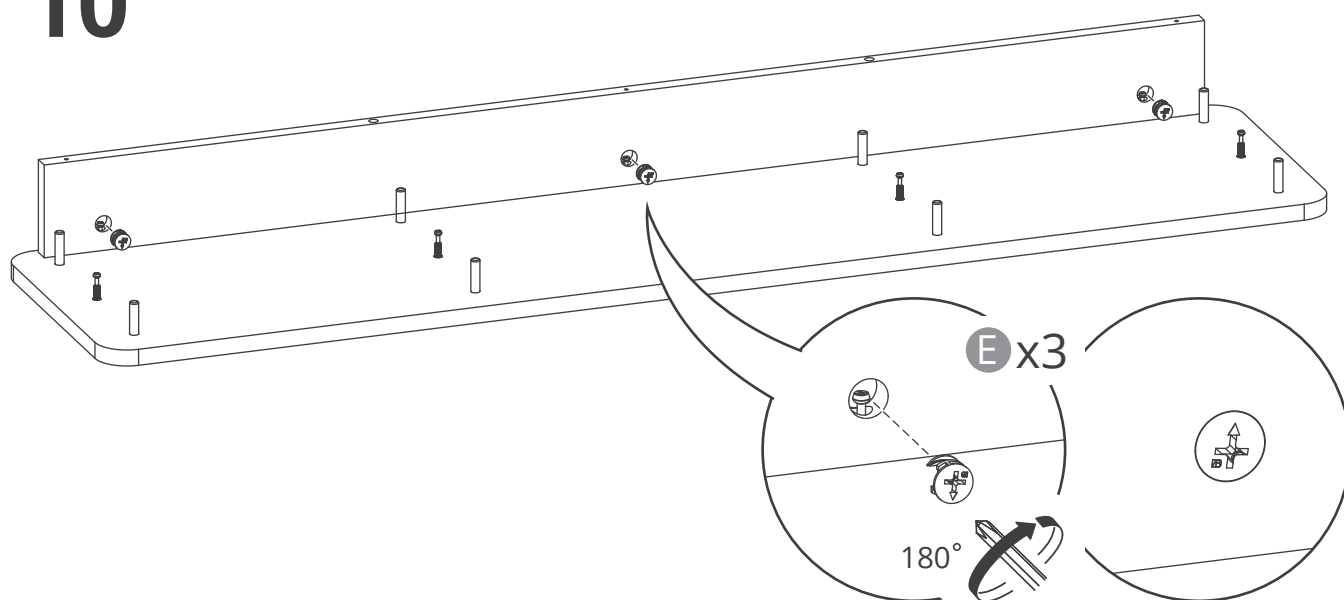

11

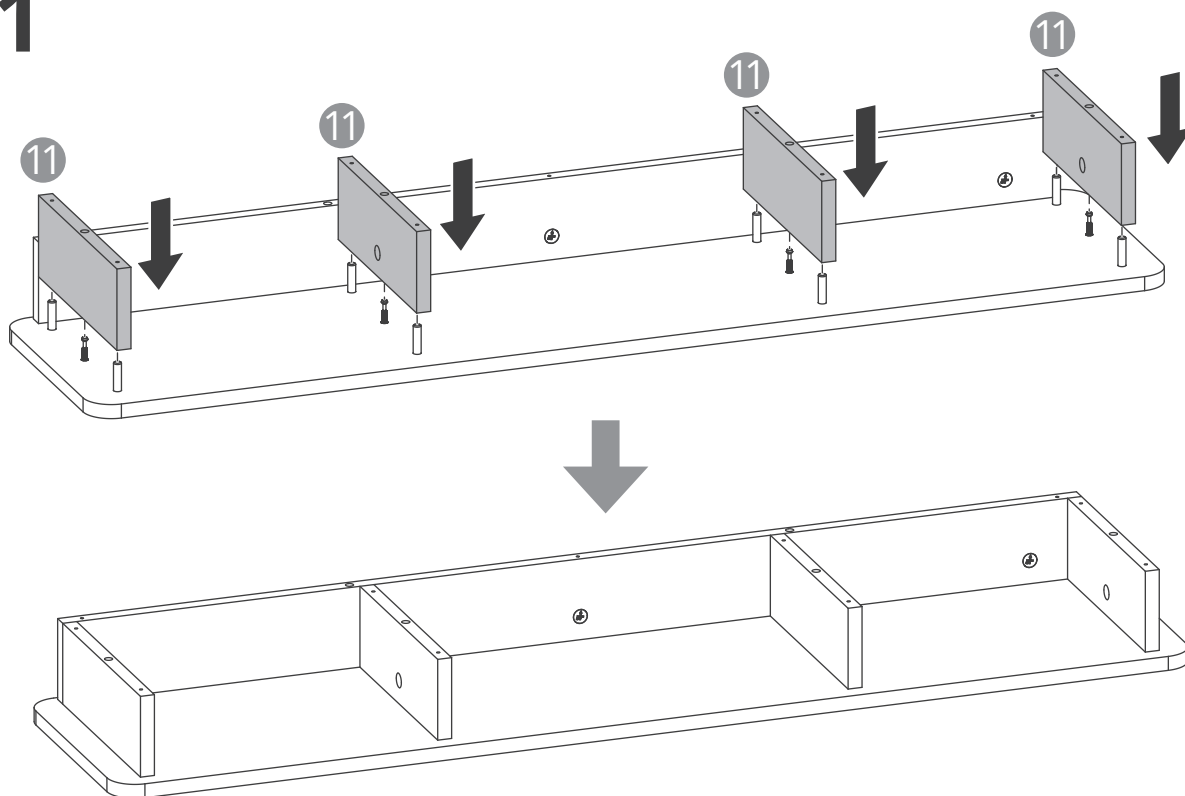

12

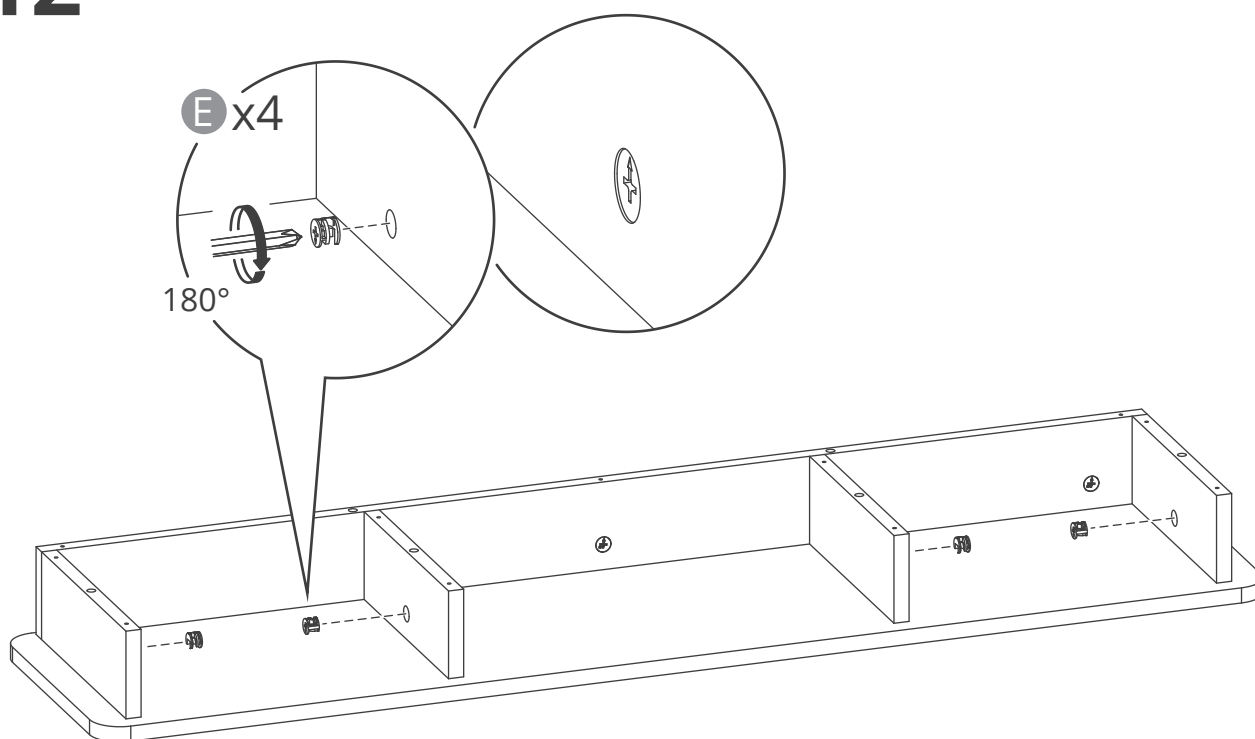

13

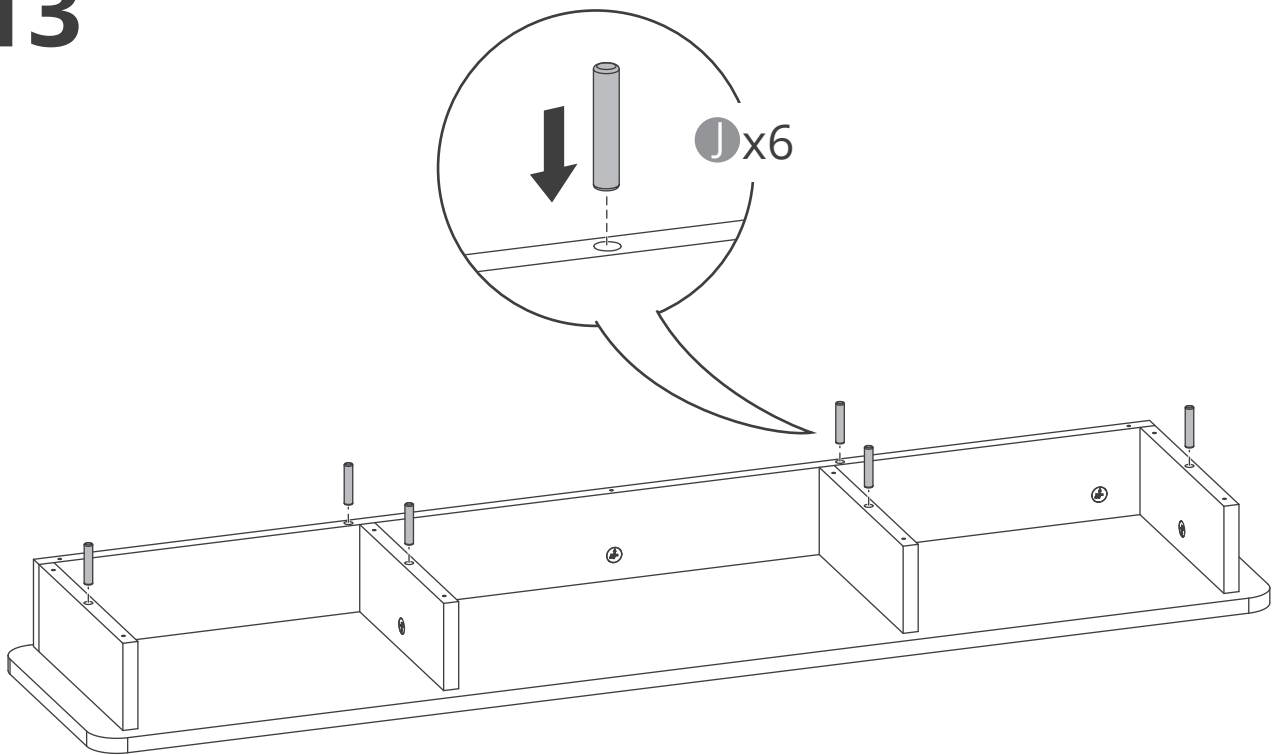

14

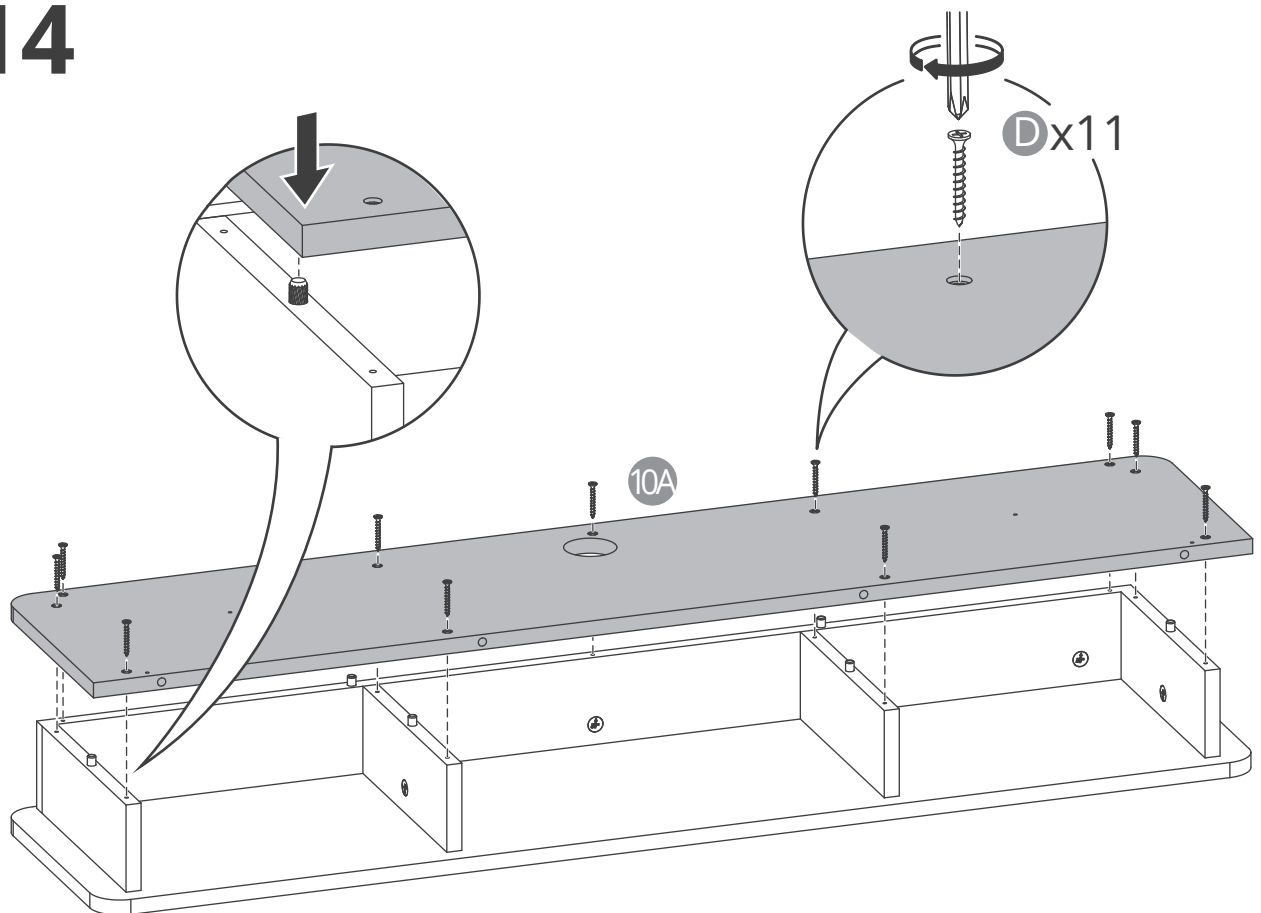

63"

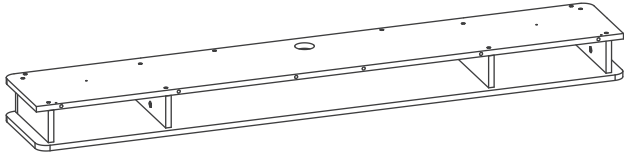

Page 11 - 14



7

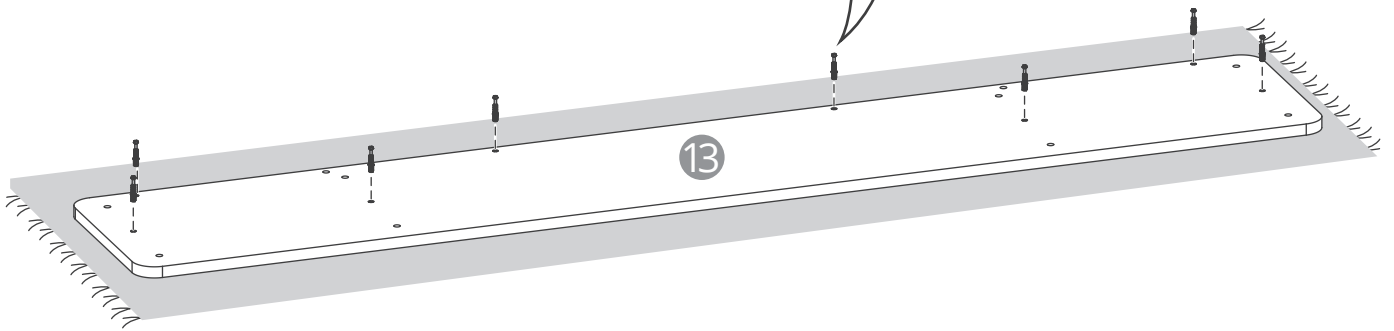
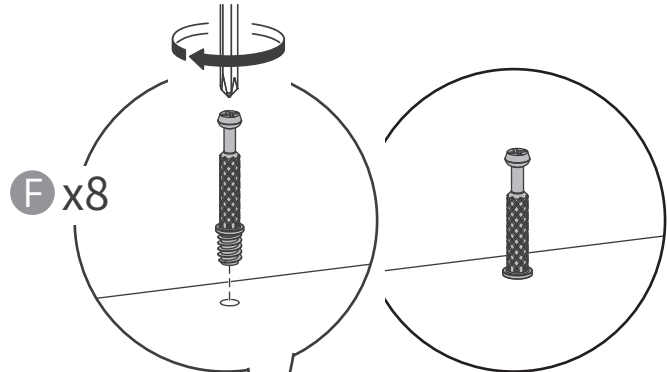

8

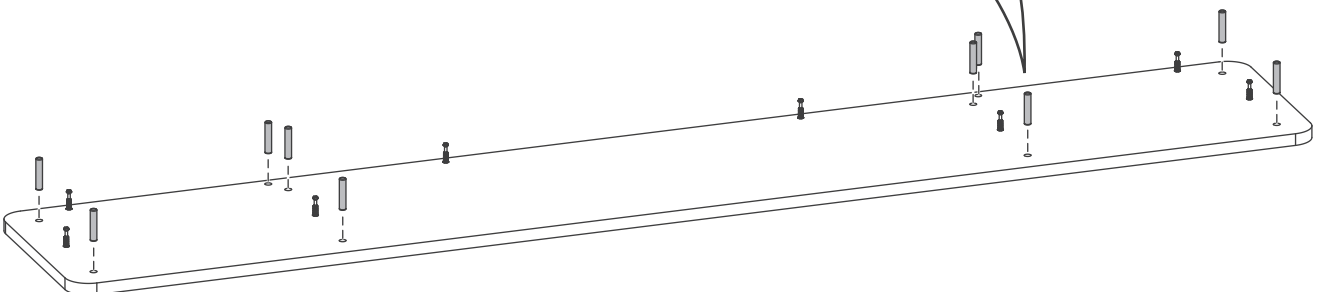
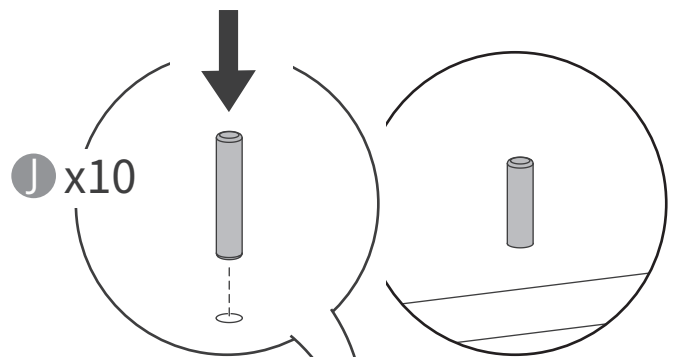

9

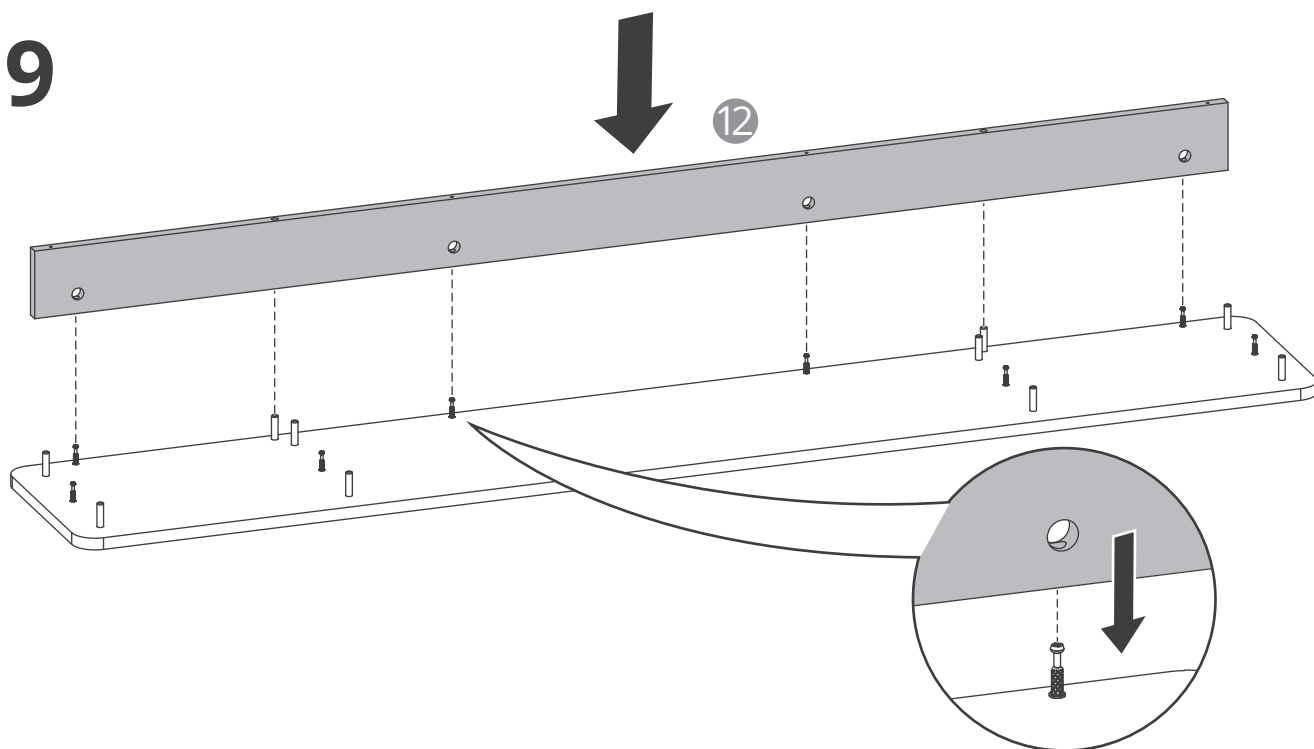

10

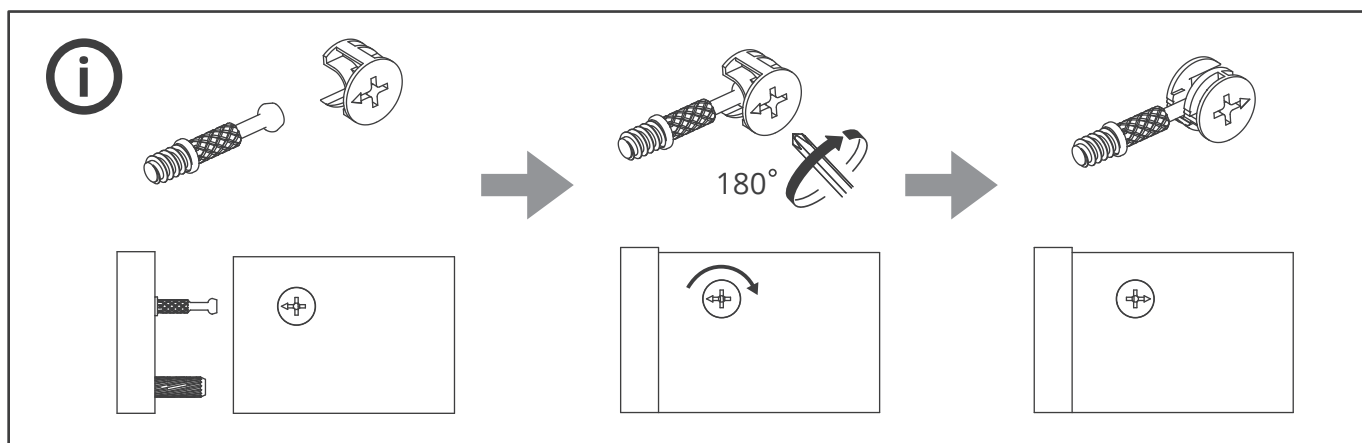
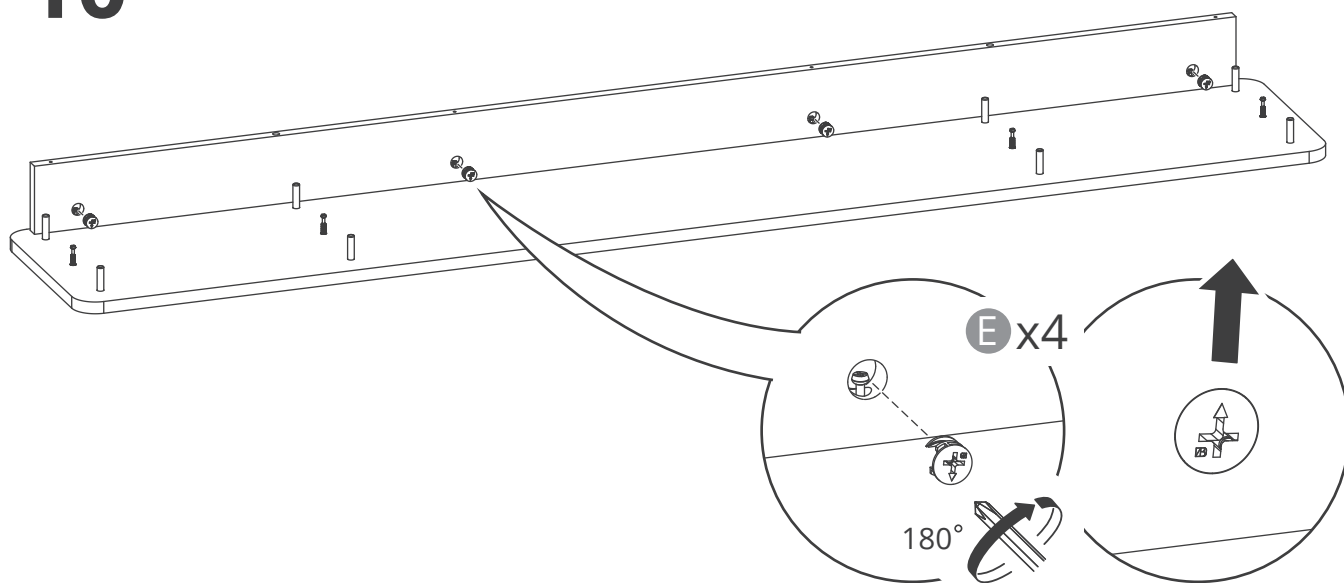

11

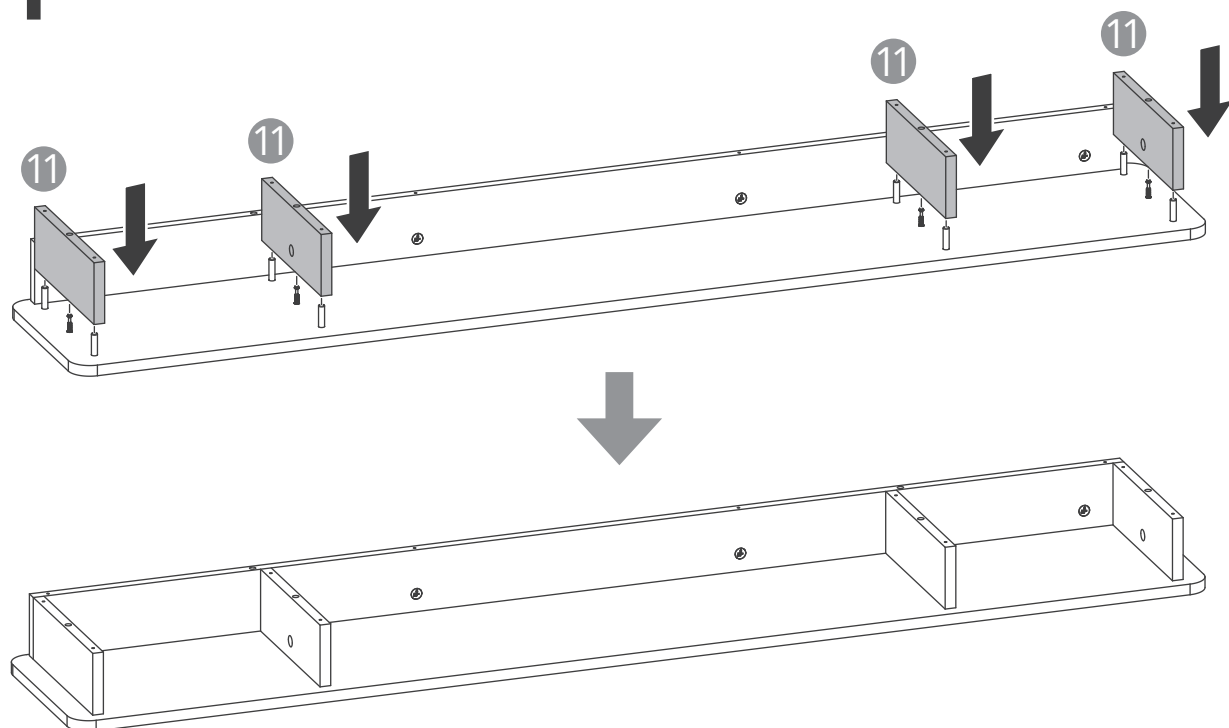

12

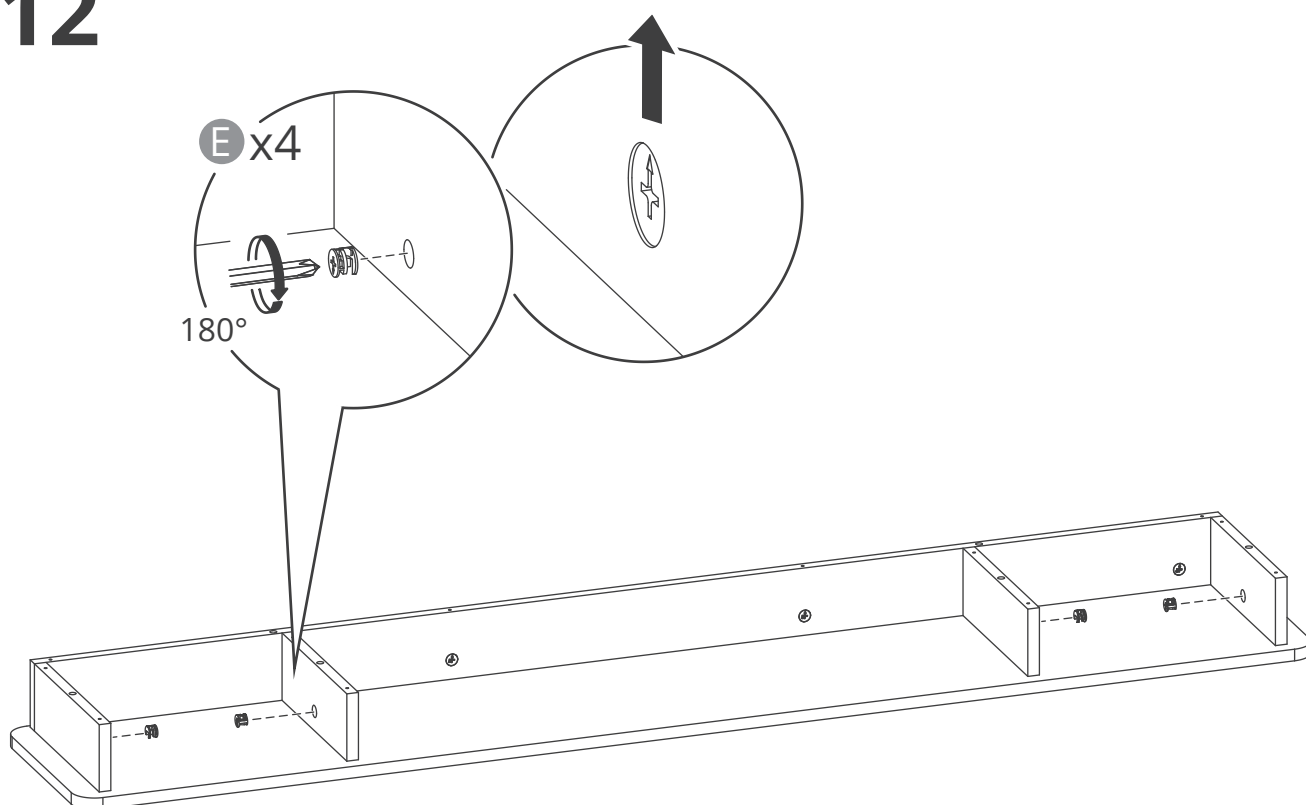

13

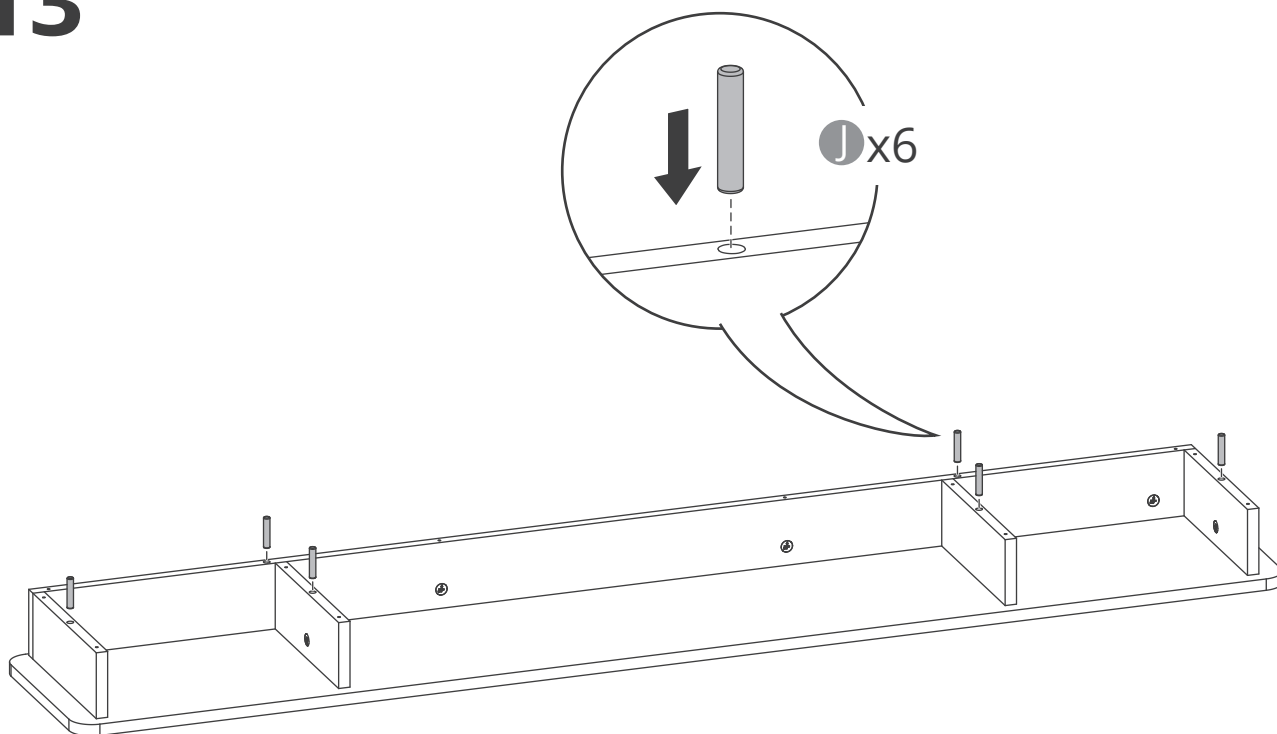

14

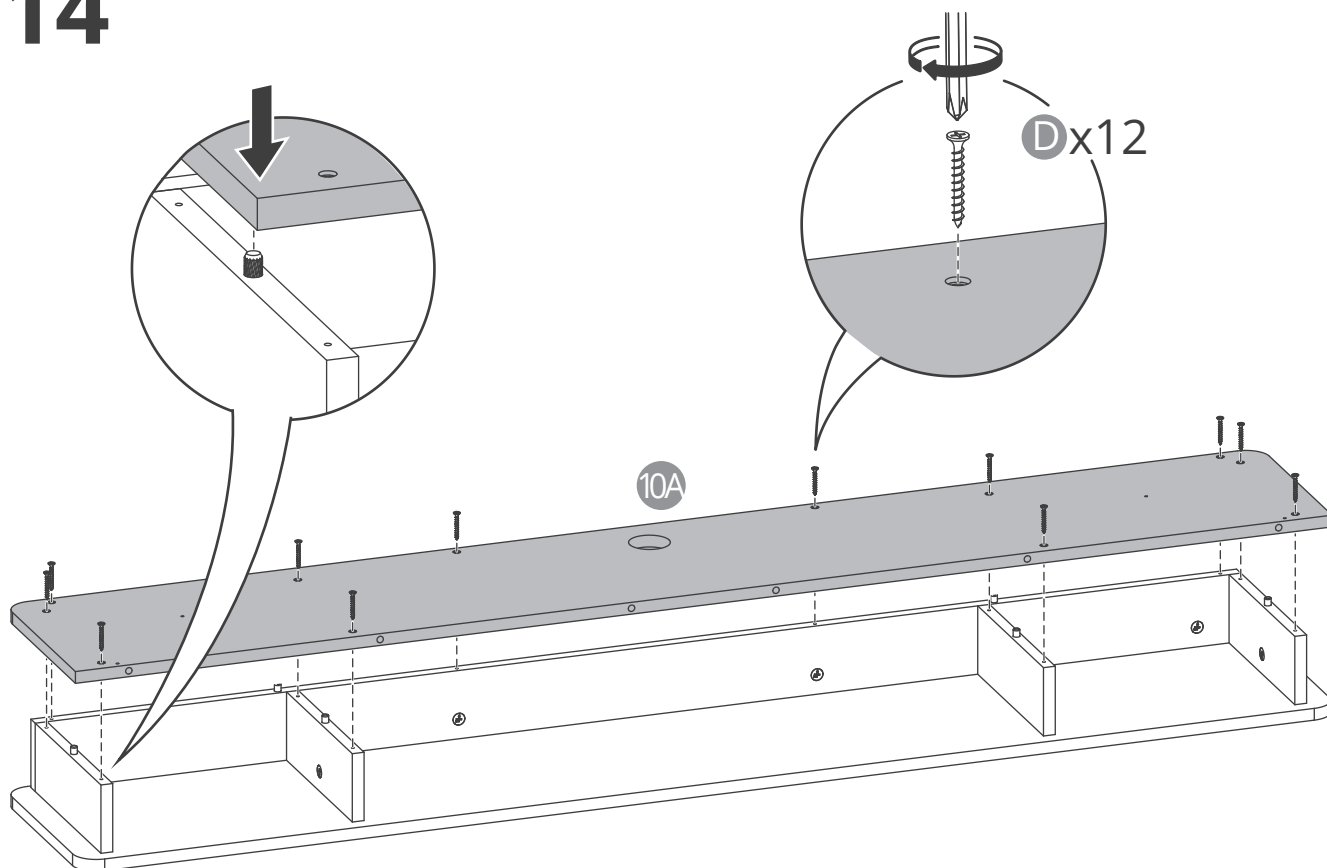

15

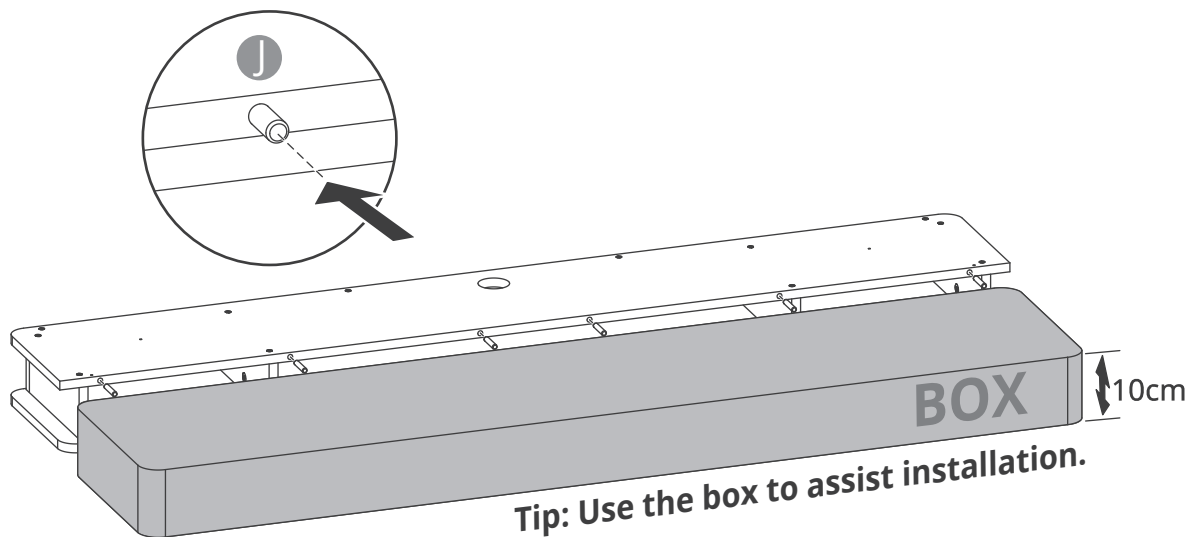

40"/48"
(100cm/120cm)

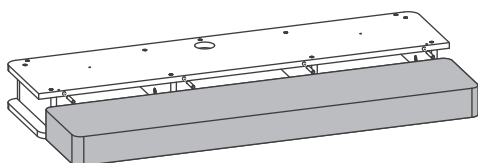

Jx4

55"/63"
(140cm/160cm)

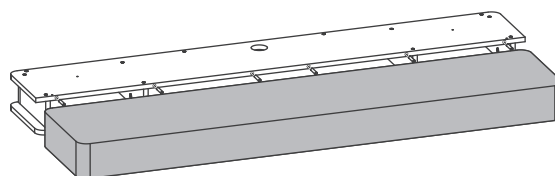

Jx6

16

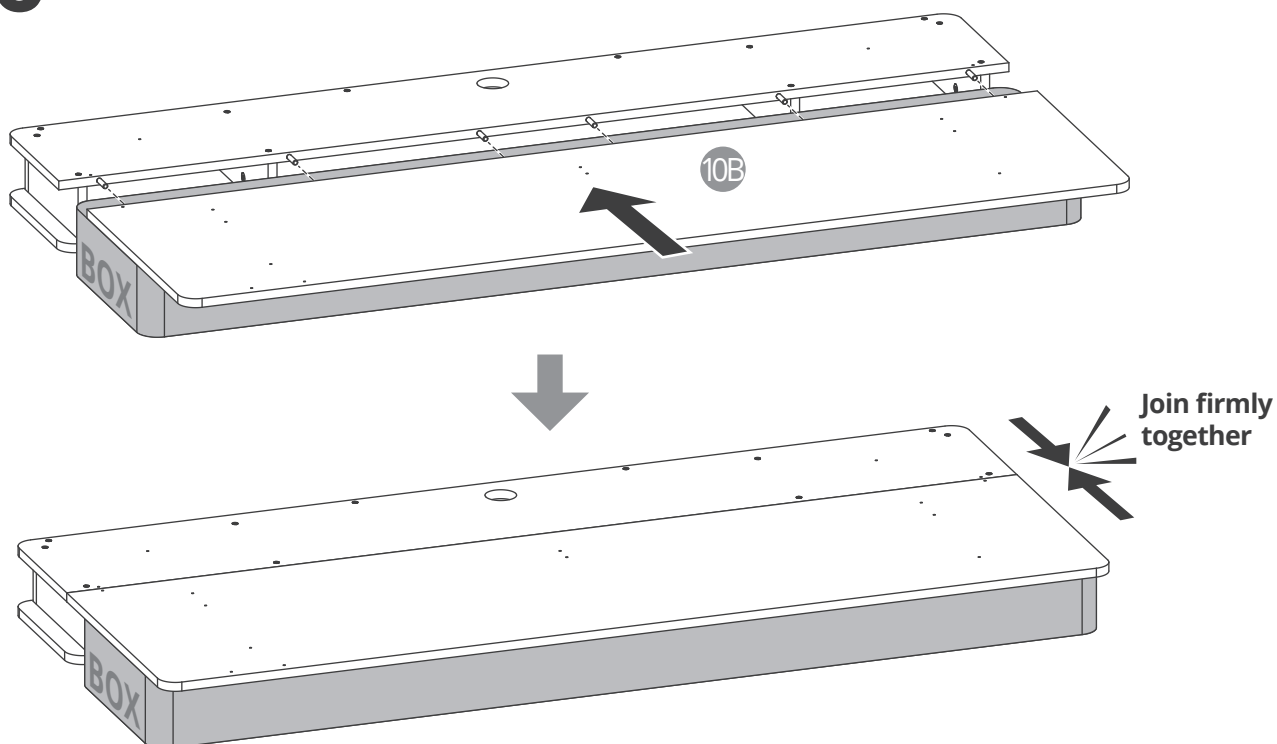

17

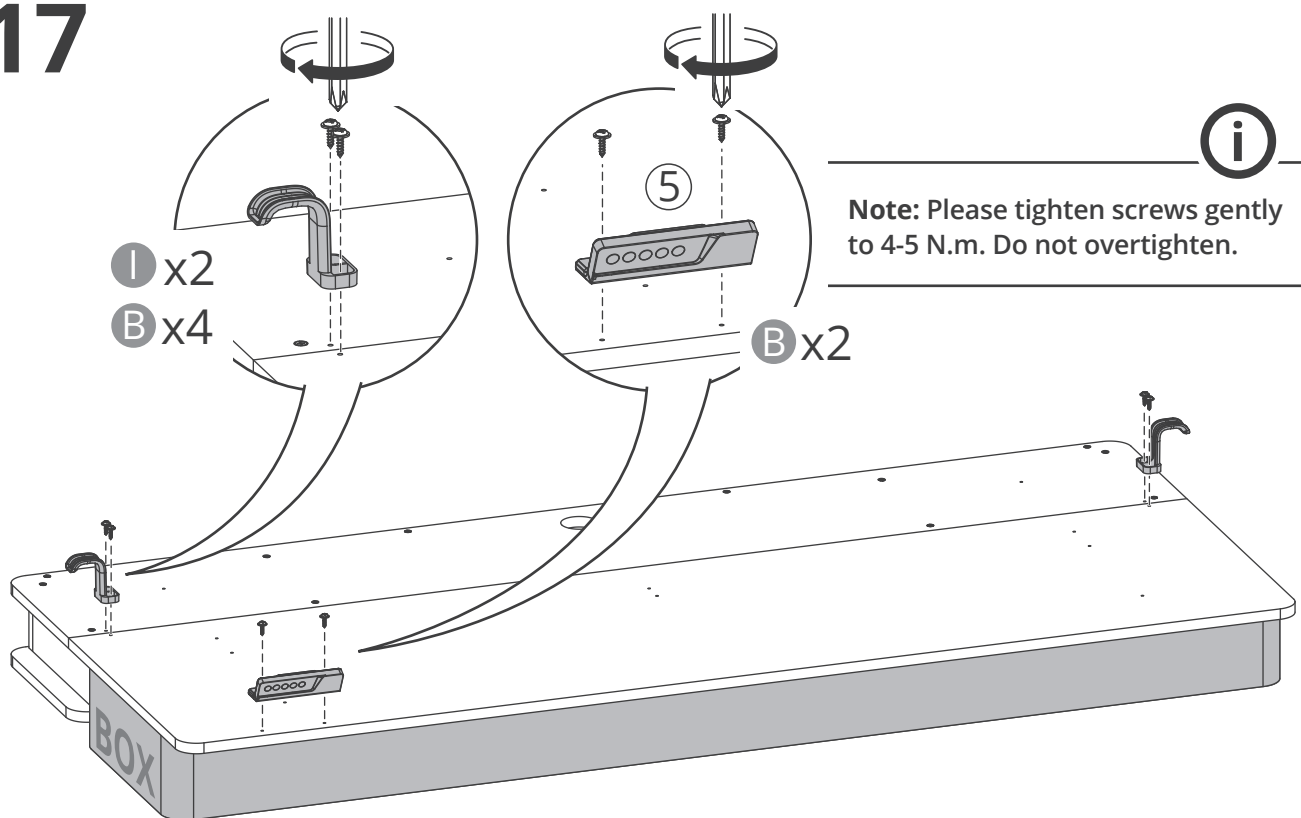

18

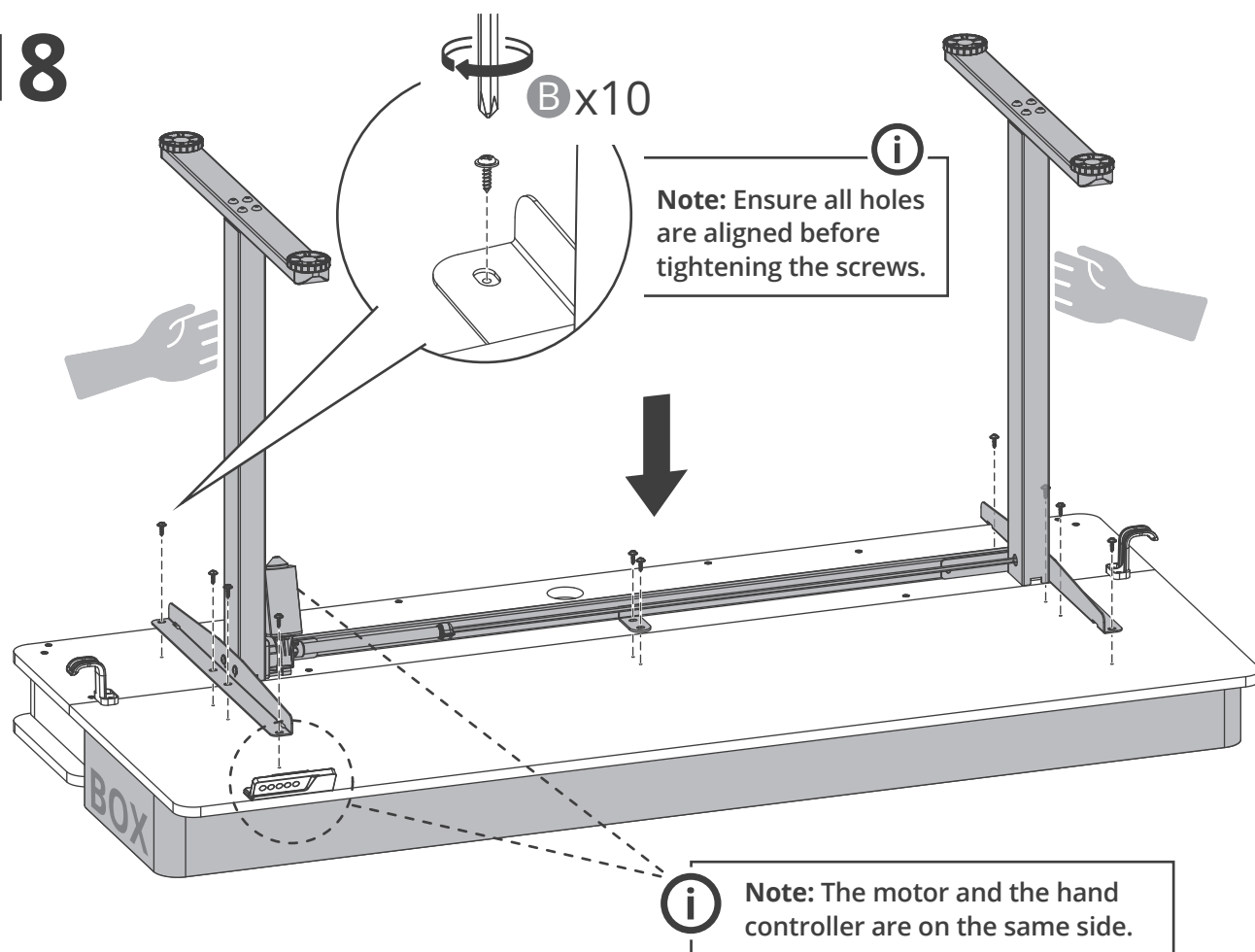

19

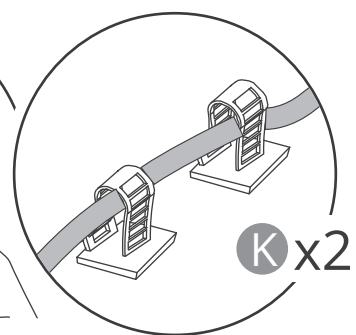
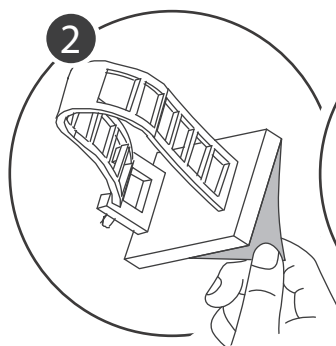
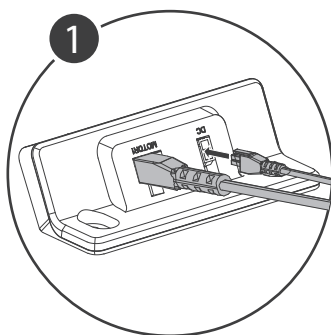
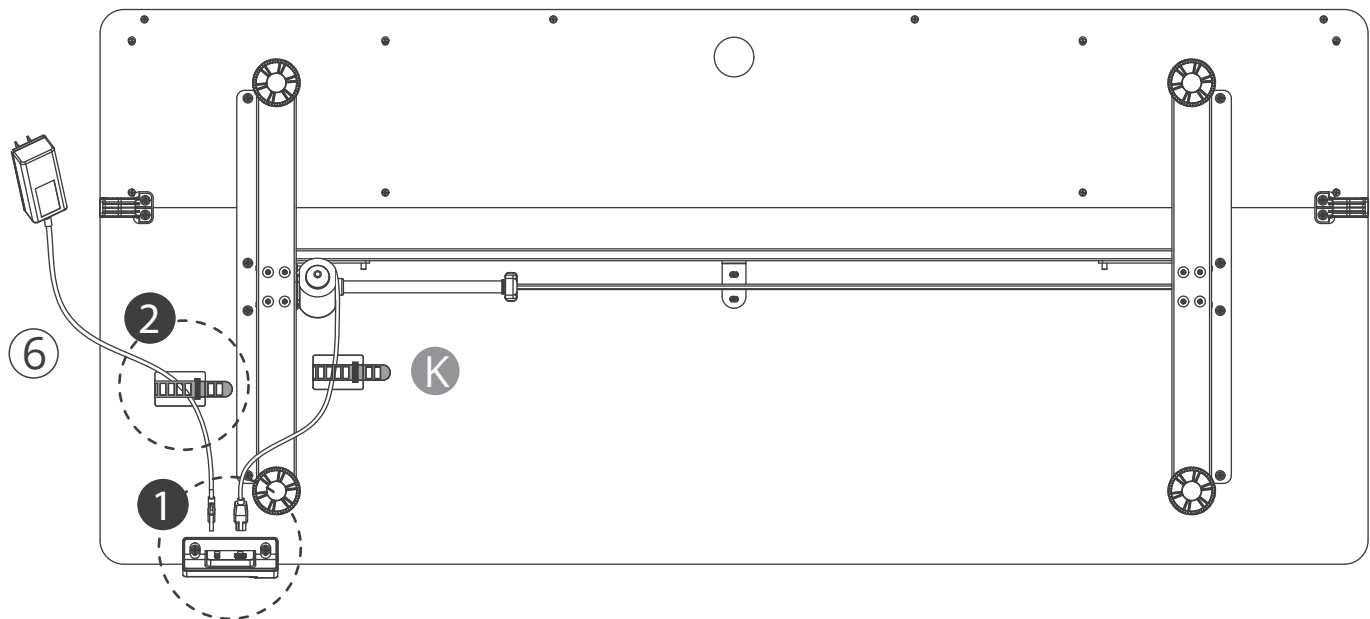

20

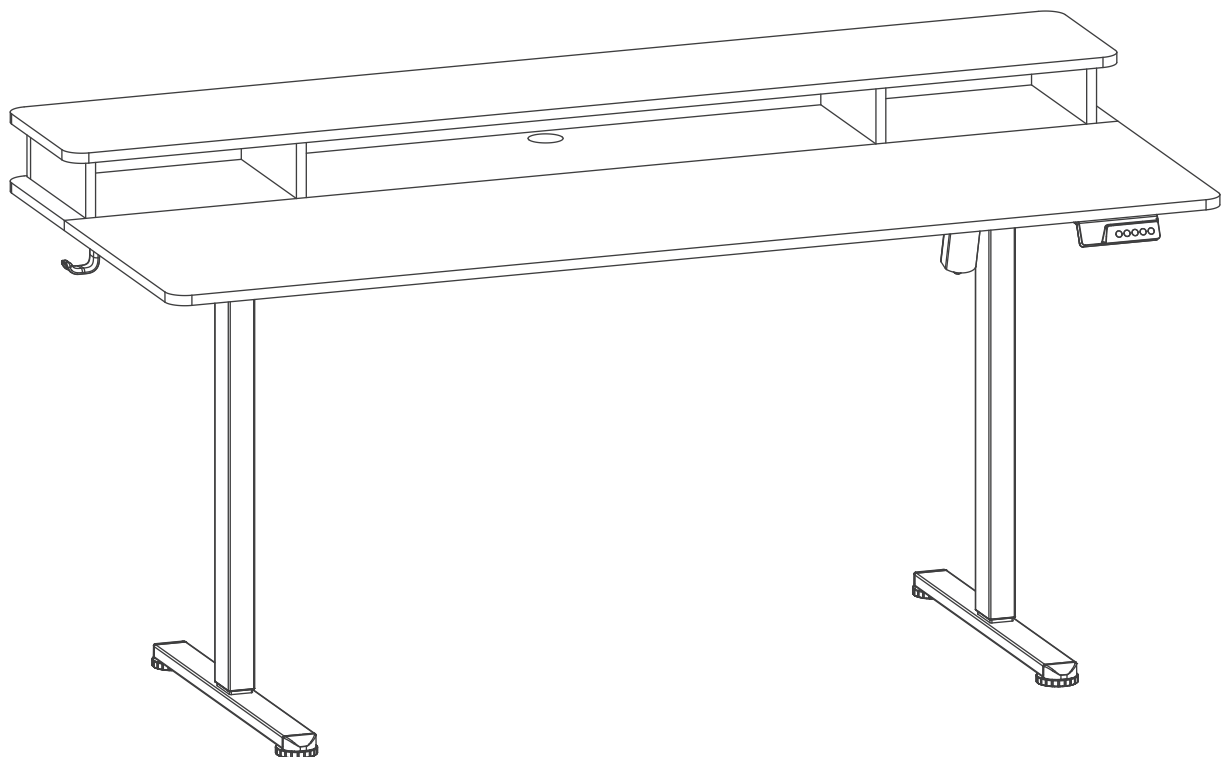
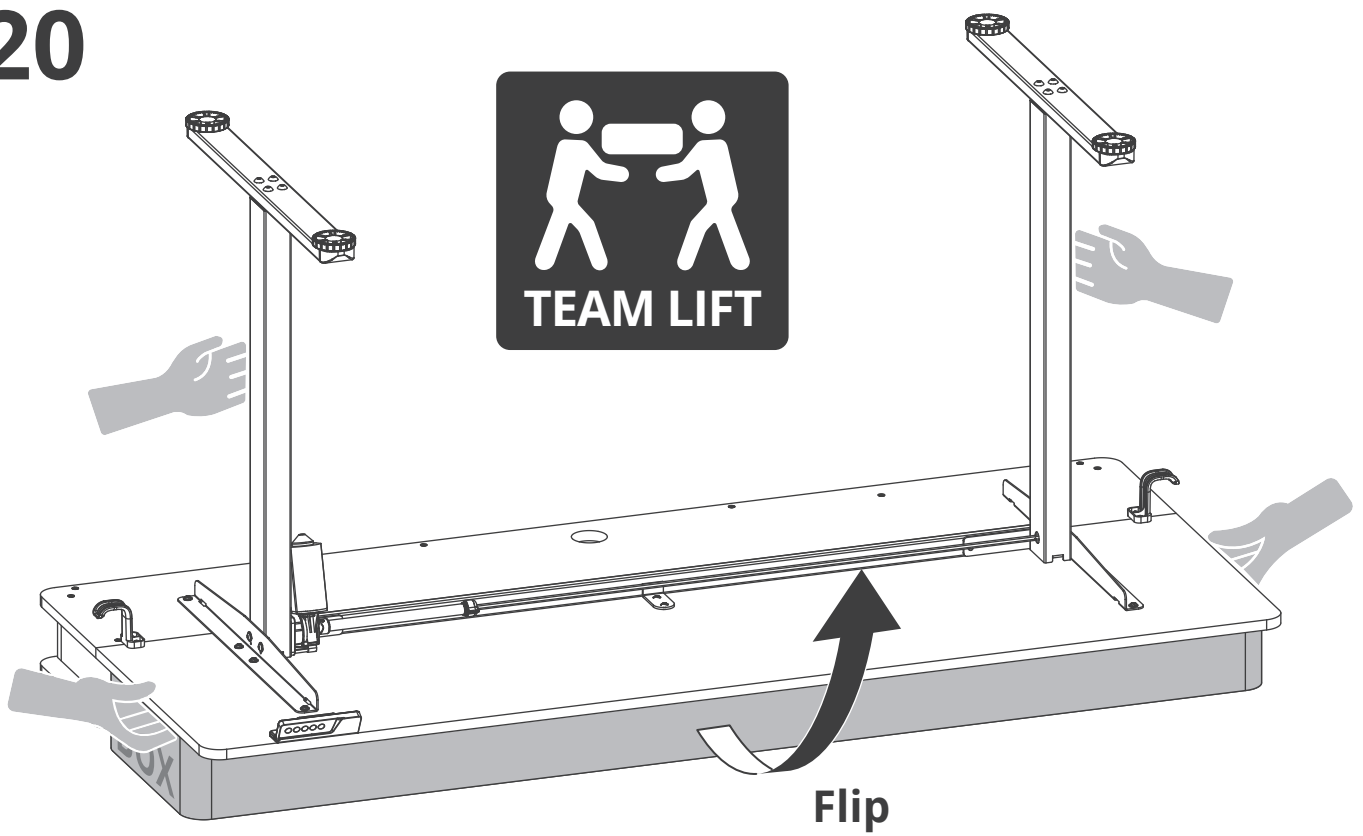

21

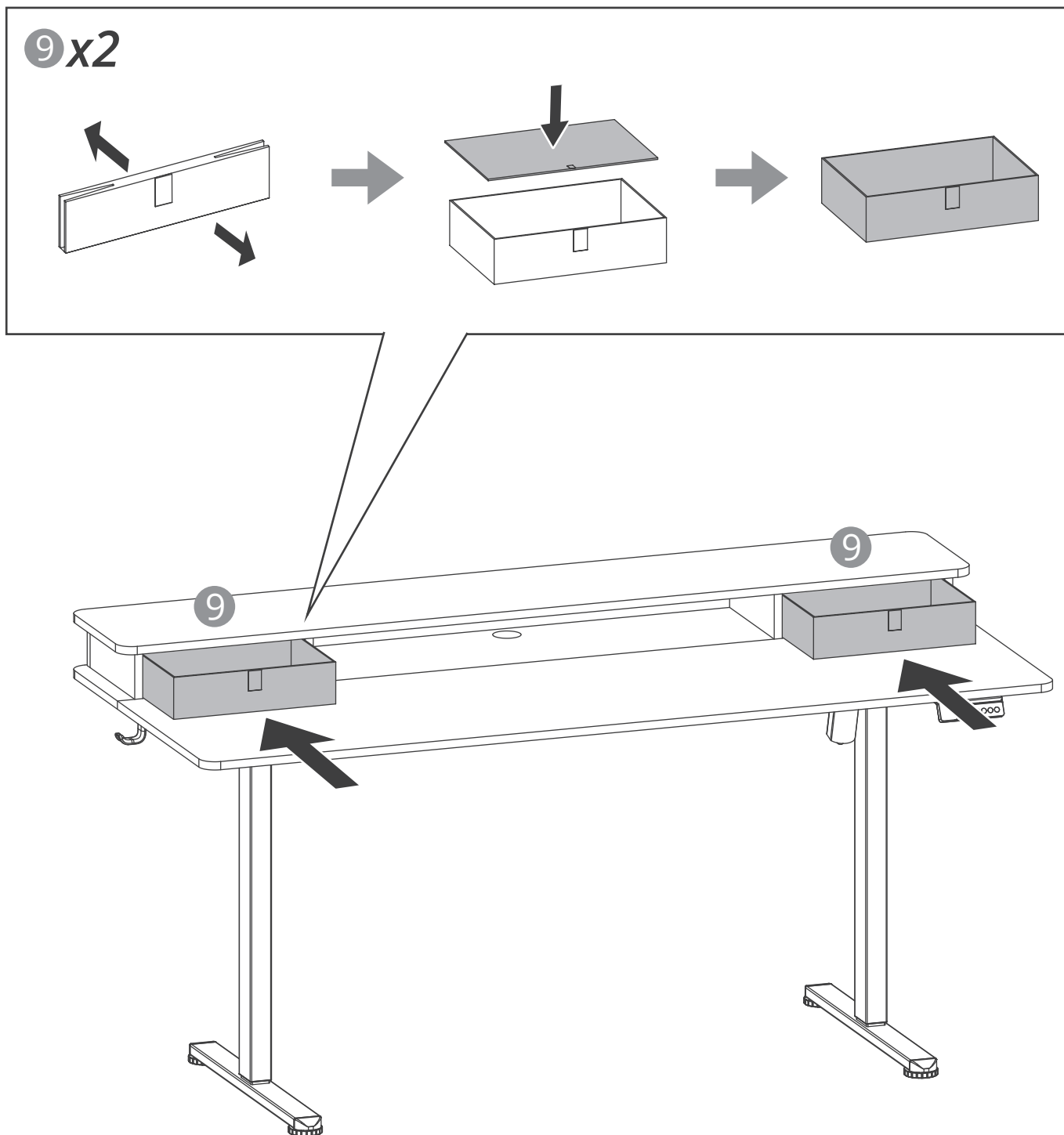

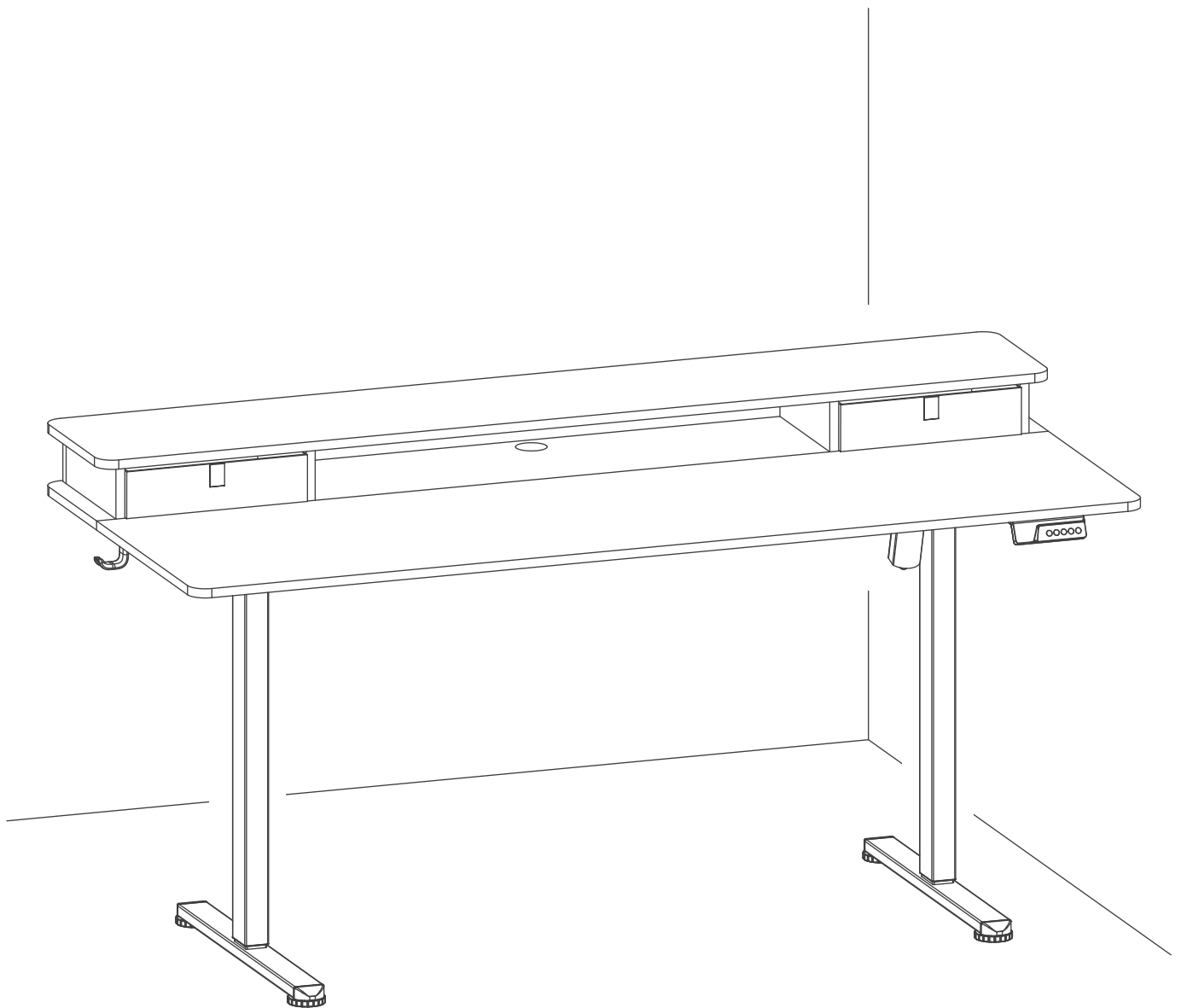

Handset Operation Instructions

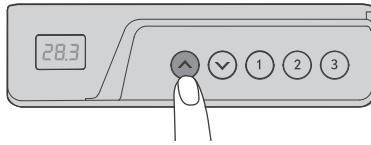

Height Adjustment

Press and hold the or button to adjust the height.

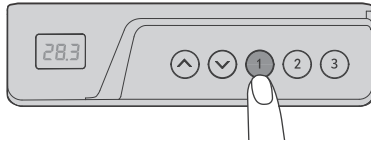

Memory Function

Briefly press the ①, ②, or ③ memory button to automatically adjust the desktop to the preset height.

Memory Key 1: 72 cm (28.3 in), Memory Key 2: 86 cm (33.8 in),
Memory Key 3: 118 cm (46.4 in).

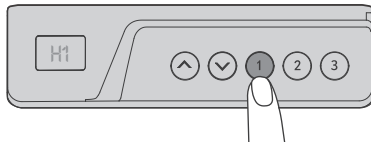

Memory Height Setting

Adjust the desktop to the desired height by pressing and holding the or button. Then, press and hold the ①, ②, or ③ button until **H1**, **H2**, or **H3** appears on the display to save the current height to the corresponding memory position.

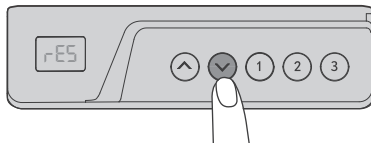

Reset Function

If the system malfunctions or the display shows **rES**, you need to reset the standing desk.

1. Press and hold the button for 5 seconds. The handset will display **rES**, indicating that the desk has entered reset mode.
2. The desk will move to its lowest height (28.3 in / 72 cm) and then slightly rebound. The lowest height value will be displayed, confirming the reset is complete.

Frequently Asked Questions (FAQ)

One-Sided Desk Lifting

Possible Cause:

The sync rod may not be properly installed.

Solution:

1. Check that the sync rod is fully inserted into the desk leg. If it isn't, adjust the desktop to a level position and refer to the leg installation sticker or manual to reinstall the sync rod.
2. If the issue persists after these steps, record a video of the problem and contact customer support at support@yfs.life.

Handset Malfunction or No Response

Possible Causes:

1. The power connection is not secure.
2. The control box may have poor contact or be faulty.
3. A fuse may have blown, or the power module is defective.

Solution:

1. Disconnect all power cables, then reconnect them. Verify that every connection is secure and that the power plug is fully inserted into the outlet.
2. If the problem remains, record a video of the fault and contact customer support at support@yfs.life.

<p>Desk Tilting or Unbalanced</p>	<p>Possible Causes:</p> <ol style="list-style-type: none"> 1. Improper installation causing imbalance. 2. One column or footpad is not level. <p>Solution:</p> <ol style="list-style-type: none"> 1. Review the installation steps to ensure each column is correctly installed and the desk is level. 2. Adjust the footpad height to level the desk. 3. If unresolved, record a video of the issue and contact customer support at support@yfs.life.
<p>Unusual Noise or Irregular Movement During Height Adjustment</p>	<p>Possible Causes:</p> <ol style="list-style-type: none"> 1. The desktop load exceeds the recommended limit (not more than 50 kg / 110 lbs). 2. Loose connections in the desk—especially near the sync rod. 3. The motor may be faulty. <p>Solution:</p> <ol style="list-style-type: none"> 1. Check if the items on the desktop exceed the weight limit and reduce the load if necessary. 2. Inspect and tighten all screws and connectors to secure the desk structure. 3. If the issue persists after these steps, record a video of the problem and contact customer support at support@yfs.life.

Error Codes	Solution
HOT	Motor overheating. Please wait 15-18 minutes before operating the desk.
E10/E32/E31	Power supply abnormal. Unplug the power cord and wait 30 seconds. Then, plug it back in and perform a reset.
E20	Overload. Please reduce the load on the desktop and plug the power cord back in.
E02	Obstruction detected during height adjustment. Please check the surrounding area of the desk and perform a reset.

